

<b>BRASSTECH</b>		2001 E. CARNEGIE AVE.	
INCORPORATED		SANTA ANA, CA 92705	
		(949) 417-5207	
DWG NO.	4681L	REV	C
SCALE	.375	REF.	-
		SHEET	2 OF 3

CAUTION - RISK OF FIRE  
**MAX** 100 WATTS TYPE A19

MONTH YEAR E222M6

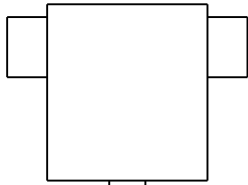
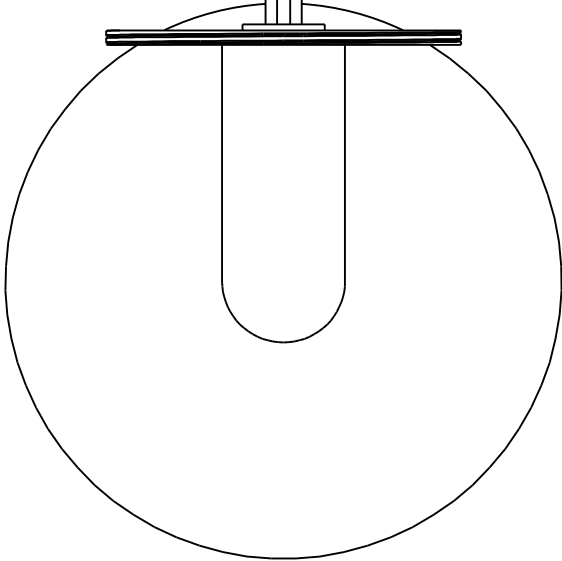

WALL MOUNT ONLY

MIN 75°C SUPPLY  
CONDUCTORS

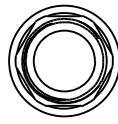

MONTH YEAR E222M6

PXXXX INCANDESCENT  
FOR DAMP LOCATIONS

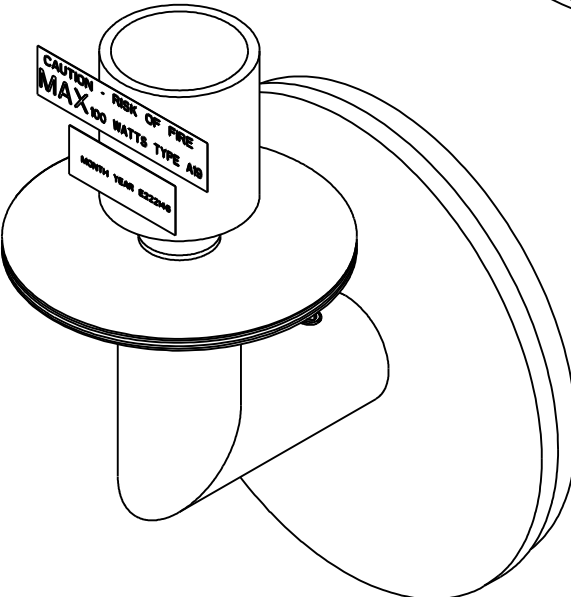
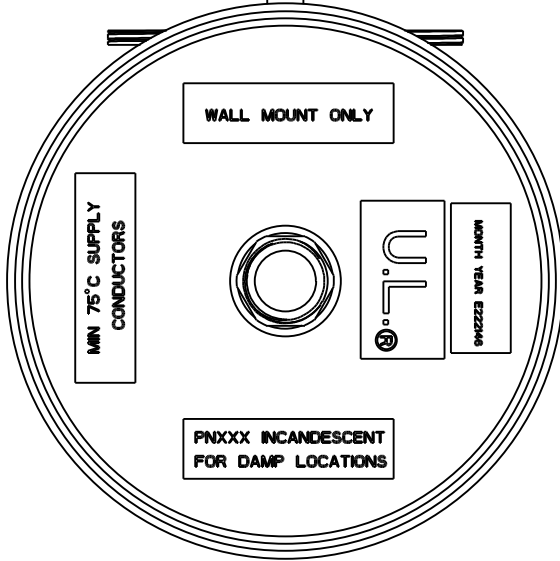

CAUTION - RISK OF FIRE  
**MAX** 100 WATTS TYPE A19  
MONTH YEAR E222M6

<b>BRASSTECH</b> INCORPORATED		2001 E. CARNEGIE AVE. SANTA ANA, CA 92705 (949) 417-5207
DWG NO.	4681L	REV C
SCALE .625	REF. -	SHEET 3 OF 3