

NOTES:

1. TO INSPECT ASSEMBLY, FOLLOW FIRST ARTICLE AND IN PROCESS INSPECTION SHEET.
2. APPLY LOCTITE 680.
3. SLIT AND SHORTEN O-RING BY .13" TO .20" IN LENGTH BEFORE INSTALLING.
4. SLIT O-RING BEFORE INSTALLING.
5. INSTALLATION TORQUE: 8 -14 LB-FT.
6. WATER TEST WHOLE UNIT.
7. BAG 5-007 IN A SEPARATE BAG.
8. APPLY THIN FILM OF DOW CORNING 111.
9. APPLY LOCTITE 242.
10. INSTALLATION TORQUE: 10-14 LB-IN.

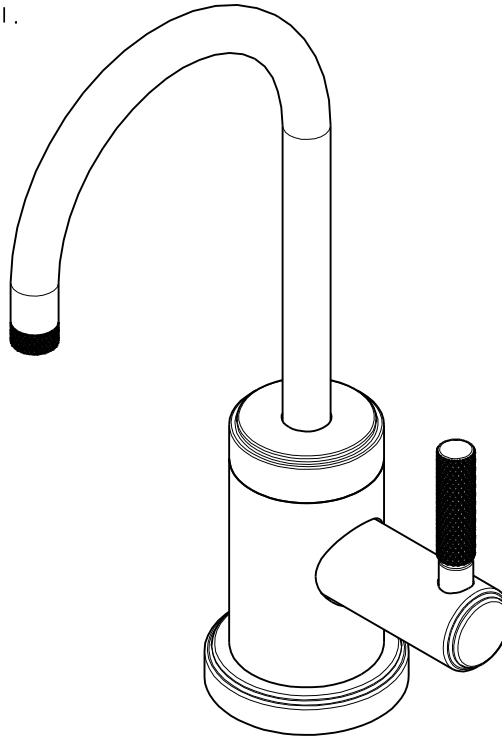

BILL OF MATERIAL (CURRENT LEVEL)

ITEM	PT/ASSY	DESCRIPTION	TYPE	QTY.
1	12693	ESCUTCHEON	PART	1
2	91768	O-RING, #2-130, EP, 50 DURO - GREY	PART	1
3	13605	WATER DISP. BODY COLD (CONT)	PART	1
4	13686	BODY CAP	PART	1
5	91023	O-RING, #2- 019, EPDM, 65-75 DURO, NSF 61	PART	1
6	20-520	SPOUT ASM	ASSEMBLY	1
7	91382	O-RING, #2- 012, TEFLON,	PART	1
8	91017	O-RING #2-012	PART	2
9	91383	O-RING, #2- 014, TEFLON, NSF 61	PART	1
10	1-134	CARTR 3/8 HOT 1/4 TR	PART	1
11	92926	ADAPTER	PART	1
12	92477	SCRW, M4 X 16 SKT FLT HD SS	PART	1
13	13685	HANDLE HUB	PART	1
14	50760	NIPPLE WATER DISP	PART	1
15	5-007	1/4 COMP KIT	ASSEMBLY	1
16	10661	MOUNTING STUD	PART	1
17	91063	MOUNTING CRESCENT GASKET	PART	1
18	10514	MOUNTING CRESCENT	PART	1
19	10516	MOUNTING NUT	PART	1
20	13790	WATER DISP LEVER	PART	1
21	92017	SCRW, 1/4-20 X 3/16 SKT HD CUP PT SS	PART	1

TESTING	-	-	-
ASSEMBLY	-	-	-
PLATING	-	-	-
POLISHING	-	NEXT ASSY	USED ON
MACHINING	-	APPLICATION	
TOOLING FIXTURE #	REMOVE ALL BURRS AND SHARP EDGES		

**BRASSTECH** 2001 CARNEGIE AVE.  
 INCORPORATED SANTA ANA, CA 92705  
 (949) 417-5207

**WATER DISPENSER - COLD**

DWG NO. **3290-5623** REV **D**

SCALE .500 REF. - SHEET 1 OF 3

ZONE	REV	DESCRIPTION	DATE	APPROVED
-	D	EN-4187	10/25/22	J.M.
-	A	EN-4300jj	04/12/21	R.S.
-	-	EN-3881a	11/04/19	J.M.

COPYRIGHT 2005 BRASSTECH, INC. THESE DRAWINGS AND THE DESIGNS DEPICTED HEREIN ARE THE PROPRIETARY PROPERTY OF BRASSTECH. ANY USE OR REPRODUCTION IS SUBJECT TO THE EXPRESS APPROVAL OF BRASSTECH. UNAUTHORIZED USE IS STRICTLY PROHIBITED. ALL RIGHTS RESERVED.

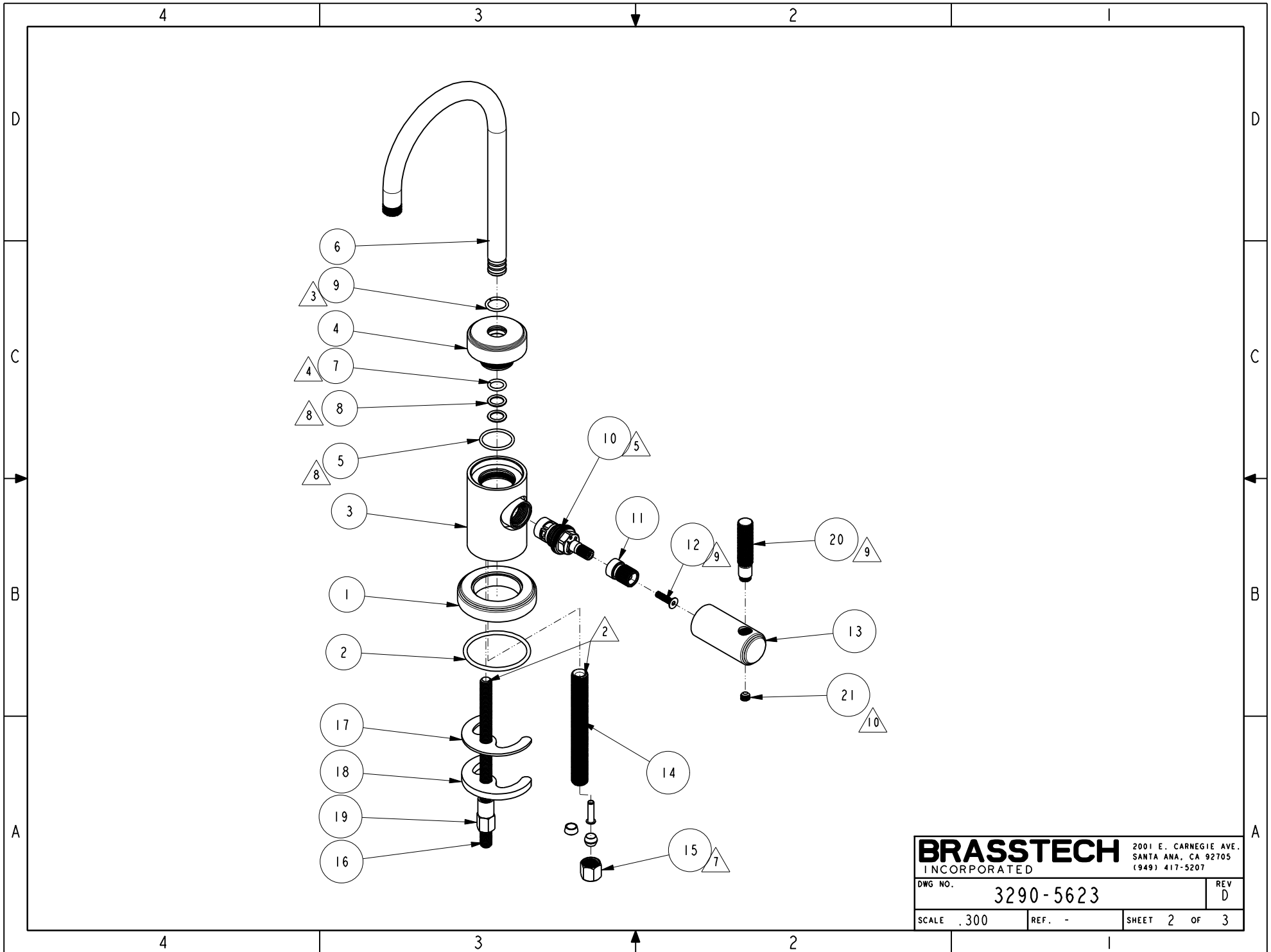

<b>BRASSTECH</b>		2001 E. CARNEGIE AVE. SANTA ANA, CA 92705 (949) 417-5207
DWG NO.	3290-5623	REV D
SCALE .300	REF. -	SHEET 2 OF 3

