

# MIX COLLECTION

'Made by us. Mixed by you.' Say hello to MIX, an innovative collection of interchangeable cabinet hardware that gives you more control over your design.



## MIX DIAMOND CABINET KNOB



Code	Diameter (Dia.)	Projection (P)	Base (B)
MIX1/KNOBONLY/32	32mm	29mm	10mm

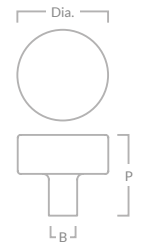

## MIX DIAMOND CABINET KNOB WITH BACKPLATE



Code	Depth (D)	Centres (C)	Width (W)	Diameter (Dia.)	Projection (P)
MIX1/54	25mm	54mm	80mm	32mm	34mm
MIX1/128	25mm	128mm	154mm	32mm	34mm
MIX1/192	25mm	192mm	218mm	32mm	34mm

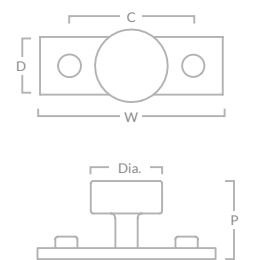

## MIX DIAMOND CABINET & APPLIANCE HANDLE



Code	Centres (C)	Bar Diameter	Length (L)	Projection (P)
MIX1/PULLONLY/160	160mm	13mm	202mm	34mm
MIX1/PULLONLY/224	224mm	14mm	274mm	37mm
MIX1/PULLONLY/288	288mm	14mm	338mm	37mm
MIX1/PULLONLY/APP/384	384mm	18mm	434mm	50mm
MIX1/PULLONLY/APP/608	608mm	18mm	658mm	50mm



## MIX DIAMOND CABINET & APPLIANCE HANDLE WITH BACKPLATE



Code	Centres (C)	Bar Dia.	Length (L)	Projection (P)	Base (B)	Depth (D)
MIX1/160	160mm	13mm	230mm	39mm	5mm	25mm
MIX1/224	224mm	14mm	310mm	42mm	5mm	32mm
MIX1/288	288mm	14mm	374mm	42mm	5mm	32mm
MIX1/APP/384	384mm	18mm	470mm	56mm	6mm	35mm
MIX1/APP/608	608mm	18mm	694mm	56mm	6mm	35mm

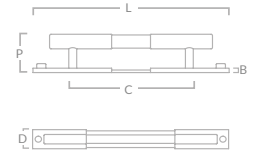

## MIX STRAIGHT CABINET KNOB



Code	Diameter (Dia.)	Projection (P)	Base (B)
MIX2/KNOBONLY/32	32mm	29mm	10mm

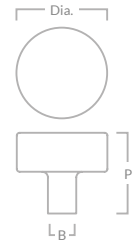

## MIX STRAIGHT CABINET KNOB WITH BACKPLATE



Code	Depth (D)	Centres (C)	Width (W)	Diameter (Dia.)	Projection (P)
MIX2/54	25mm	54mm	80mm	32mm	34mm
MIX2/128	25mm	128mm	154mm	32mm	34mm
MIX2/192	25mm	192mm	218mm	32mm	34mm

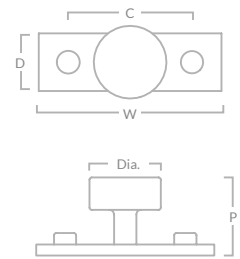

## MIX STRAIGHT CABINET & APPLIANCE HANDLE



Code	Centres (C)	Bar Diameter	Length (L)	Projection (P)
MIX2/PULLONLY/160	160mm	13mm	202mm	34mm
MIX2/PULLONLY/224	224mm	14mm	274mm	37mm
MIX2/PULLONLY/288	288mm	14mm	338mm	37mm
MIX2/PULLONLY/APP/384	384mm	18mm	434mm	50mm
MIX2/PULLONLY/APP/608	608mm	18mm	658mm	50mm



## MIX STRAIGHT CABINET & APPLIANCE HANDLE WITH BACKPLATE



Code	Centres (C)	Bar Dia.	Length (L)	Projection (P)	Base (B)	Depth (D)
MIX2/160	160mm	13mm	230mm	39mm	5mm	25mm
MIX2/224	224mm	14mm	310mm	42mm	5mm	32mm
MIX2/288	288mm	14mm	374mm	42mm	5mm	32mm
MIX2/APP/384	384mm	18mm	470mm	56mm	6mm	35mm
MIX2/APP/608	608mm	18mm	694mm	56mm	6mm	35mm

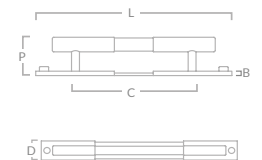

## MIX PLAIN CABINET KNOB



Code	Diameter (Dia.)	Projection (P)	Base (B)
MIX3/KNOBONLY/32	32mm	29mm	10mm

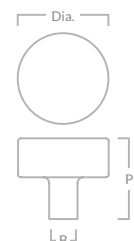

### MIX PLAIN CABINET KNOB WITH BACKPLATE



Code	Depth (D)	Centres (C)	Width (W)	Diameter (Dia.)	Projection (P)
MIX3/54	25mm	54mm	80mm	32mm	34mm
MIX3/128	25mm	128mm	154mm	32mm	34mm
MIX3/192	25mm	192mm	218mm	32mm	34mm

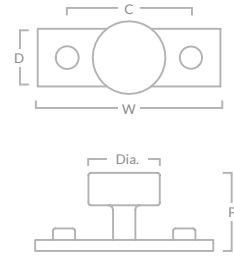

### MIX PLAIN CABINET & APPLIANCE HANDLE



Code	Centres (C)	Bar Diameter	Length (L)	Projection (P)
MIX3/PULLONLY/160	160mm	13mm	202mm	34mm
MIX3/PULLONLY/224	224mm	14mm	274mm	37mm
MIX3/PULLONLY/288	288mm	14mm	338mm	37mm
MIX3/PULLONLY/APP/384	384mm	18mm	434mm	50mm
MIX2/PULLONLY/APP/608	608mm	18mm	658mm	50mm

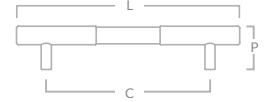

### MIX PLAIN CABINET & APPLIANCE HANDLE WITH BACKPLATE



Code	Centres (C)	Bar Dia.	Length (L)	Projection (P)	Base (B)	Depth (D)
MIX3/160	160mm	13mm	230mm	39mm	5mm	25mm
MIX3/224	224mm	14mm	310mm	42mm	5mm	32mm
MIX3/288	288mm	14mm	374mm	42mm	5mm	32mm
MIX3/APP/384	384mm	18mm	470mm	56mm	6mm	35mm
MIX3/APP/608	608mm	18mm	694mm	56mm	6mm	35mm



MIX Straight Cabinet Knob with backplate in our burnished brass on matt black lacquered finish & Cotswold Cupboard Latch in our burnished brass finish