



California Faucets®

**Salinas™**

**WALL LAVATORY**

## Features

- Over 28 finishes including 13 PVD finishes
- All brass construction
- 1.2 gpm (4.5 L/min) max flow rate
- Rough valve (CF-VL-R) sold separately

## Codes/Standards

Product meets or exceeds the following:

- ASME A112.18.1/CSA B125.1
- NSF/ANSI 61 & NSF/ANSI 372
- CEC & DOE
- Commonwealth of MA
- EPA WaterSense High Efficiency Lavatory

**CF-TO-V6102-7/9**



CF-TO-V6102-9 shown

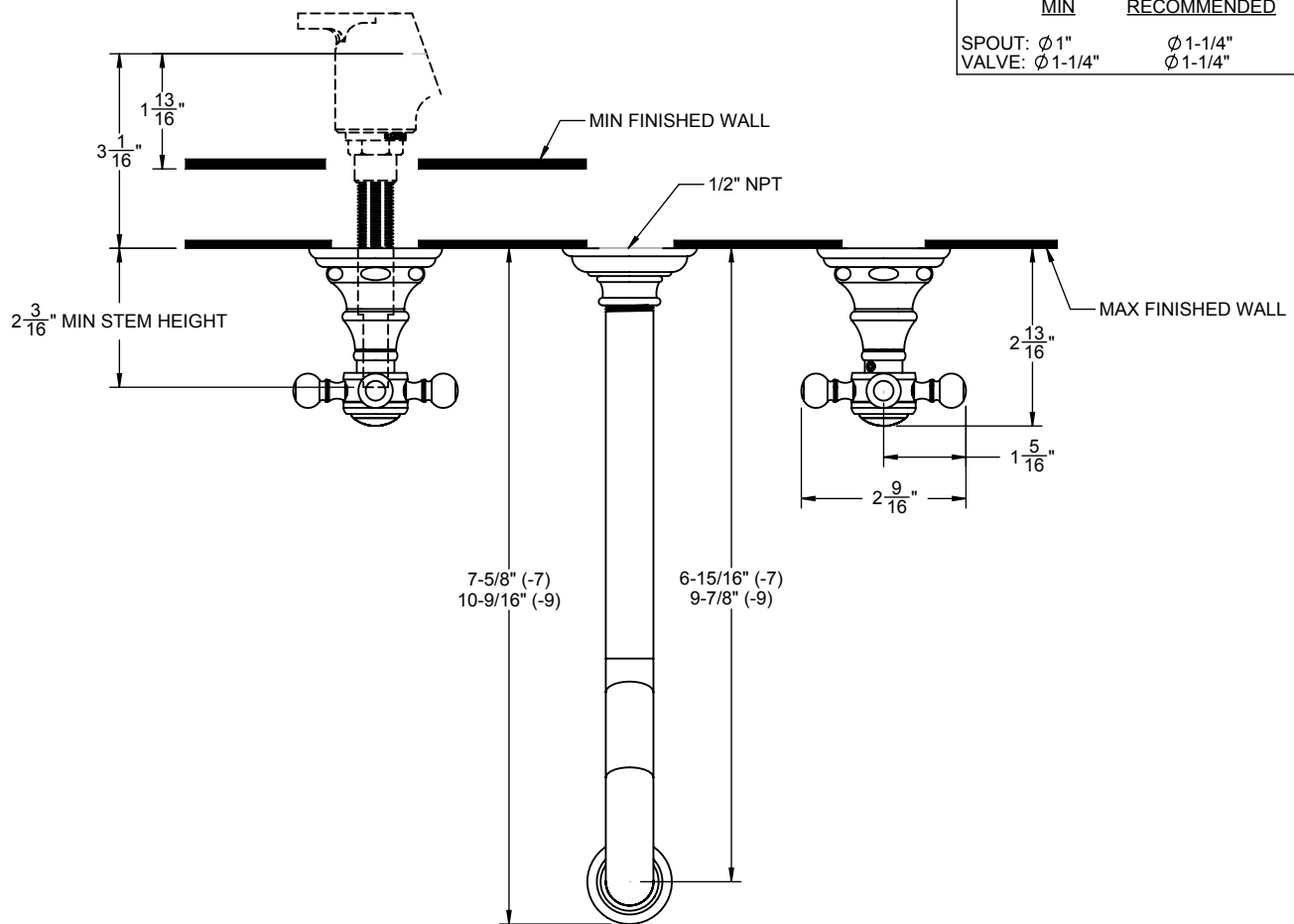

### THROUGH-HOLE SPECIFICATIONS

MIN	RECOMMENDED	MAX
SPOUT: $\varnothing$ 1"	$\varnothing$ 1-1/4"	$\varnothing$ 1-3/8"
VALVE: $\varnothing$ 1-1/4"	$\varnothing$ 1-1/4"	$\varnothing$ 1-9/16"

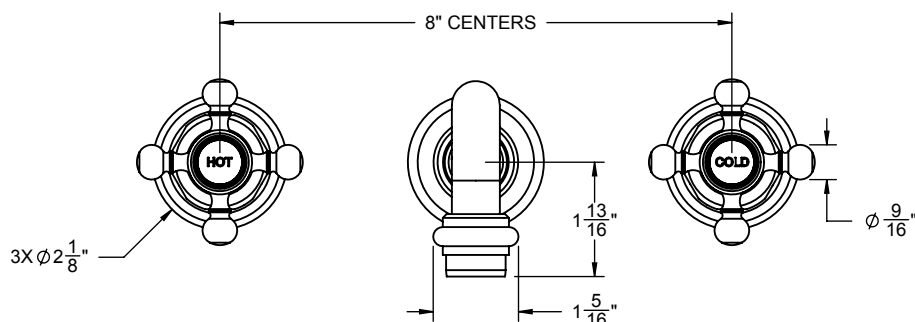

SPECIFICATIONS SUBJECT TO CHANGE WITHOUT NOTICE

ALL DIMENSIONS SHOWN TO NEAREST 1/16"