

NOSTALGIC WAREHOUSE™



Technical Guide

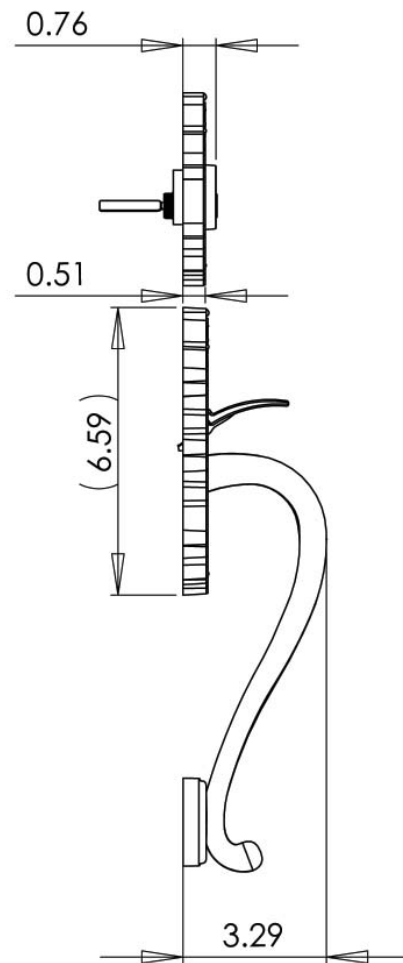
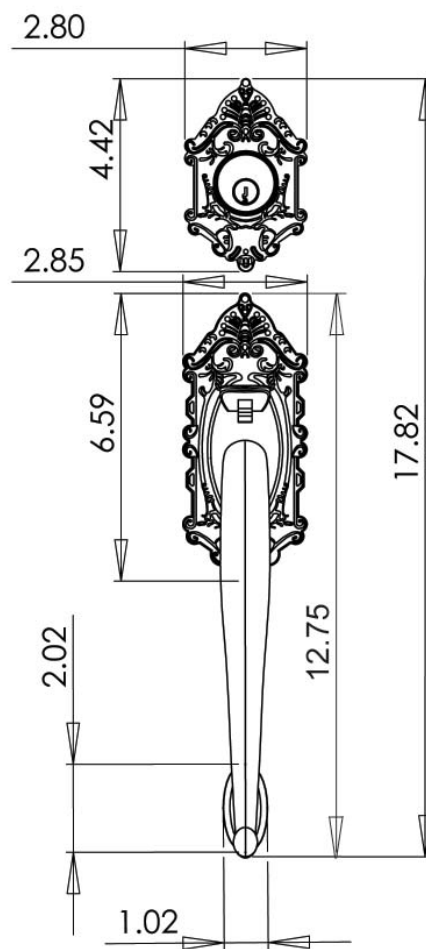

Table of Contents

| <u>CONTENTS</u> | <u>PAGE/SECTION</u> |
|---|----------------------------|
| Reference Items..... | 2-3 |
| Door Lock Functions..... | 4-5 |
| Dimensions - Door Trim..... | A1-A13 |
| Dimensions - Pushplates and Accessories | B1-B7 |
| Dimensions - Parts..... | C1-C3 |

Reference Items

FINISHES

For customer convenience, the most appropriate Builders Hardware Manufacturers Association (BHMA) and old US finish symbols are used to indicate similarity of appearance, regardless of base metal or finishing process.

| <u>Nostalgic Finish</u> | <u>Symbol</u> | <u>Description</u> |
|--------------------------------|----------------------|---------------------------|
| PB | 605 (30) | POLISHED BRASS |
| AB | 609 (5) | ANTIQUE BRASS |
| OB | 613 (10B) | OIL-RUBBED BRONZE |
| SN | 619 (15) | SATIN NICKEL |
| AP | 620 (15A) | ANTIQUE PEWTER |
| BC | 625 (26) | BRIGHT CHROME |
| LB | 505 (03) | LIFETIME BRASS (PVD) |

PACKAGING DIMENSIONS

Following are the dimensions for the Standard Box Packages.

| <u>Package</u> | <u>Length</u> | <u>Width</u> | <u>Height</u> |
|--------------------------------|---------------------------------------|---------------------|----------------------|
| Rosette with Knob (Interior) | 5.5" | 4.8" | 2.9" |
| Longplate with Knob (Interior) | 9.5" | 5.5" | 2.9" |
| Deadbolt | 5.5" | 4.8" | 2.9" |
| Combo Pack | 10" | 9" | 6" |
| Handleset Outside Half | 13.8" | 3.3" | 5.5" |
| Handleset Inside Half | (Same as Interior boxes listed above) | | |

DOOR HANDING

Inside of Door - The **Inside** of a door refers to the side of the door that “faces the room.” For example, for a bedroom door on a hallway, the **Inside** of the door would face the bedroom.

Outside of Door - The **Outside** of a door refers to the side of the door that faces away from the room. It is generally more visible to visitors, and therefore on roses this side has no visible screws. On a bedroom door, the **Outside** would face the hallway.

TO IDENTIFY DOOR HANDING: Face Door From the Outside

Left Hand Door

*Hinges on Left
Opens Inward*

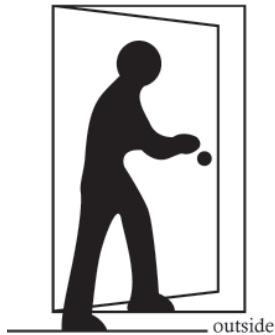

Left Hand Reverse Door

*Hinges on Left
Opens Outward*

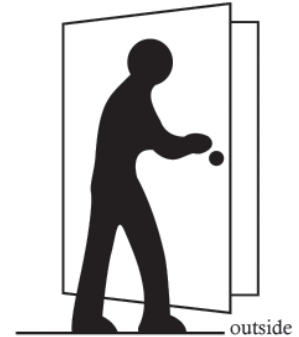

Right Hand Door

*Hinges on Right
Opens Inward*

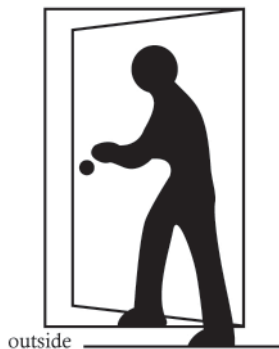

Right Hand Reverse Door

*Hinges on Right
Opens Outward*

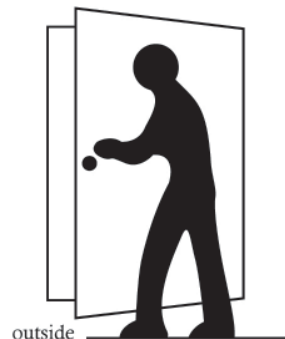

Handing of doors is important when selecting split finish or split design combinations with the PRIVACY FUNCTION.

Handing is not required for standard Passage, Privacy, Mortise or Dummy functions.

STANDARD PRODUCT INFORMATION

Door Range (Passage & Privacy): 1-3/8" to 1-7/8"

Door Range (Handlesets, Deadbolts & Combo Packs): 1-5/8" to 2-1/4"

Backset: 2-3/8" standard, 2-3/4" available

Latch: Tubular standard, Drive-In available, Mortise

Cylinder: 5-pin, C-keyway

Keying: Keyed Different (KD) standard & Keyed Alike (KA) available

DOOR LOCK FUNCTIONS

BN 10 & 11

Passage Set

Active latch with no locking mechanism. Knob is always unlocked. 11 Function has a decorative keyhole; 10 Function does not. Standard door range: 1-3/8" to 1-3/4" thick

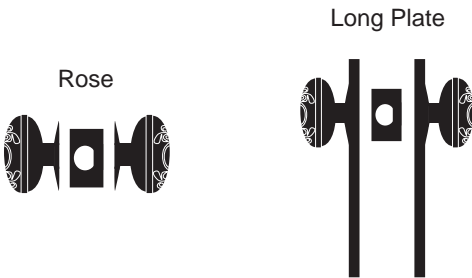

BN 40 & 41

Privacy Lock

Active latch with locking mechanism. Privacy pin provides locking through rose or long plate. Can be opened from outside with small tool. 41 Function has a decorative keyhole; 40 Function does not. Standard door range: 1-3/8" to 1-3/4" thick

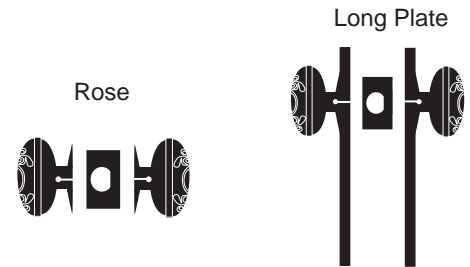

BN 20 & 21

Dummy

Non-functioning doorset (with no latch) used on one side of door (typically used with roller catch, flush bolts or surface bolts). Surface mounted. 21 Function has a decorative keyhole; 20 Function does not.

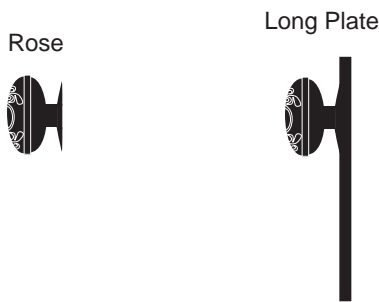

BN 22 & 23

Double Dummy

Two non-functioning doorsets (with no latch) are used on both sides of a door, or on side-by-side or french doors (typically used with roller catch, flush bolts or surface bolts). Surface mounted or thru-mounted. 23 Function has a decorative keyhole; 22 Function does not.

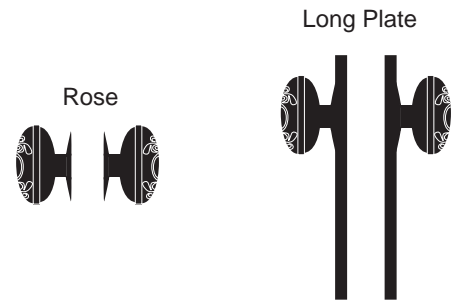

BN 45

Interior Mortise Lock

Active latch with skeleton key locking mechanism. Requires special mortise door preparation for mortise case.

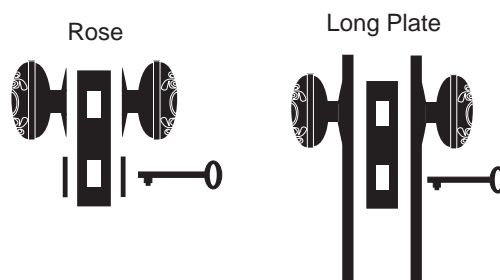

DOOR LOCK FUNCTIONS

BN 73

Handleset Exterior Single Cylinder

Active thumbblatch and grip with single cylinder deadbolt. Requires a 72 Function to make a complete handleset. Standard door range: 1-3/4" to 2-1/4" thick.



BN 72

Handleset Interior Single Cylinder

Active latch (passage) with a single cylinder deadbolt. Requires a 73 Function to make a complete handleset. Standard door range: 1-3/4" to 2-1/4" thick.



BN 60

Single Cylinder Deadbolt

Manually operated bolt for entry door with keyed cylinder on the exterior and thumbturn on the interior. Standard door range: 1-3/4" to 2-1/4" thick.



BN 62

Double Cylinder Deadbolt

Manually operated bolt with keyed cylinder on both the exterior and interior. Standard door range: 1-3/4" to 2-1/4" thick.



DIMENSIONS - DOOR TRIM

Long Plates & Rosettes (All Dimensions are Approximate)

Classic Rosette (CLA)

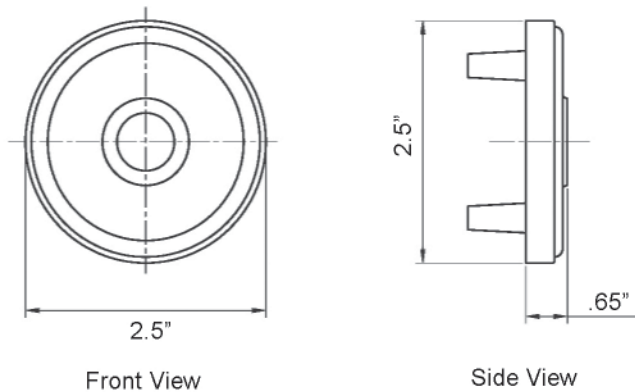

Available in:

Antique Pewter - AP

Bright Chrome - BC

Polished Brass - PB

Satin Nickel - SN

Oil-Rubbed Bronze - OB

Antique Brass - AB

Material: Solid Forged Brass

Deco Long Plate (DEC)

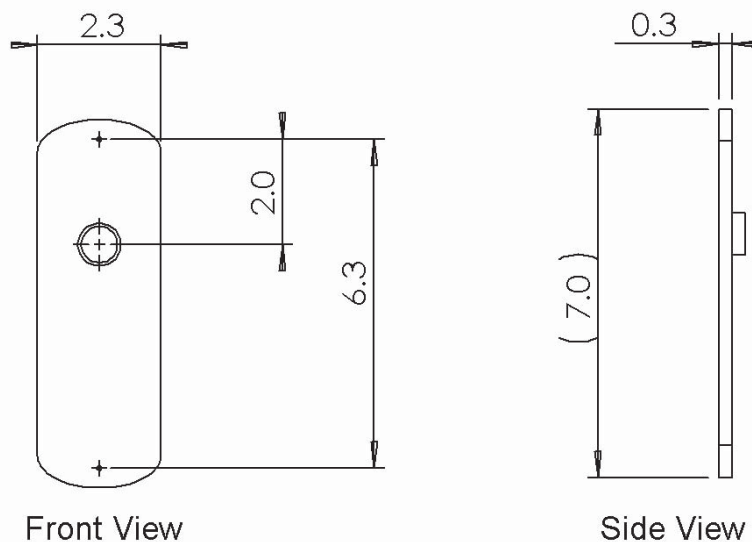

Available in:

Antique Pewter - AP

Polished Brass - PB

Satin Nickel - SN

Oil-Rubbed Bronze - OB

Antique Brass - AB

Material: Solid Forged Brass

DIMENSIONS - DOOR TRIM

Long Plates & Rosettes (All Dimensions are Approximate)

Egg & Dart Long Plate (EAD)

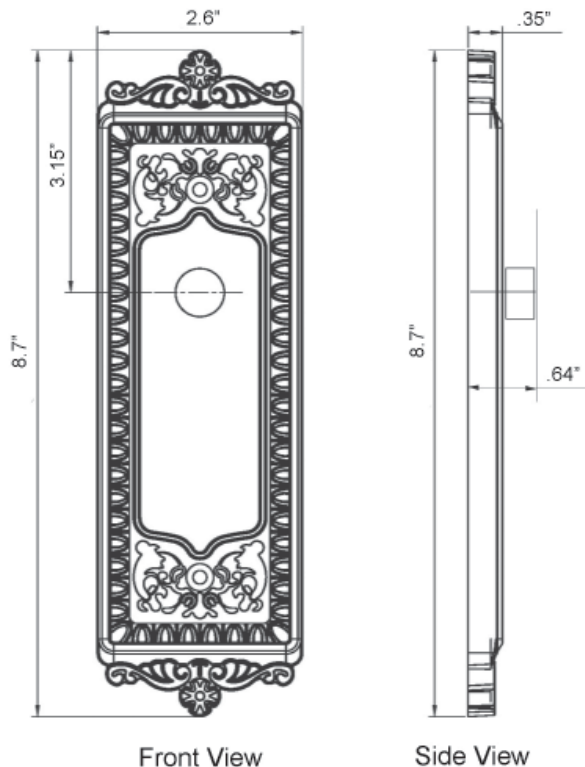

Available in:

Antique Pewter - AP

Polished Brass - PB

Satin Nickel - SN

Oil-Rubbed Bronze Bronze - OB

Antique Brass - AB

Material: Solid Forged Brass

Meadows Long Plate (MEA)

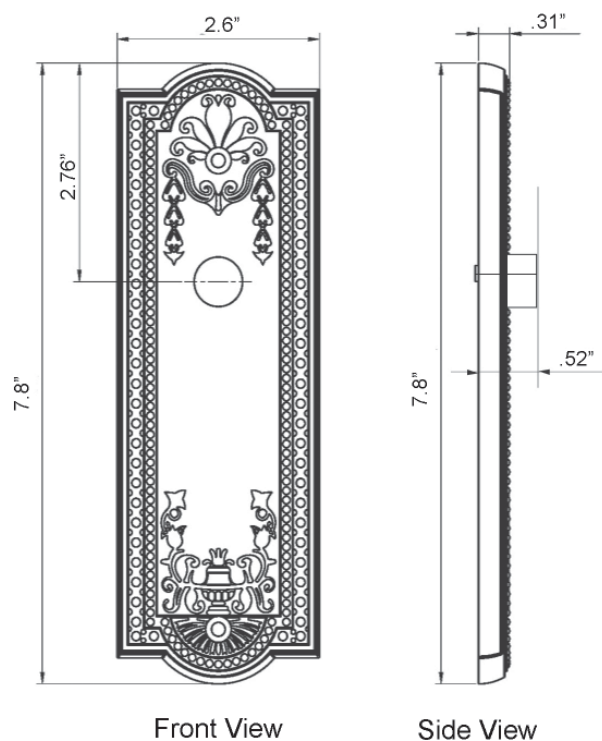

Available in:

Antique Pewter - AP

Polished Brass - PB

Satin Nickel - SN

Oil-Rubbed Bronze Bronze - OB

Antique Brass - AB

Material: Solid Forged Brass

DIMENSIONS - DOOR TRIM

Long Plates & Rosettes (All Dimensions are Approximate)

New York Long Plate (NYK)

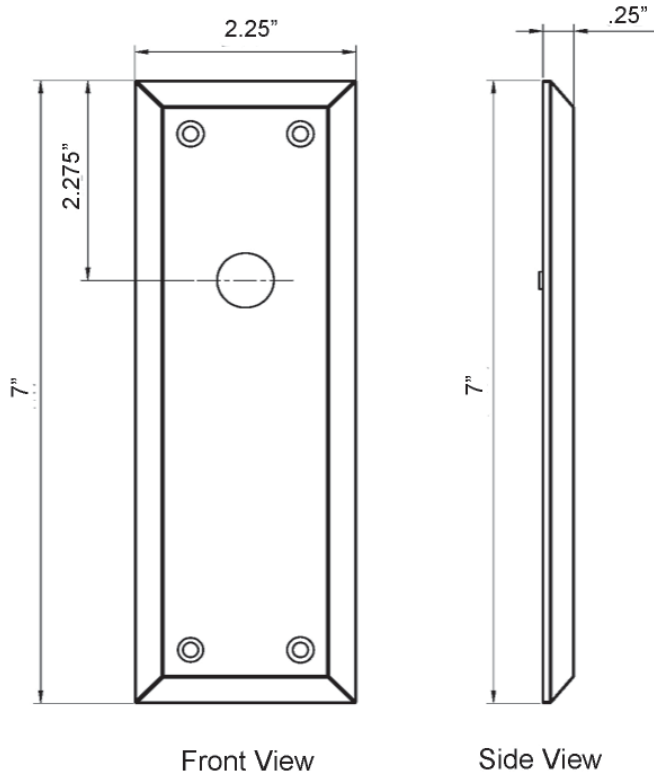

Available in:

Antique Pewter - AP

Bright Chrome - BC

Polished Brass - PB

Satin Nickel - SN

Oil-Rubbed Bronze Bronze - OB

Antique Brass - AB

Material: Solid Forged Brass

Prairie Long Plate (PRA)

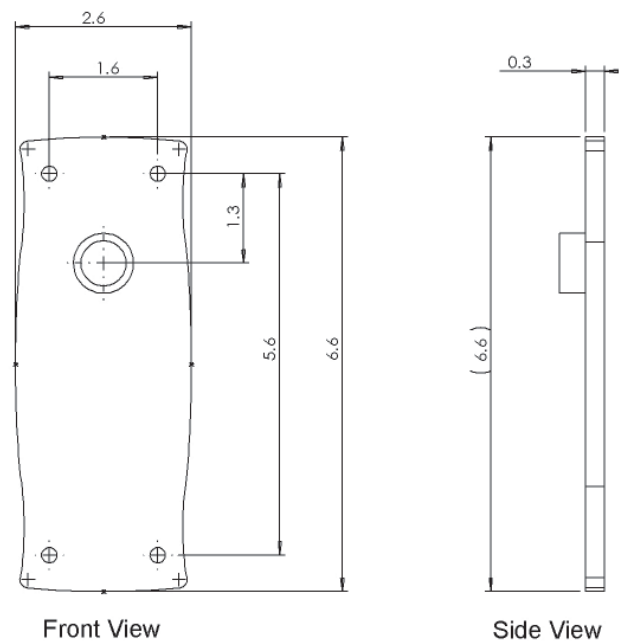

Available in:

Antique Pewter - AP

Polished Brass - PB

Satin Nickel - SN

Oil-Rubbed Bronze Bronze - OB

Antique Brass - AB

Material: Solid Forged Brass

DIMENSIONS - DOOR TRIM

Long Plates & Rosettes (All Dimensions are Approximate)

Rope Rosette (ROP)

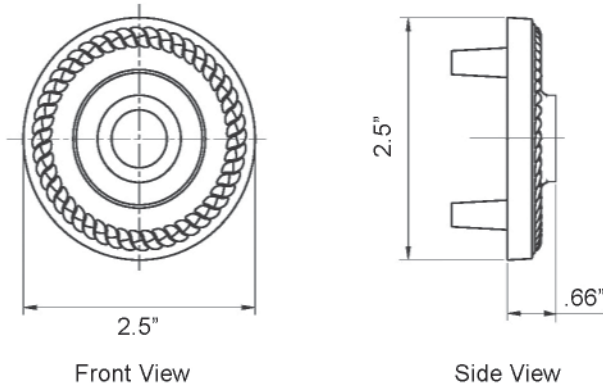

Available in:

Antique Pewter - AP

Bright Chrome - BC

Polished Brass - PB

Satin Nickel - SN

Oil-Rubbed Bronze Bronze - OB

Antique Brass - AB

Material: Solid Forged Brass

Victorian Long Plate (VIC)

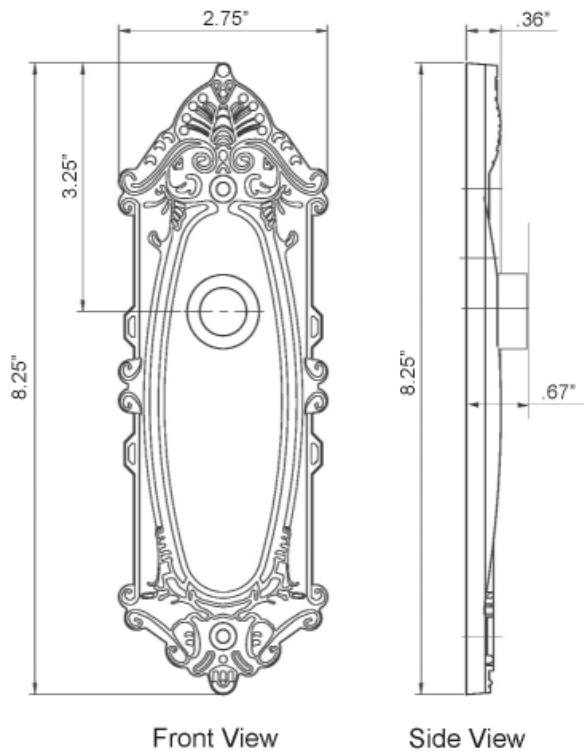

Available in:

Antique Pewter - AP

Polished Brass - PB

Satin Nickel - SN

Oil-Rubbed Bronze Bronze - OB

Antique Brass - AB

Material: Solid Forged Brass

DIMENSIONS - DOOR TRIM

Knobs & Levers (All Dimensions are Approximate)

Crystal Knob (CRY)

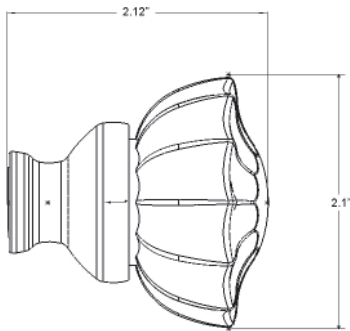

Available in:

Antique Pewter - AP

Bright Chrome - BC

Polished Brass - PB

Satin Nickel - SN

Oil-Rubbed Bronze Bronze - OB

Antique Brass - AB

Material: 9% Lead Crystal

Note: Long Plate & Rosette heights vary

Egg & Dart Knob (EAD)

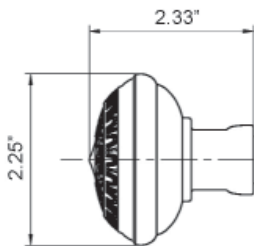

Side View

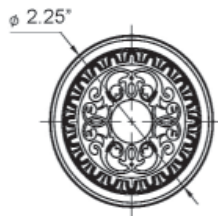

Front View

Available in:

Antique Pewter - AP

Polished Brass - PB

Satin Nickel - SN

Oil-Rubbed Bronze Bronze - OB

Antique Brass - AB

Material: Solid Forged Brass

Note: Long Plate & Rosette heights vary

Homestead Knob (HOM)

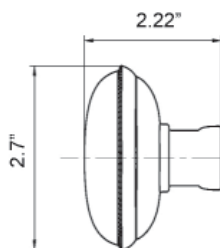

Side View

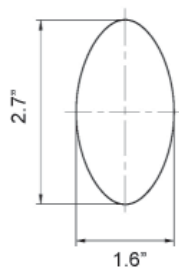

Front View

Available in:

Antique Pewter - AP

Bright Chrome - BC

Polished Brass - PB

Satin Nickel - SN

Oil-Rubbed Bronze Bronze - OB

Antique Brass - AB

Material: Solid Forged Brass

Note: Long Plate & Rosette heights vary

DIMENSIONS - DOOR TRIM

Knobs & Levers (All Dimensions are Approximate)

Meadows Knob (MEA)

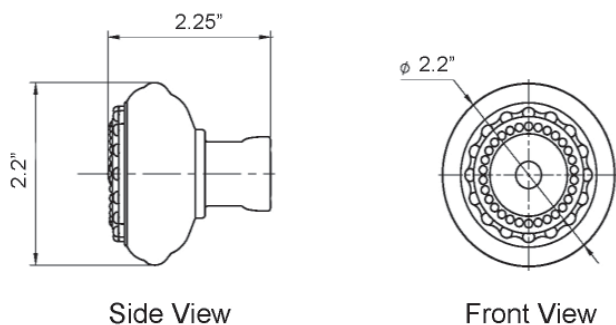

Available in:

Antique Pewter - AP

Bright Chrome - BC

Polished Brass - PB

Satin Nickel - SN

Oil-Rubbed Bronze Bronze - OB

Antique Brass - AB

Material: Solid Forged Brass

Note: Long Plate & Rosette heights vary

New York Knob (NYK)

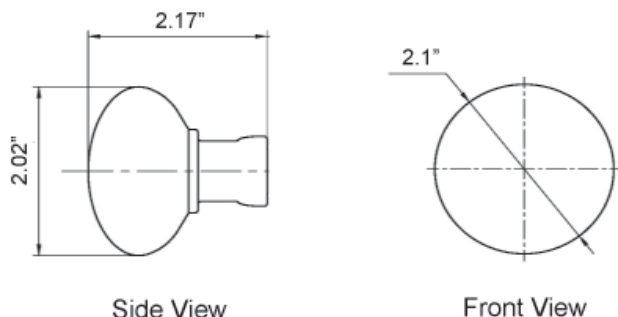

Available in:

Antique Pewter - AP

Bright Chrome - BC

Polished Brass - PB

Satin Nickel - SN

Oil-Rubbed Bronze Bronze - OB

Antique Brass - AB

Material: Solid Forged Brass

Note: Long Plate & Rosette heights vary

Victorian Knob (VIC)

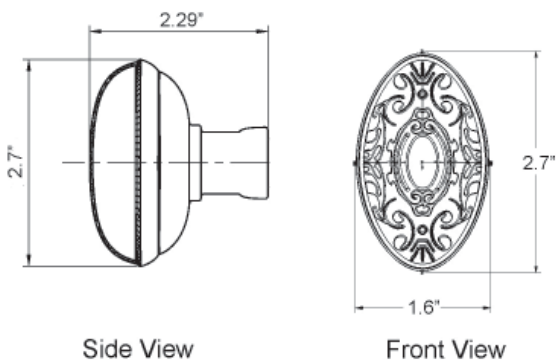

Available in:

Antique Pewter - AP

Polished Brass - PB

Satin Nickel - SN

Oil-Rubbed Bronze Bronze - OB

Antique Brass - AB

Material: Solid Forged Brass

Note: Long Plate & Rosette heights vary

DIMENSIONS - DOOR TRIM

Knobs & Levers (All Dimensions are Approximate)

Waldorf Knob (WAL)

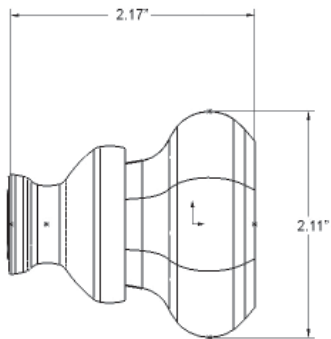

Available in:

Antique Pewter - AP

Bright Chrome - BC

Polished Brass - PB

Satin Nickel - SN

Oil-Rubbed Bronze Bronze - OB

Antique Brass - AB

Material: 9% Lead Crystal

Note: Long Plate & Rosette heights vary

White Porcelain Knob (WHI)

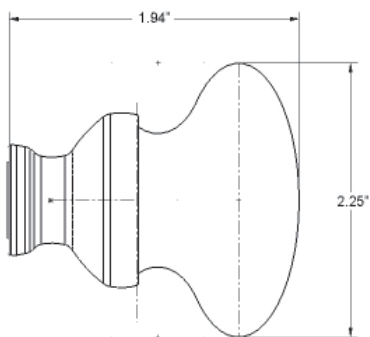

Available in:

Antique Pewter - AP

Bright Chrome - BC

Polished Brass - PB

Satin Nickel - SN

Oil-Rubbed Bronze Bronze - OB

Antique Brass - AB

Material: Porcelain

Note: Long Plate & Rosette heights vary

DIMENSIONS - DEADBOLTS

Deadbolt Escutcheons (All Dimensions are Approximate)

Egg & Dart Escutcheon (EAD)

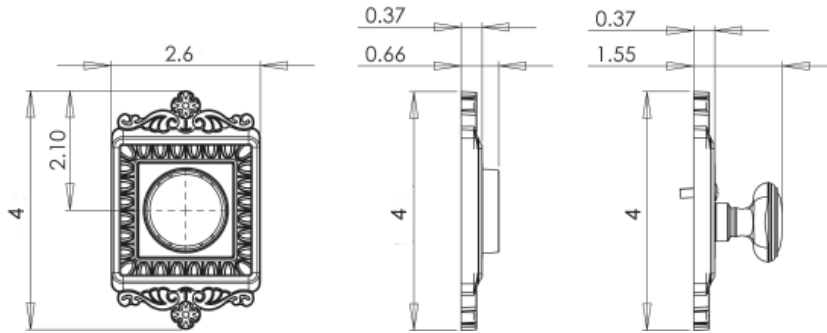

Available in:

Antique Pewter - AP

Polished Brass - PB

Satin Nickel - SN

Oil-Rubbed Bronze Bronze - OB

Antique Brass - AB

Material: Solid Forged Brass

Note: Escutcheon heights may vary

Meadows Escutcheon (MEA)

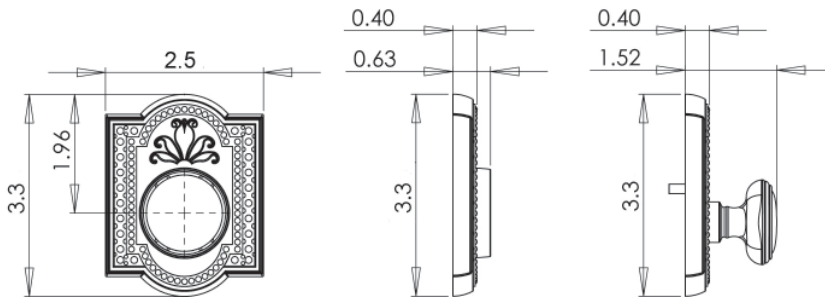

Available in:

Antique Pewter - AP

Polished Brass - PB

Satin Nickel - SN

Oil-Rubbed Bronze Bronze - OB

Antique Brass - AB

Material: Solid Forged Brass

Note: Escutcheon heights may vary

DIMENSIONS - DEADBOLTS

Deadbolt Escutcheons (All Dimensions are Approximate)

New York Escutcheon (NYK)

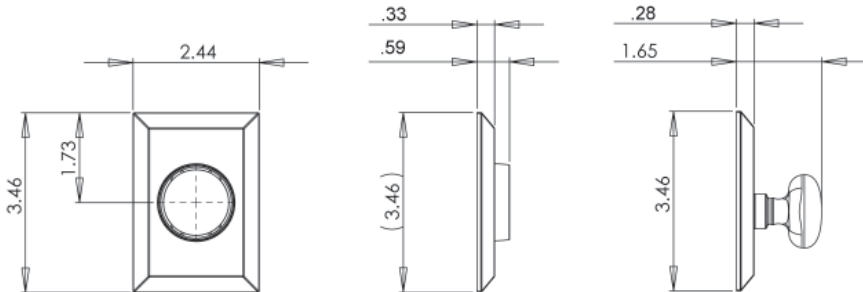

Available in:

Antique Pewter - AP

Bright Chrome - BC

Polished Brass - PB

Satin Nickel - SN

Oil-Rubbed Bronze Bronze - OB

Antique Brass - AB

Material: Solid Forged Brass

Note: Escutcheon heights may vary

Victorian Escutcheon (VIC)

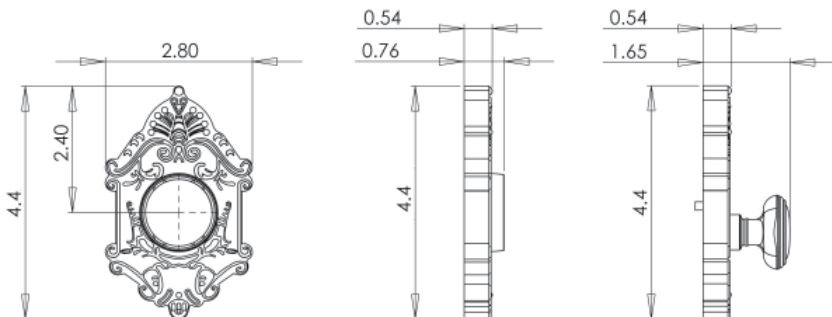

Available in:

Antique Pewter - AP

Polished Brass - PB

Satin Nickel - SN

Oil-Rubbed Bronze Bronze - OB

Antique Brass - AB

Material: Solid Forged Brass

Note: Escutcheon heights may vary

DIMENSIONS - Handlesets

Egg & Dart with "C" Grip (EADCGR)

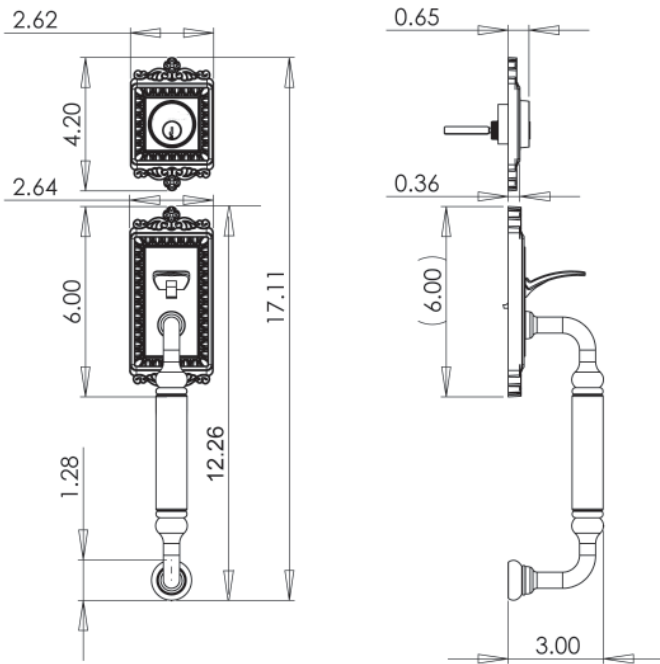

Material: Solid Forged Brass

Minimum Bore Distance is recommended at 5"

Available in:

Antique Pewter - AP

Satin Nickel - SN

Timeless Bronze - TB

Vintage Brass - VB

Lifetime Brass - LB

Note: Handleset heights may vary

Available in:

Antique Pewter - AP

Satin Nickel - SN

Timeless Bronze - TB

Vintage Brass - VB

Lifetime Brass - LB

Note: Handleset heights may vary

Meadows with "C" Grip (MEACGR)

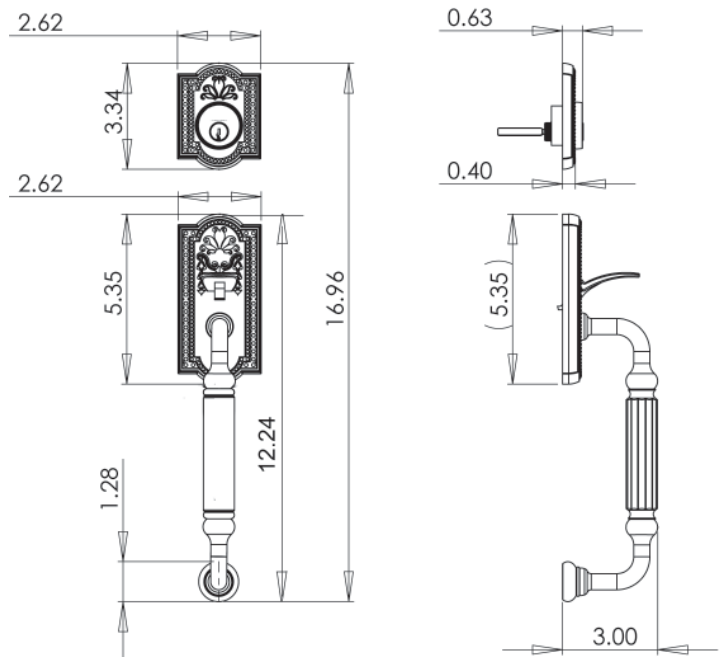

Material: Solid Forged Brass

Minimum Bore Distance Center to Center = 4 - 3/8"

DIMENSIONS - Handlesets

Handlesets (All Dimensions are Approximate)

New York with "C" Grip (NYKCGR)

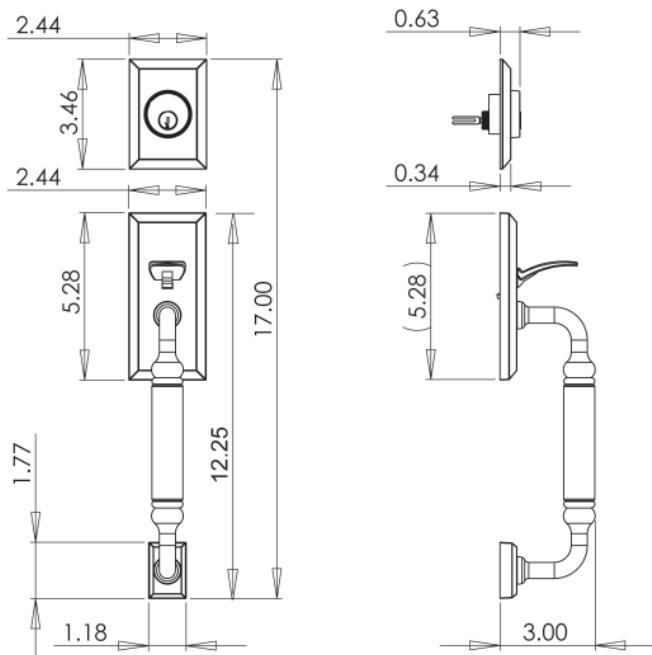

Material: Solid Forged Brass

Minimum Bore Distance Center to Center = 4 - 3/8"

Available in:

Antique Pewter - AP

Satin Nickel - SN

Timeless Bronze - TB

Vintage Brass - VB

Lifetime Brass - LB

Note: Handleset heights may vary

Available in:

Antique Pewter - AP

Satin Nickel - SN

Timeless Bronze - TB

Vintage Brass - VB

Lifetime Brass - LB

Note: Handleset heights may vary

New York with "S" Grip (NYKSGR)

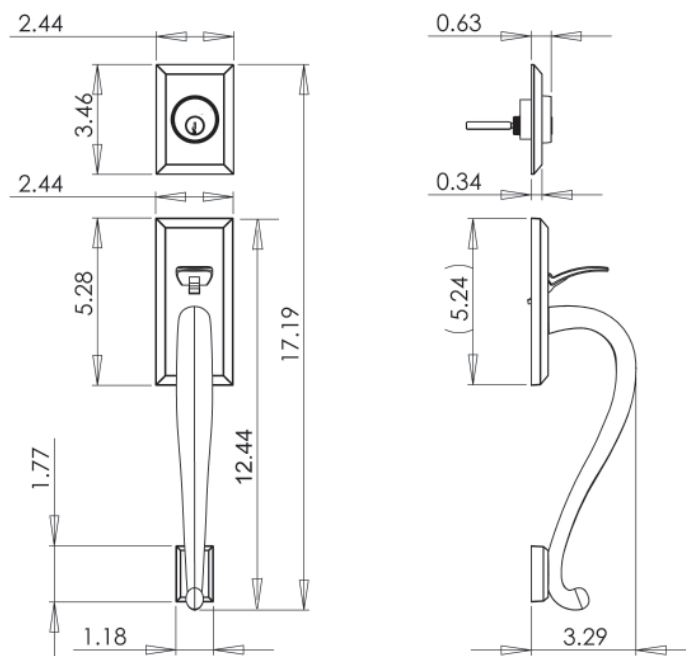

Material: Solid Forged Brass

Minimum Bore Distance is recommended at 5"

DIMENSIONS - Handlesets

Handlesets (All Dimensions are Approximate)

Victorian with "S" Grip (VICSGR)

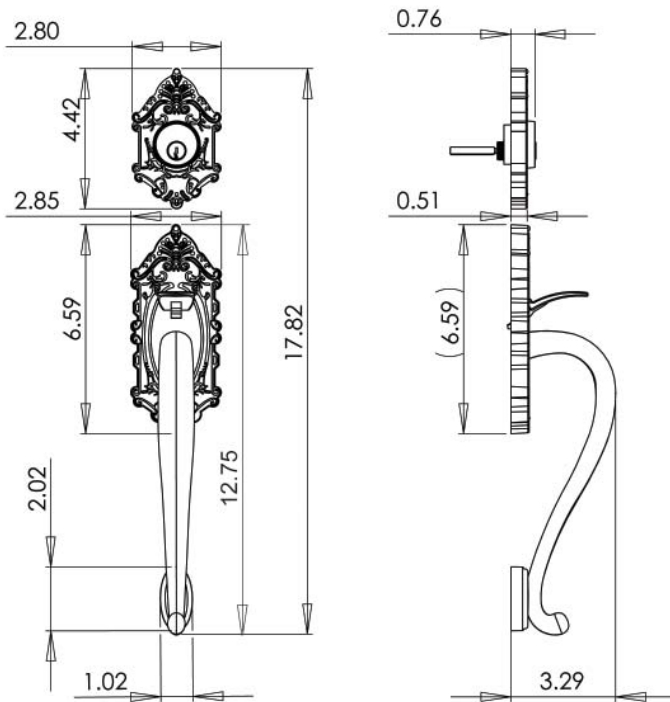

Material: Solid Forged Brass

Minimum Bore Distance is recommended at 5"

Available in:

Bright Chrome - BC

Lifetime Brass - LB

Available in:

Antique Pewter - AP

Satin Nickel - SN

Timeless Bronze - TB

Vintage Brass - VB

Lifetime Brass - LB

Note: Handleset heights may vary

Oxford Park

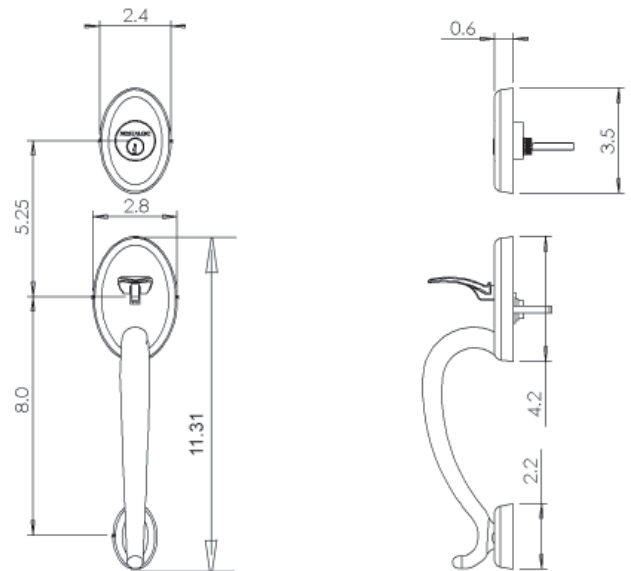

Material: Solid Forged Brass

Note: Handleset heights may vary

DIMENSIONS - Handlesets

Handlesets (All Dimensions are Approximate)

"C" Grip

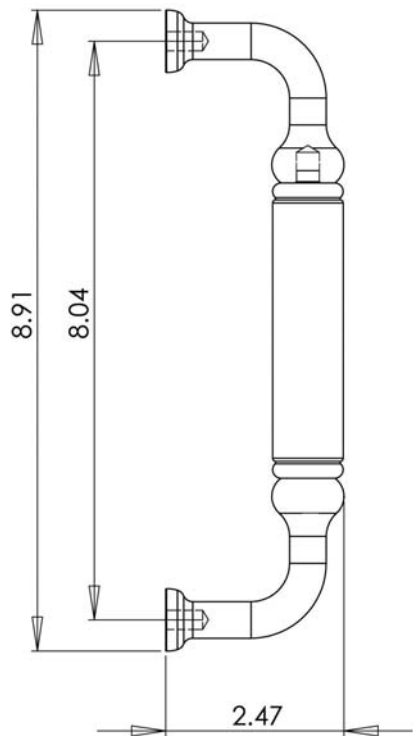

Material: Solid Forged Brass

Available in:

Antique Pewter - AP

Satin Nickel - SN

Timeless Bronze - TB

Vintage Brass - VB

Lifetime Brass - LB

Note: Handleset heights may vary

"S" Grip

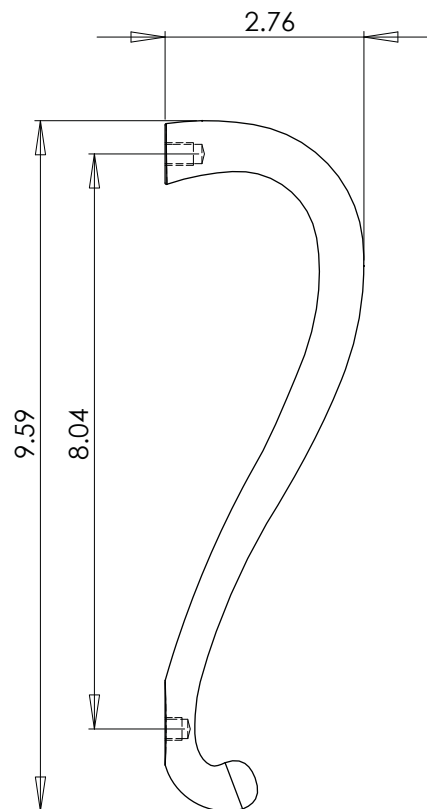

Available in:

Antique Pewter - AP

Satin Nickel - SN

Timeless Bronze - TB

Vintage Brass - VB

Lifetime Brass - LB

Note: Handleset heights may vary

Material: Solid Forged Brass

DIMENSIONS - Pushplates

Pushplates (All Dimensions are Approximate)

Louis Pushplate

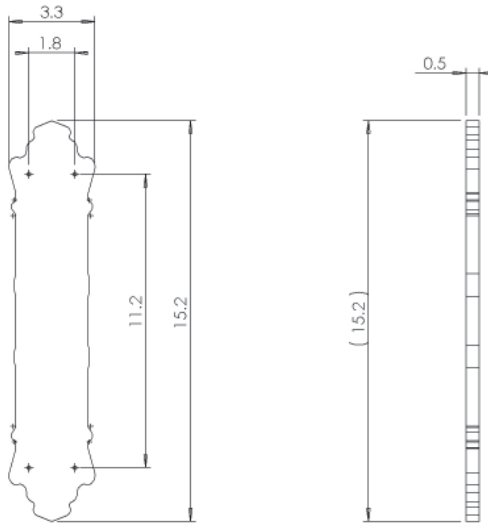

Available in:

Antique Pewter - AP

Polished Brass - PB

Satin Nickel - SN

Oil-Rubbed Bronze Bronze - OB

Antique Brass - AB

Material: Solid Forged Brass

Note: Pushplate heights may vary

San Francisco Pushplate

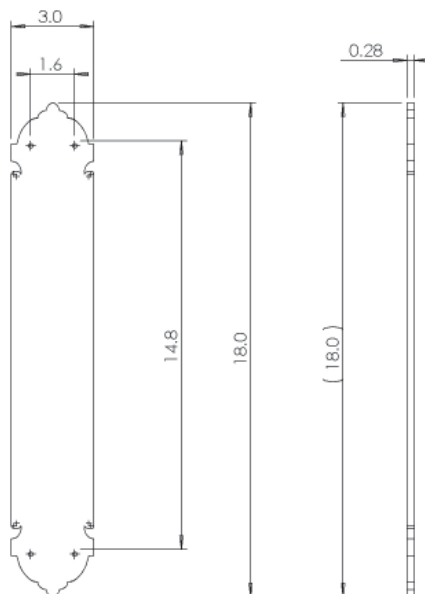

Available in:

Antique Pewter - AP

Polished Brass - PB

Satin Nickel - SN

Oil-Rubbed Bronze Bronze - OB

Antique Brass - AB

Material: Solid Forged Brass

Note: Pushplate heights may vary

DIMENSIONS - Pushplates

Pushplates (All Dimensions are Approximate)

New Orleans Pushplate

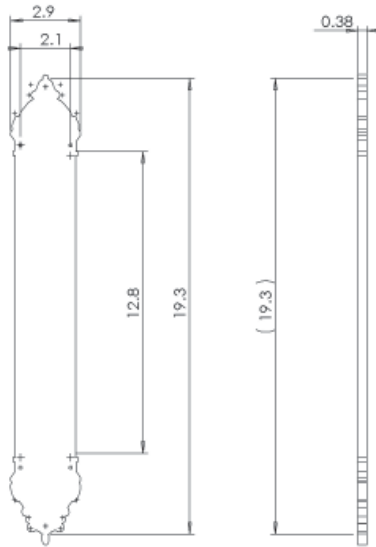

Available in:

Antique Pewter - AP

Polished Brass - PB

Satin Nickel - SN

Oil-Rubbed Bronze Bronze - OB

Antique Brass - AB

Material: Solid Forged Brass

Note: Pushplate heights may vary

New Orleans Small Pushplate

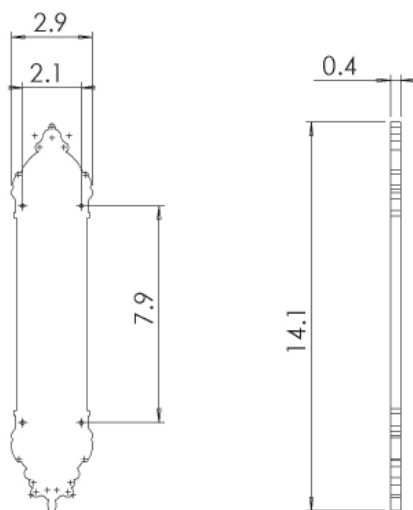

Available in:

Antique Pewter - AP

Polished Brass - PB

Satin Nickel - SN

Oil-Rubbed Bronze Bronze - OB

Antique Brass - AB

Material: Solid Forged Brass

Note: Pushplate heights may vary

DIMENSIONS - Pushplates

Pushplates (All Dimensions are Approximate)

New York Pushplate

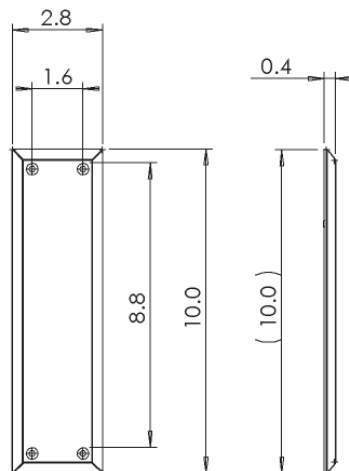

Available in:

Antique Pewter - AP

Polished Brass - PB

Satin Nickel - SN

Oil-Rubbed Bronze Bronze - OB

Antique Brass - AB

Material: Solid Forged Brass

Note: Pushplate heights may vary

Prairie Pushplate

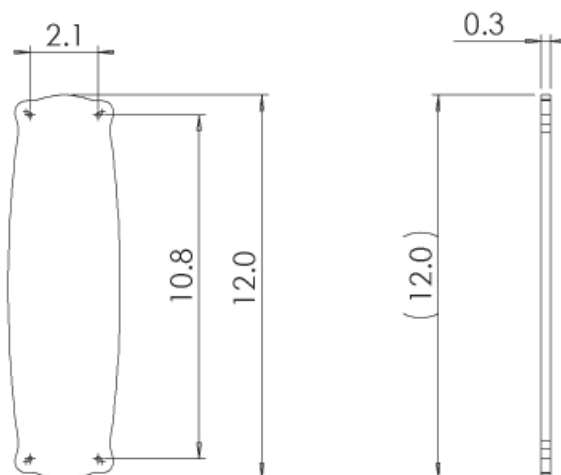

Available in:

Antique Pewter - AP

Polished Brass - PB

Satin Nickel - SN

Oil-Rubbed Bronze Bronze - OB

Antique Brass - AB

Material: Solid Forged Brass

Note: Pushplate heights may vary

DIMENSIONS - Accessories

Hooks (All Dimensions are Approximate)

Plain/Rope Hook

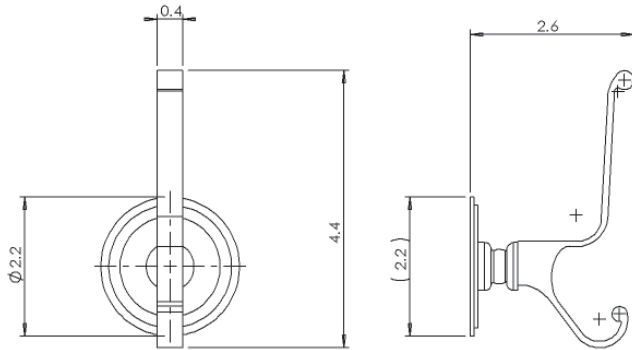

Available in:

Antique Pewter - AP

Polished Brass - PB

Satin Nickel - SN

Oil-Rubbed Bronze Bronze - OB

Antique Brass - AB

Classic Hook

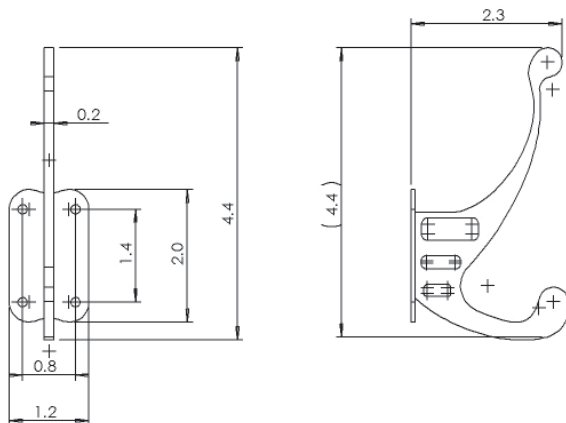

Available in:

Antique Pewter - AP

Polished Brass - PB

Satin Nickel - SN

Oil-Rubbed Bronze Bronze - OB

Antique Brass - AB

Victorian Hook

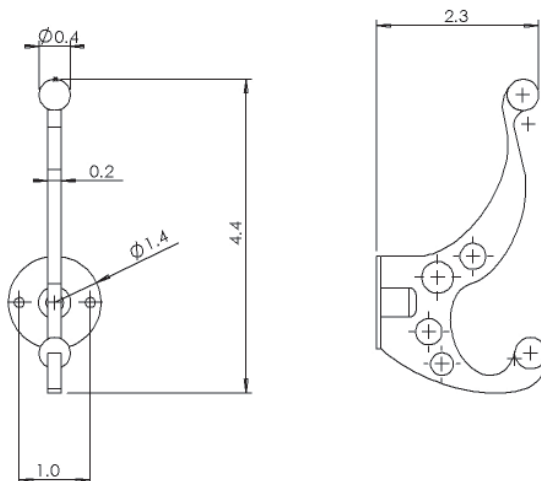

Available in:

Antique Pewter - AP

Polished Brass - PB

Satin Nickel - SN

Oil-Rubbed Bronze Bronze - OB

Antique Brass - AB

DIMENSIONS - Accessories

Crystal Cabinet Hardware (All Dimensions are Approximate)

Clear Crystal Handle

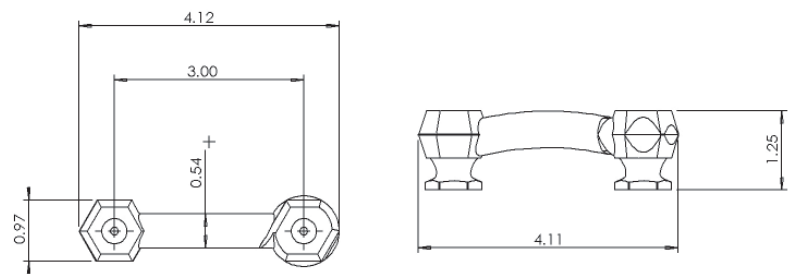

1-1/2" Clear Crystal Knob

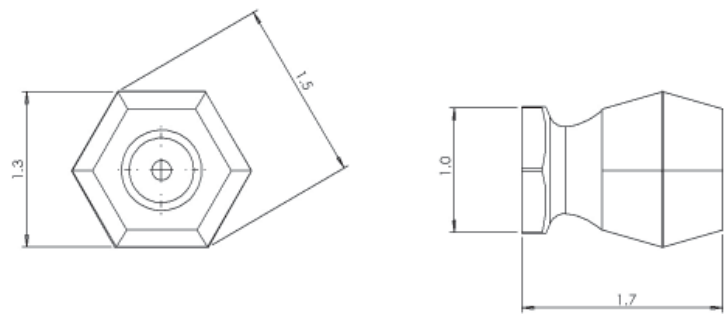

1-1/4" Clear Crystal Knob

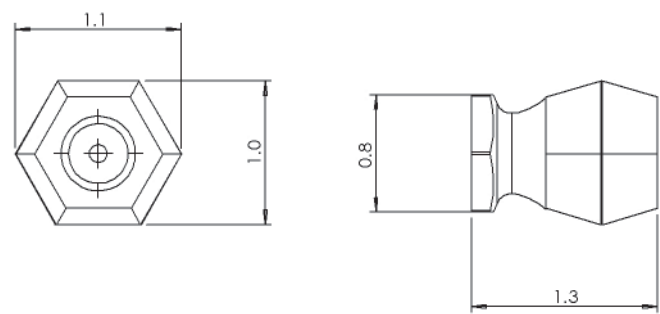

1" Clear Crystal Knob

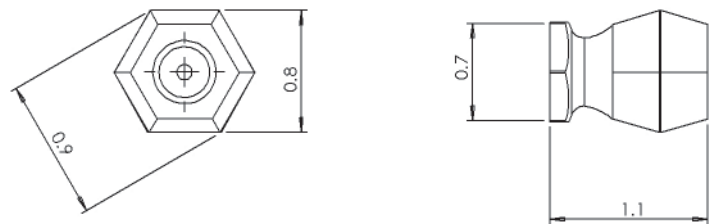

DIMENSIONS - Accessories

Accessories (All Dimensions are Approximate)

1-1/4" Plain Cabinet Knob

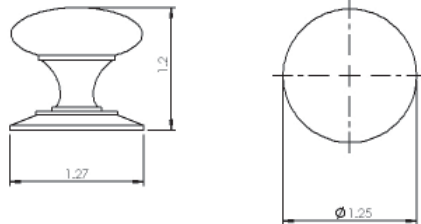

1-1/2" Plain Cabinet Knob

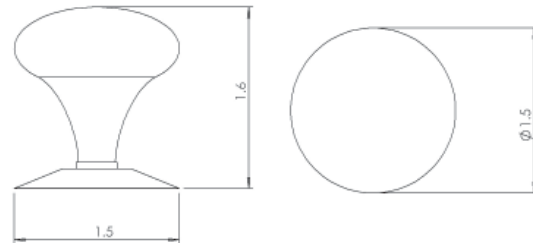

Flush Catch

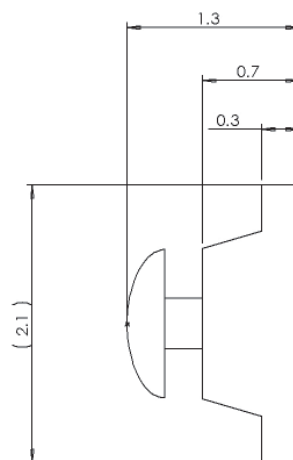
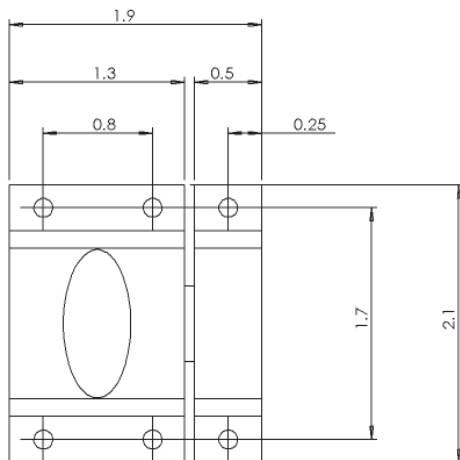

Available in:

Antique Pewter - AP

Polished Brass - PB

Satin Nickel - SN

Oil-Rubbed Bronze - OB

Antique Brass - AB

Flush Pull

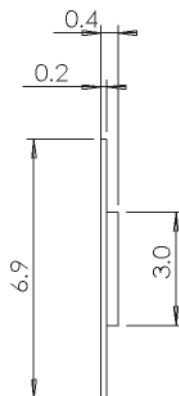
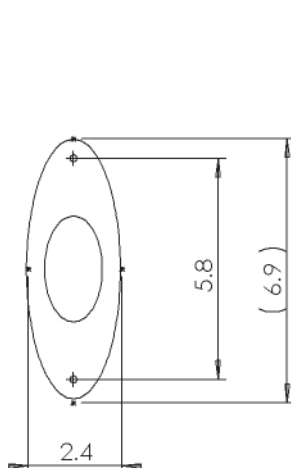

Available in:

Polished Brass - PB

DIMENSIONS - Accessories

Ball Tipped Hinges (All Dimensions are Approximate)

Small Hinge

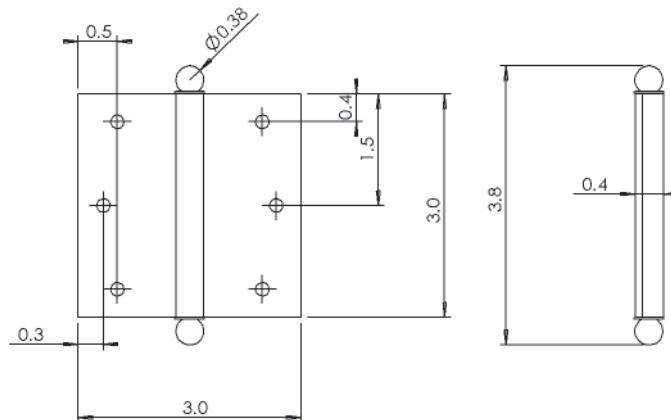

Available in:

Antique Pewter - AP

Polished Brass - PB

Satin Nickel - SN

Oil-Rubbed Bronze - OB

Antique Brass - AB

Note: Screw patterns may vary

Medium Hinge

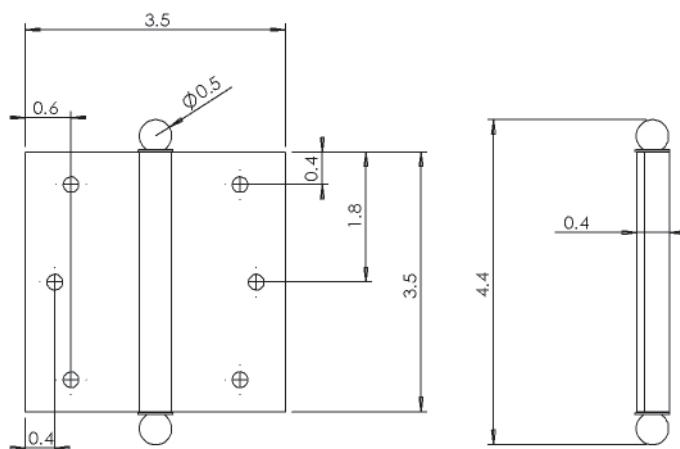

Available in:

Antique Pewter - AP

Polished Brass - PB

Satin Nickel - SN

Oil-Rubbed Bronze - OB

Antique Brass - AB

Note: Screw patterns may vary

Large Hinge

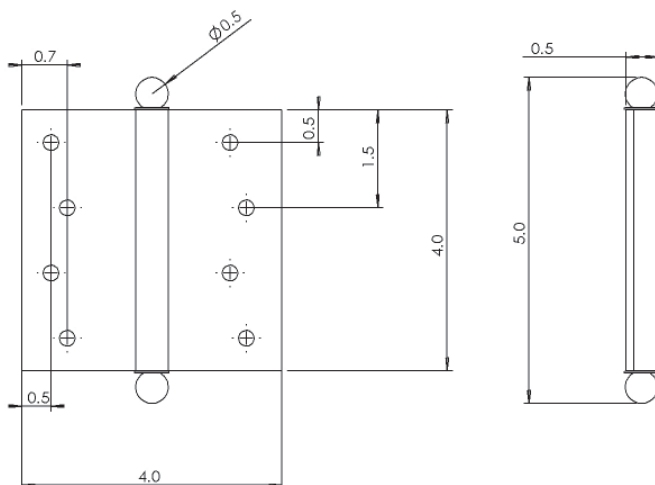

Available in:

Antique Pewter - AP

Polished Brass - PB

Satin Nickel - SN

Oil-Rubbed Bronze - OB

Antique Brass - AB

Note: Screw patterns may vary

DIMENSIONS - PARTS

2-3/8" Tubular Latch (Passage & Privacy)

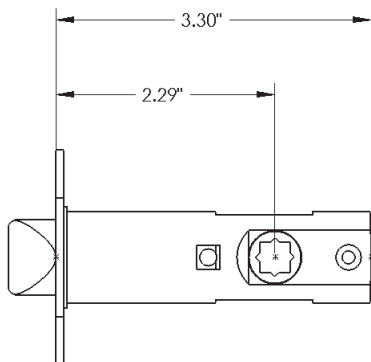

2-3/4" Tubular Latch (Passage & Privacy)

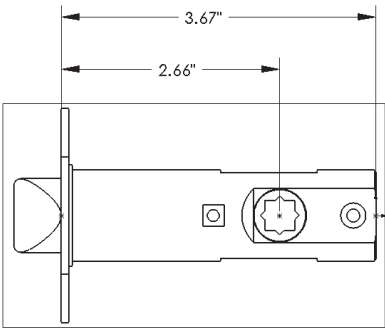

2-3/8" Drive-In Latch (Passage & Privacy)

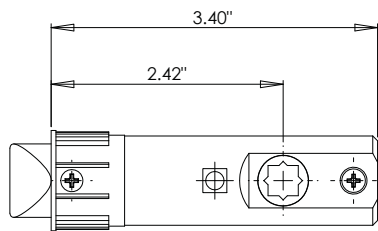

2-3/4" Drive-In Latch (Passage & Privacy)

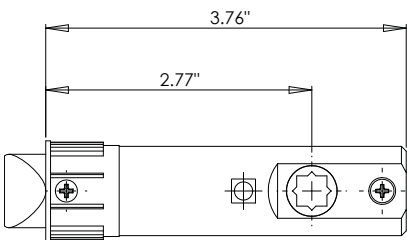

2-3/8" Deadbolt

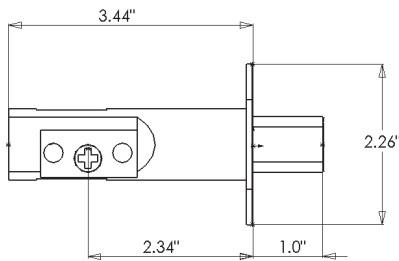

2-3/4" Deadbolt

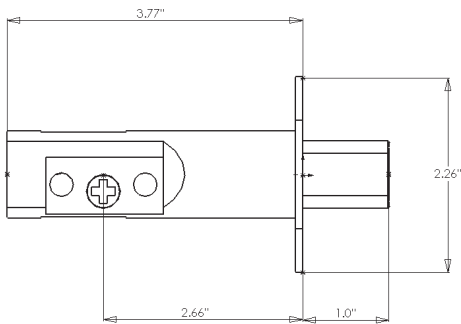

Mortise Box

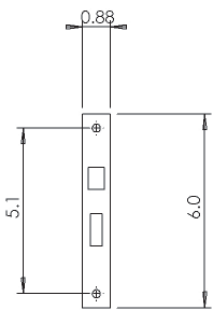
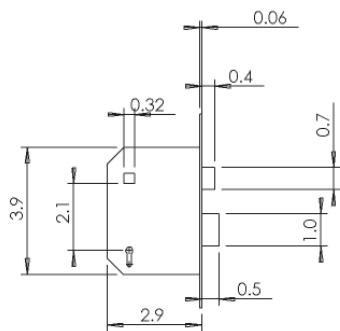

DIMENSIONS - PARTS

Tubular Faceplates

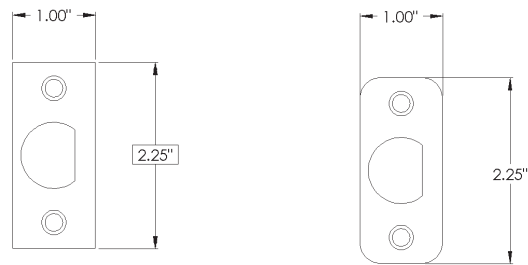

Square Tubular

Radius/Round
Tubular

Deadbolt Faceplates

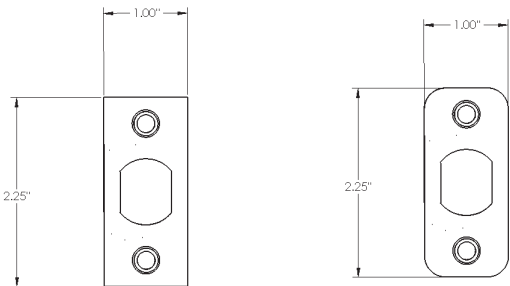

Square Deadbolt

Radius/Round
Deadbolt

Tubular Latch Strikes

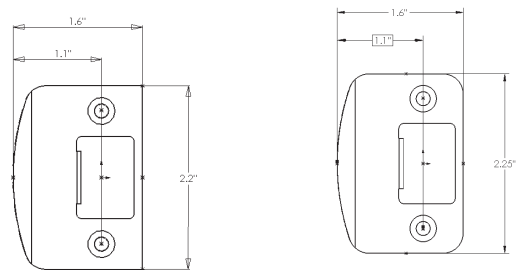

Square Tubular

Radius/ Round
Tubular

Drive-In Strikes

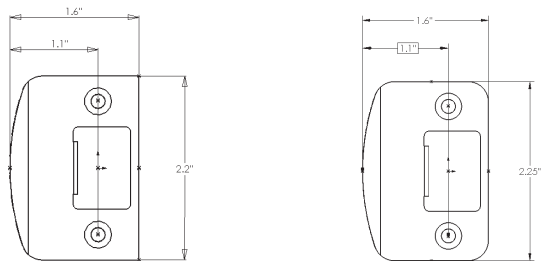

Square Drive-In

Radius/ Round
Drive-In

Deadbolt Strikes

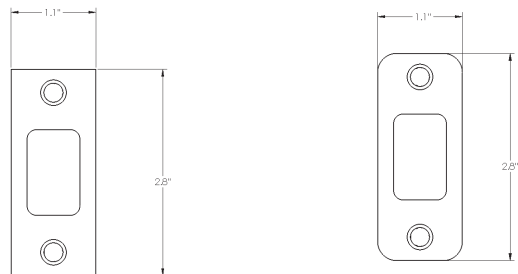

Square Deadbolt

Radius/Round
Deadbolt

Mortise Strike

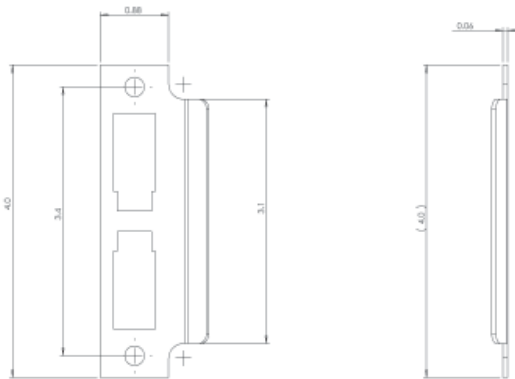

Front View

Side View

PARTS - Continued

Door Stop

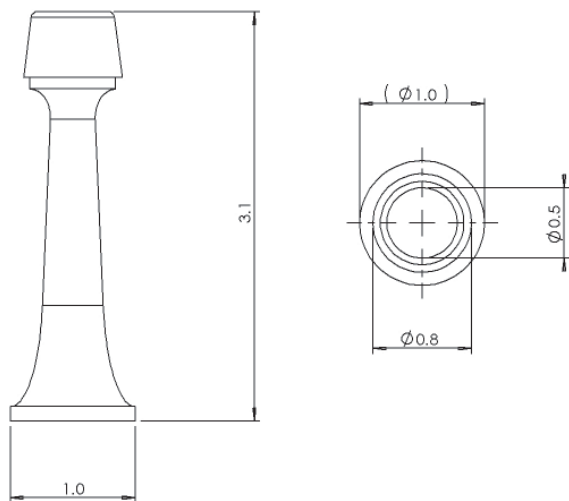

Key

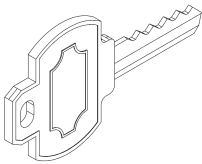

Schlage C-Keyway