



Engineered Beautifully

# Sliding, Pocket, & Barn Door Locks

## BD1000/BD4000/PD5000/PD8000/PD9000



(Edition 4)

BD1000/BD4000/PD5000/PD8000/PD9000 Series

**NEW RELEASE  
2018**

**INOX™**

[www.inoxproducts.com](http://www.inoxproducts.com)

Version: 2018.v5



## Finish Options

### Stainless Steel

Stainless Steel is a corrosion-resistant Lifetime metal, which makes it ideal for use on exterior doors that are subject to extreme weather conditions. INOX product has a stellar environmental track record with stainless steel manufacturing -- our factories have state of the art processes that dramatically reduce carbon emissions, conserve energy, and recycle raw materials. Our INOX line of stainless steel product brings out the innate beauty of the nickel content.

The mirror-like Bright Stainless Steel (US32/629) finish creates an elegant, modern look that complements and accentuates a variety of decors and architectural styles. Hand polishing in the Satin Stainless Steel (US32D/630) finish exposes the elegant color and smooth texture of this rich metal and ensures a long-lasting finish compared to ordinary plating finishes. Oil Rubbed Bronze (US10B/613) is an enduring living finish that creates unique, distinctive bronze highlights over time. Graphite Black (a non-ceramic option) is deep, rich, and as beautiful as the night.



Satin  
Stainless Steel  
(US32D)



Bright Polished  
Stainless Steel  
(US32)



Oil Rubbed  
Bronze on  
Stainless Steel  
(US10B)



Graphite Black  
on Stainless Steel  
(19G)

### PVD - Physical Vapor Deposition

PVD is a process that produces a metal vapor deposited on electrically-conductive materials as a thin, highly adhered pure metal or alloy coating. A wide range of decorative PVD colors are available, including brass tones, gold tones, black to grey, silver tones (nickel, chrome), copper and bronze tones. Our PVD finishes are available in bright, satin, or matte tones; note that actual finish may differ from color shown. Contact Sales Department for availability.



Aged Gold

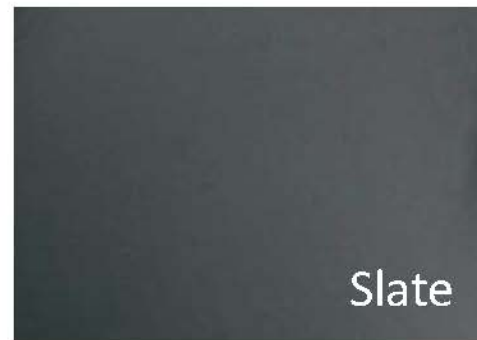

Slate

### CeraMax™ Ceramic Coating

Ceramic coating not only provides a rainbow of new color options, but offers effective abrasive-resistant qualities for areas with adverse weather conditions. Please inquire about color options, lead time, and minimum order quantities (if any). **Never use abrasives to clean ceramic coating.**



Ceramic Graphite  
Black (C19G)



Ceramic Flat Black  
(C19)



Ceramic Stormy  
Grey (CGY)



Ceramic Dark  
Bronze (CDB)

Many other colors available upon special request.



Additional Finish information on page 35.



## TABLE OF CONTENTS

<b>BD4000 &amp; BD1000 Privacy Lock for Barn Doors.....</b>	Page 02
How to Order .....	Page 03
Application & Installation .....	Page 04
Concealed Trim.....	Page 07
Installing with Metal Studs in Jamb .....	Page 08
BD1000 Surface-Mounted Privacy Lock.....	Page 09
Pull Options.....	Page 10
 <b>PD5000 &amp; PD8000 Mortise Locks .....</b>	Page 12
How to Order .....	Page 15
PD5000 Specifications, Application, Functions .....	Page 16
PD8000 Specifications, Application, Functions .....	Page 18
Americans with Disabilities Act (ADA) Compliance .....	Page 20
Other Surface Pulls .....	Page 22
Other Surface Pulls .....	Page 22
Surface Pull Fixing, Mortise Cylinders & Keys .....	Page 23
Cylinder Collar, Thumbturn, & Emergency Release Options .....	Page 24
Adjustable Strikes .....	Page 25
Flush Pulls for Pocket Doors .....	Page 26
How to Order .....	Page 27
• FH27 Linear/FH27SL Slim Trim .....	Page 28
• FH29 Arc .....	Page 29
• FH 31 Regal .....	Page 30
• FH32 Crown.....	Page 31
• FH22 Luna.....	Page 32
• FH23 Urban .....	Page 33
• FH22CF & FH23CF Concealed Fixing Trim.....	Page 34
Flush Pull & Finish Options .....	Page 35
 <b>PD9000 Mortise Lock with Emergency Egress.....</b>	Page 36
How to Order .....	Page 39
PD9000 Specifications, Application .....	Page 40
PD9000 Functions, Lever Options .....	Page 41



# BD4000 & BD1000 Privacy Lock for Barn Doors





## BD4000 Privacy Lock for Sliding Barn Doors

### How to Order

Specify/Order Privacy Lock for Sliding Barn Door using complete codes as below

Item Code:

**EC1216 -BD4214 -32D**

#### \*Finish:

US32 (629) = Bright Stainless Steel  
 US32D (630) = Satin Stainless Steel  
 US10B (613) = Oil Rubbed Bronze  
 US26D (626) = Satin Chrome  
 US4 (606) = Satin Bronze  
 19G = Graphite Black

#### Ceramic Coating:

C19G = Ceramic Graphite Black  
 C19 = Ceramic Flat Black  
 CGY = Ceramic Stormy Grey  
 CDB = Ceramic Dark Bronze

\*Note: Faceplates and Strike Plates are finished in Satin Nickel, Satin Brass, or Black depending on the escutcheon/trim finish ordered.

#### Backset:

-BD4214 = 2-1/4"  
 -BD4312 = 3-1/2"

#### Trim:

EC1216 = Round escutcheon with oblong thumbturn  
 EC1217 = Round escutcheon with ADA thumbturn  
 EC1314 = Square escutcheon with rectangular thumbturn  
 EC1315 = Square escutcheon with ADA rectangular thumbturn  
 EC1515 = Rectangular escutcheon with ADA rectangular thumbturn  
 EC1517 = Rectangular escutcheon with ADA thumbturn  
 FH22CF = Luna concealed trim with thumbturn  
 FH23CF = Urban concealed trim with thumbturn

## BD1000 Privacy Lock for Sliding Barn Doors

Specify/Order BD1000 Privacy Lock for Sliding Barn Door using complete codes as below

Item Code:

**BD1022 -32D**

#### \*Finish:

US32 (629) = Bright Stainless Steel  
 US32D (630) = Satin Stainless Steel  
 US10B (613) = Oil Rubbed Bronze  
 19G = Graphite Black  
 PVD4 = Satin Brass

#### Ceramic Coating:

C19G = Ceramic Graphite Black  
 C19 = Ceramic Flat Black  
 CGY = Ceramic Stormy Grey  
 CDB = Ceramic Dark Bronze

#### Thumb Lever

-BD1022 = TT22  
 -BD1023 = TT23

## BD4000 Privacy Lock for Sliding Barn Door



### Application

- A simple and elegant privacy lock for barn door openings for either residential or commercial applications, without having to build out extra frames
- Tubular drive-in bolt installed inside the jamb
- Dust-proof strike installed in the door
- Discrete release button with decorative cap installed on outside of the door for emergency release
- A variety of trim escutcheons with thumbturn installed on jamb side allow locking and unlocking of the bolt from inside
- ADA thumbturn available for commercial and hospitality applications
- Two backsets available: 2-1/4" and 3-1/2"

### Overlap

- \* Door Overlap is the distance from the edge of the door to the edge of the wall. Measure the Door Overlap on the lock side when the door is fully closed.  
NOTE: Standard door opening walls have 2 wood studs behind drywall or trim casing.

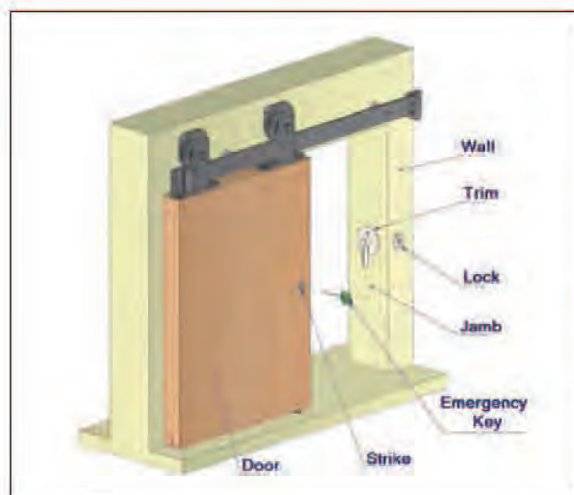
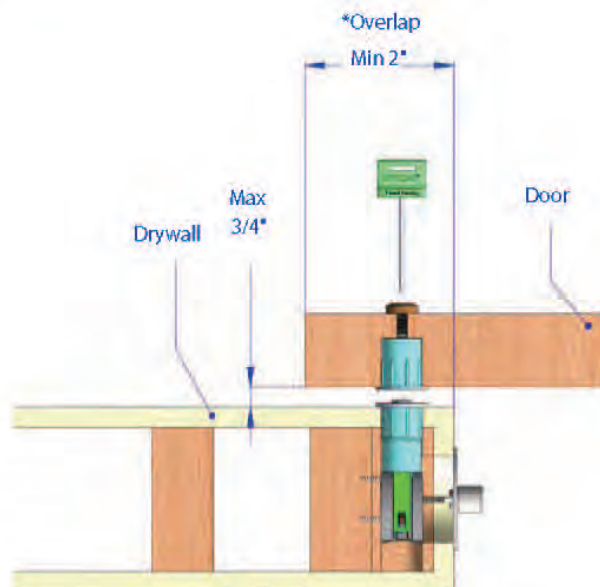

### Installation

- Available on leading and trailing side of the Barn Door





## BD4000 Privacy Lock for Sliding Barn Door

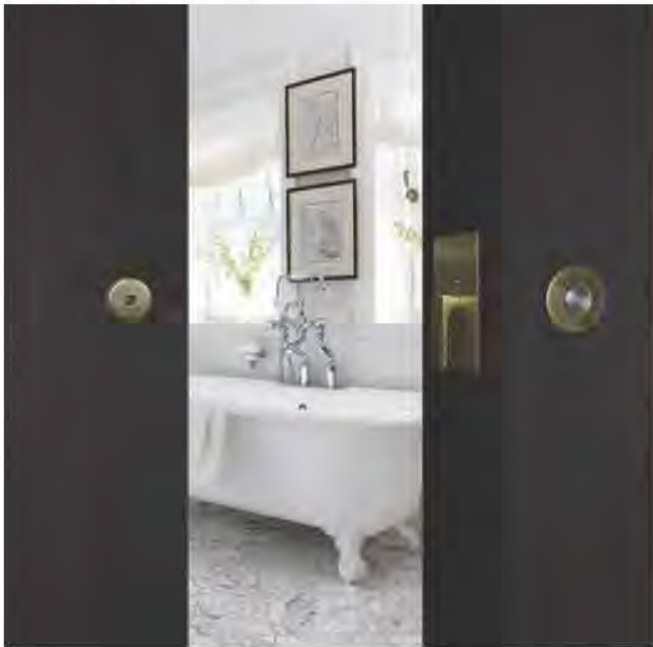

### Wall Thickness



Wall Thickness:  
4-1/2" ~ 6-1/2"  
Lock: BD4214  
Backset: 2-1/4"



Wall Thickness:  
6-1/2" and up  
Lock: BD4312  
Backset: 3-1/2"



### Lock

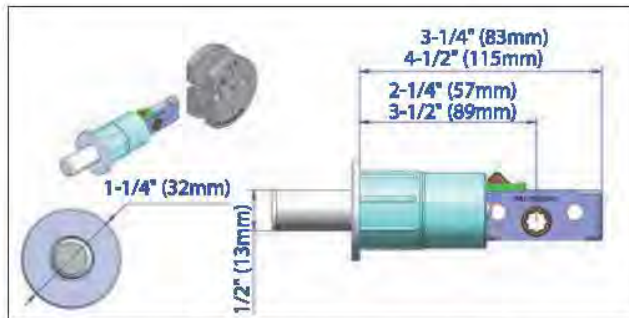

- BD4000 Lock Bolt is mortised into the jamb stud
- Backset available in 2-1/4" (57mm) and 3-1/2" (89mm)
- Drive-in Bolt Casing diameter: 1" (25mm)
- Lock Bolt: 1/2" (13mm) diameter Stainless Steel
- Strike mounted in Barn Door for standard door thickness: 1-3/8" (35mm) to 1-3/4" (45mm)
- Thick Door Kits (TDKs) available
- Handing: Non-handed
- Spindle Hub: 5x5mm square

### Finishes

Bright Stainless (US32)  
Satin Stainless (US32D) Oil  
Rubbed Bronze (US10B)  
Satin Chrome (US26D)  
Satin Bronze (US4)  
Graphite Black (19G)

**Ceramic Coating:**  
Ceramic Graphite Black (C19G)  
Ceramic Flat Black (C19)  
Ceramic Stormy Grey (CGY)  
Ceramic Dark Bronze (CDB)

### Adjustable Dust Proof Strike

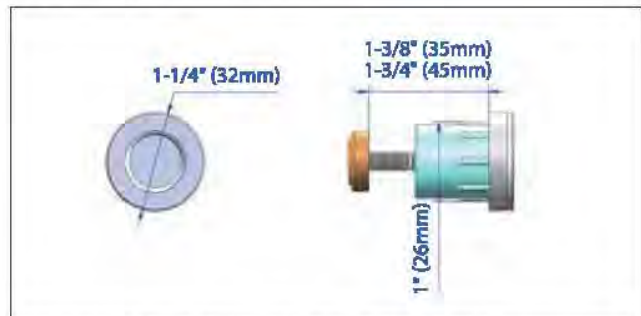

- 1-1/4" (32mm) diameter spring-loaded dust proof strike provides ample space to receive 1/2" (13mm) bolt and allows easy locking by end user



- Minimum aesthetic impact on door surface
- Strike can be adjusted to fit barn door thickness from 1-3/8" (35mm) to 1-3/4" (45mm)
- Thick Door Kits (TDK) available

## BD4000 Privacy Lock for Sliding Barn Door

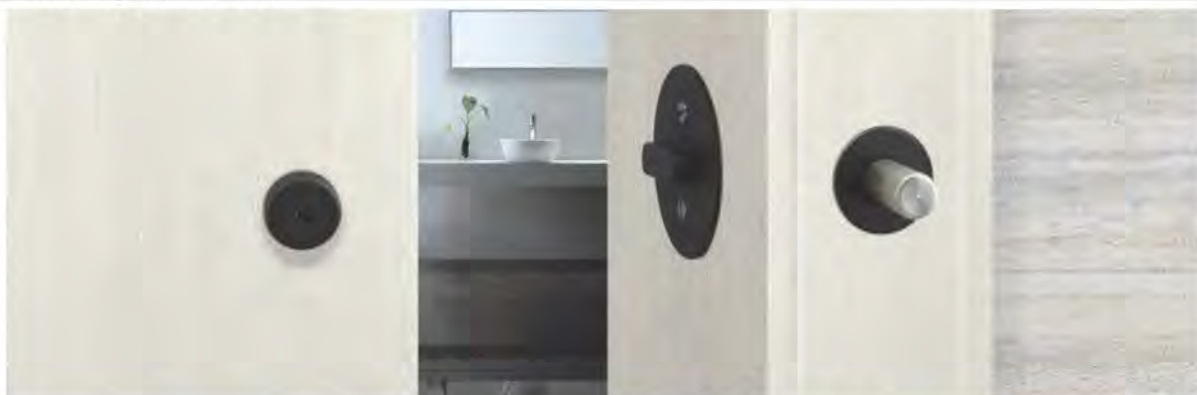

### Escutcheons & Thumbturns

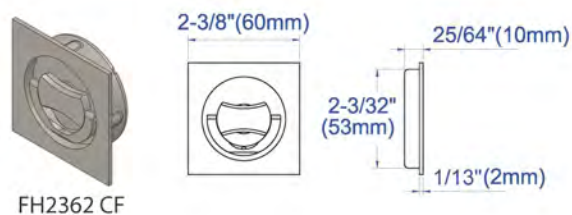
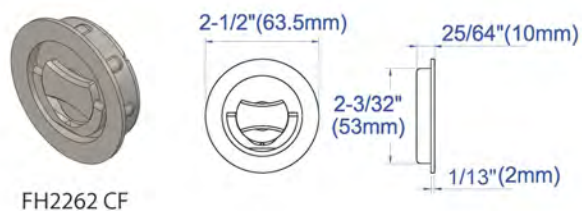
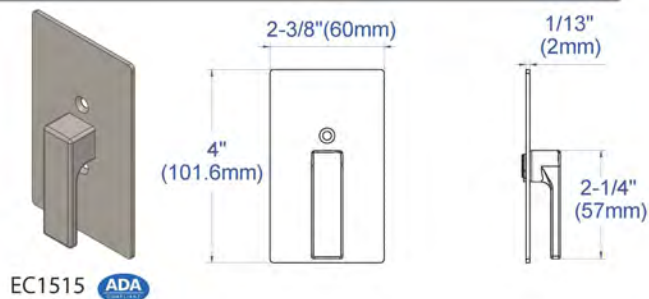
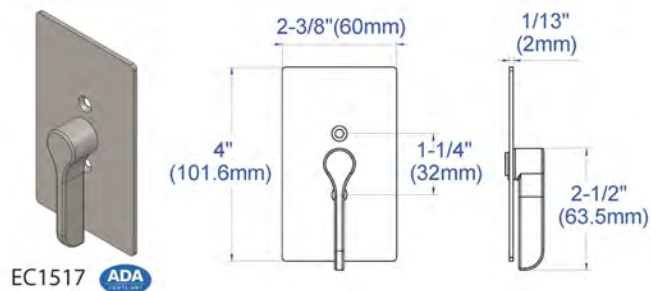
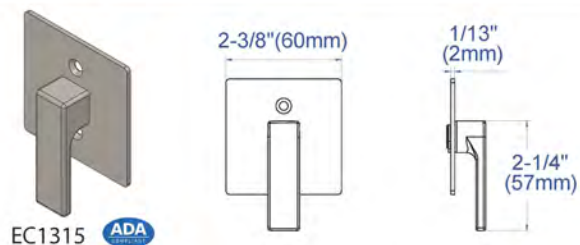
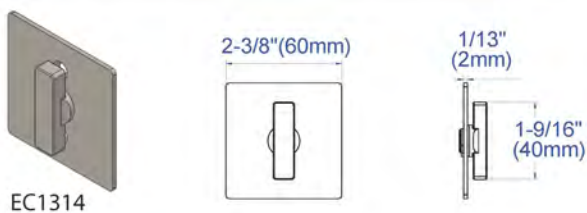
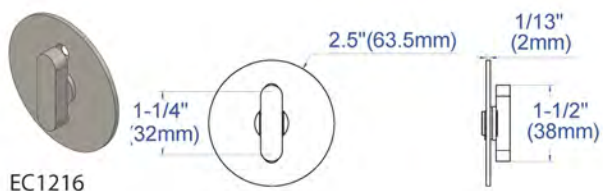



## BD4000 Privacy Lock

### Concealed Trim

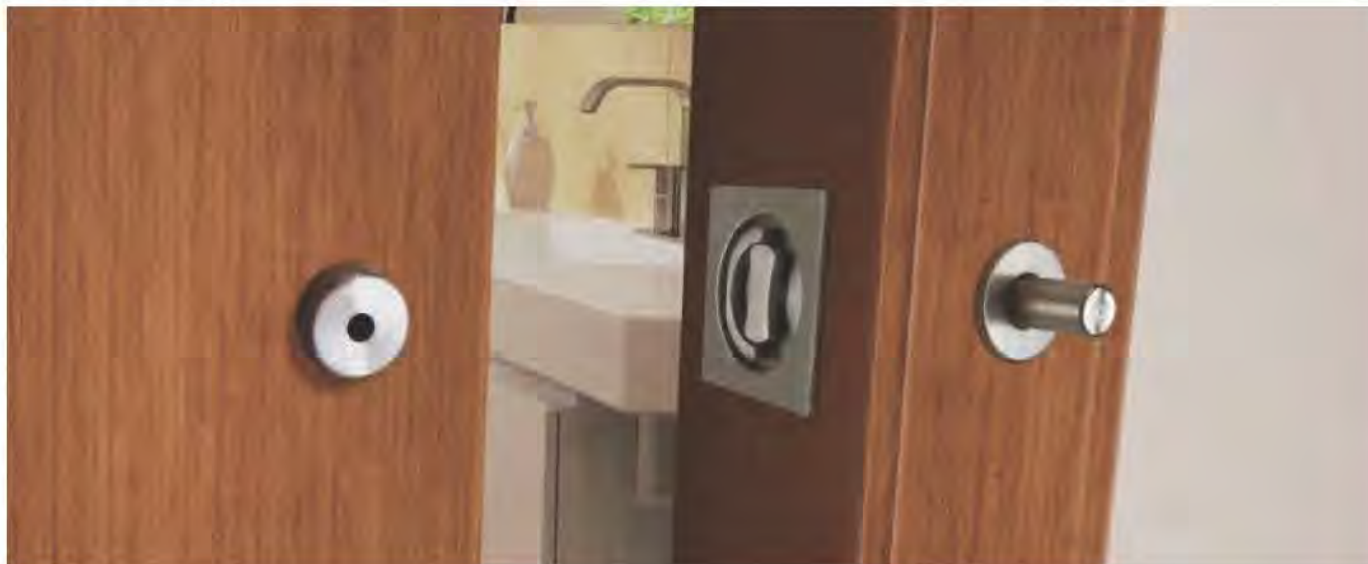

#### Concealed Trim

- No visible screws or fasteners
- Two beautiful contemporary designs
- Six designer finishes and four ceramic finishes
- Smooth Stainless Steel thumbturn, flush against wall
- Minimalist emergency release



FH22CF



FH23CF

#### Thick Door Kit for Doors 2" and up

2" (51.8mm)~  
3" (76.2mm)



- Available for doors up to 3" thick
- Includes extended screw and extended release
- For thicker doors, please contact an INOX sales representative

#### Optional Face Plate



- Available in Satin Nickel, Satin Bronze, and Black
- Protects wall from possible damage
- INOX Laser Art designs available
- Order **BD-FPC**

#### Spacer Ring

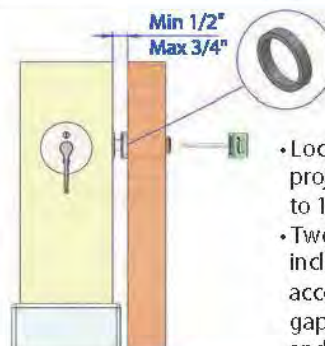

- Lock Bolt has 1" projection and allows up to 1/2" door to wall gap
- Two extra spacer rings included will accommodate up to 3/4" gap between barn door and wall

## BD4000 Privacy Lock Installation with Metal Studs in Jamb



### Installation Options



A. (above) requires a 2-1/8" bore through first stud to allow installation on second stud. For B. and C. (below), install bracket on first stud.

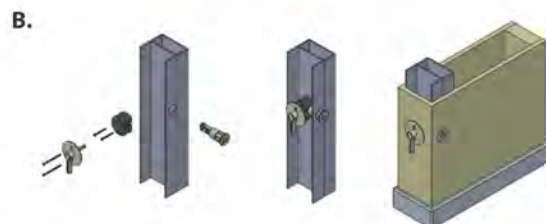

D. requires a special bracket that is only compatible with the rectangular trim shown. This prep requires a 2-1/4" bore on the first stud to allow bracket installation.

### Features

- Can be installed with various stud orientations (as shown below); see [www.inoxproducts.com/resources/How-To-Videos/](http://www.inoxproducts.com/resources/How-To-Videos/) for installation demonstrations
- Most installations require no additional brackets or tools
- Additional bracket available for exception (Figure D)
- Available with ADA compliant thumbturns
- Ten beautiful finishes to complement and enhance any décor
- Can retrofit onto existing doors and jambs

### Orientation of Metal Studs

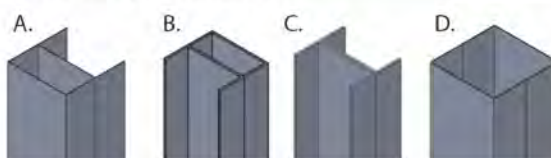

- A. Overlapping - flat surface toward jamb
- B. Overlapping - flat surface away from jamb
- C. Studs back to back
- D. Studs form box (special bracket needed)

Standard bracket for installations A, B, and C, shown with EC1217 Rose and Thumbturn

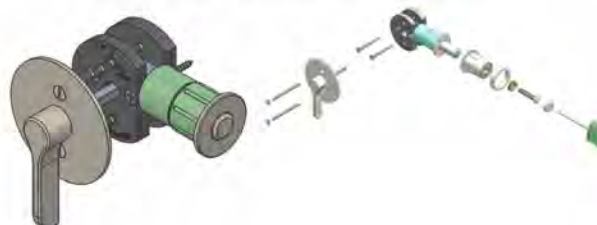

Special bracket, faceplate, and exploded diagram of lock for installation D, shown with TT17 Thumbturn

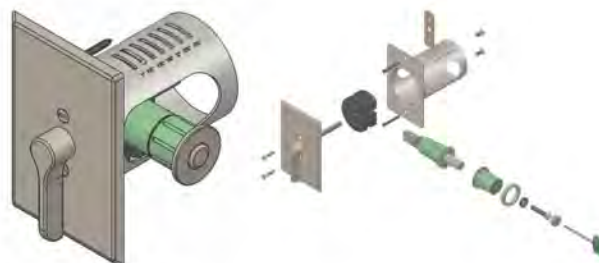

• Order **BD-BRIX-MS**



## BD1000 Privacy Lock Surface Mounted

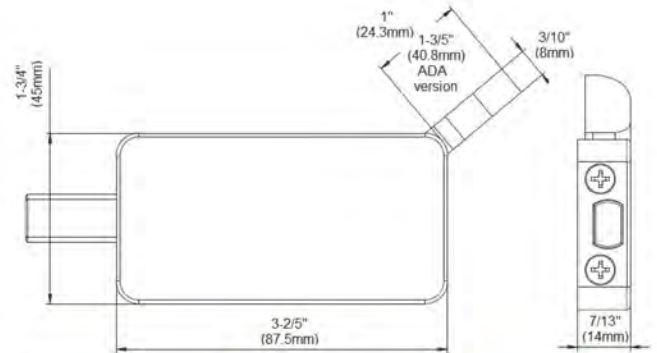

See [www.inoxproducts.com/resources/How-To-Videos/](http://www.inoxproducts.com/resources/How-To-Videos/) for installation instructions.

### Application

- Simple, easy to install surface-mounted privacy lock for barn door openings
- Either residential or commercial application
- Field reversible thumb-lever (TT22), and ADA thumb-lever (TT23) available

### Installation

- Discrete screw fixing to jamb; no need to drill drywall or studs or harm decorative molding
- Dust-proof strike installed in the barn door
- Release button with decorative cap installed on outside of door for emergency release
- Minimum 1" door overlap required

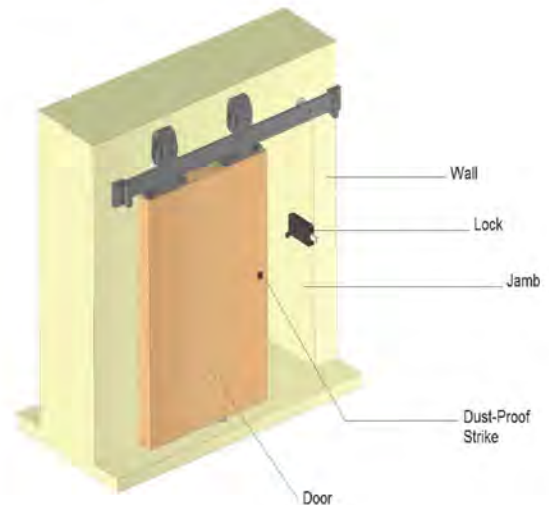

### Lock

- Small, visually discrete 3-2/5" x 1-3/4" x 7/13" Lock Case
- Standard Thumb-lever: 1" (order BD1022)
- Also available with ADA Thumb-lever: 1-3/5" (order BD1023)

### Finishes

- US32 (629) Bright Stainless Steel
- US32D (630) Satin Stainless Steel
- US10B (613) Oil Rubbed Bronze
- 19G - Graphite Black
- PVD4 - Satin Brass

**BD1022**  
Standard 1"  
Thumb-lever



**BD1023**  
ADA 1-3/5"  
Thumb-lever



## BD4000 Privacy Lock Pull Options

### Flush Pull Options for Barn Doors

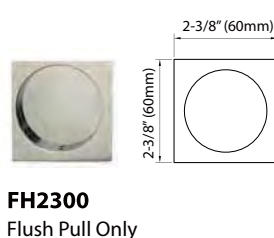
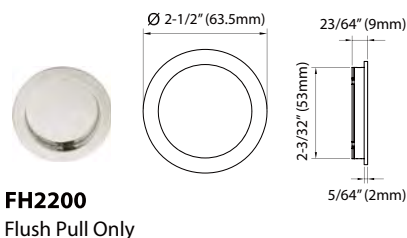
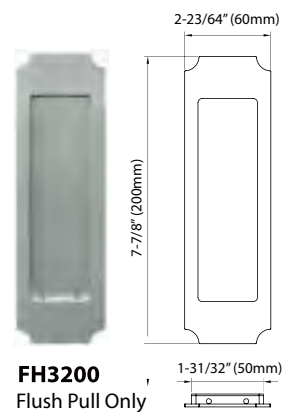
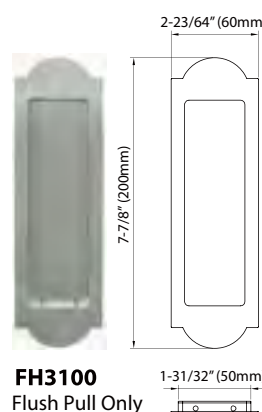
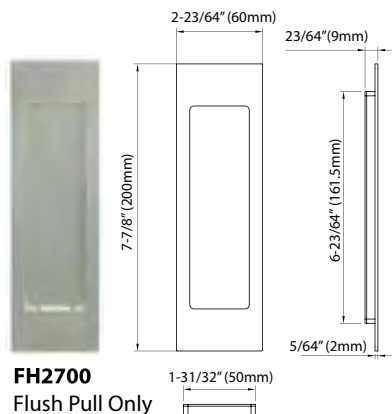

**Finishes:**  
US3 (605) Bright Brass  
US4 (606) Satin Brass  
US7 (608) French Antique  
US10B (613) Oil Rubbed Bronze  
19G Graphite Black

US14 (618) Polished Nickel  
US15 (619) Satin Nickel  
US26D (626) Satin Chrome  
US32 (629) Bright Stainless Steel  
US32D (630) Satin Stainless Steel  
38 - Aged Brass

Please contact Sales Dept. for trim x finish availability.

### ADA Surface Pull Options

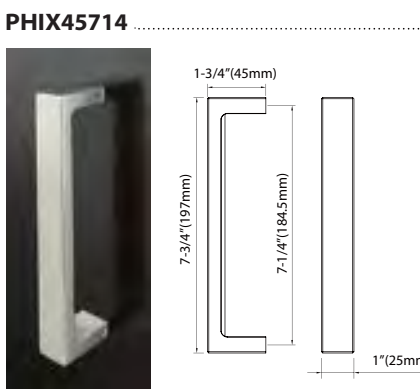
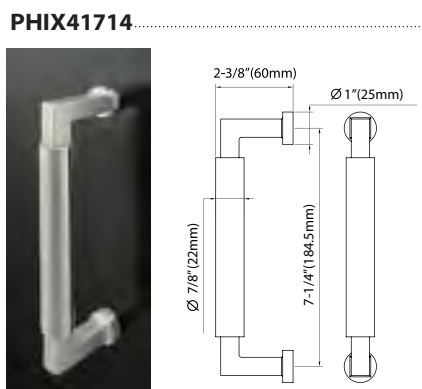
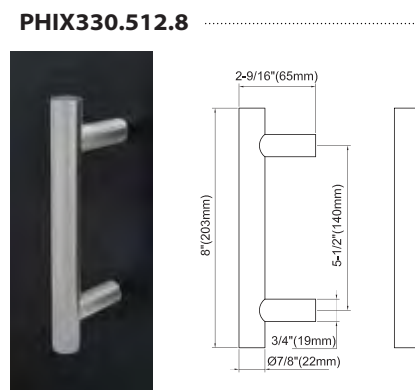
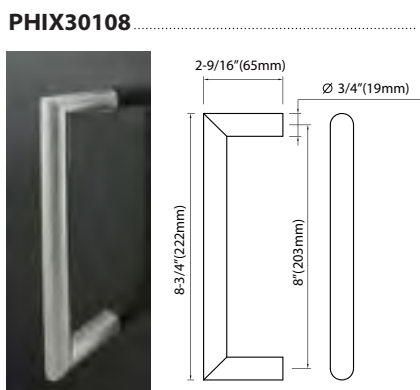
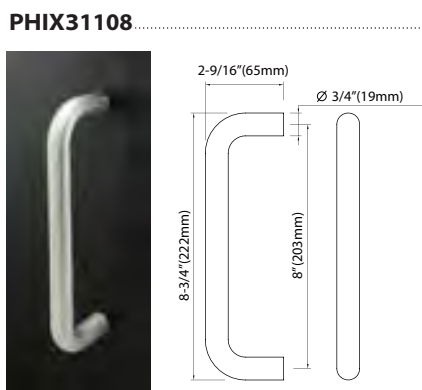

#### Standard Finishes:

US32 (629) Bright Stainless Steel  
US32D (630) Satin Stainless Steel  
US10B (613) Oil Rubbed Bronze - PHIX45714 only  
SP (Split 32/32D) - PHIX41714 only





## Flush Cups

### Dummy/Passage Only

#### Specifications

Stainless Steel, Concealed Fixing, Screws Included  
Dummy/Passage Functions only

#### FHIX01

US32, US32D, US10B, US4

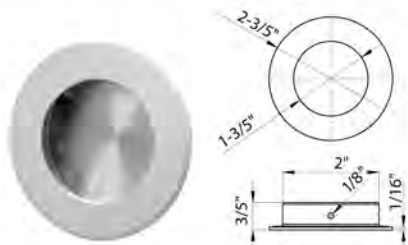

#### FHIX02

US32, US32D, US4

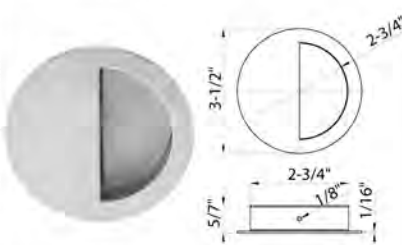

#### FHIX03

US32, US32D, US4

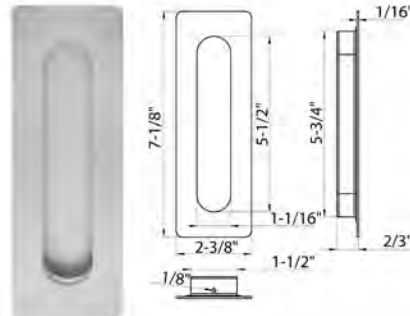

#### FHIX04

US32, US32D, US4

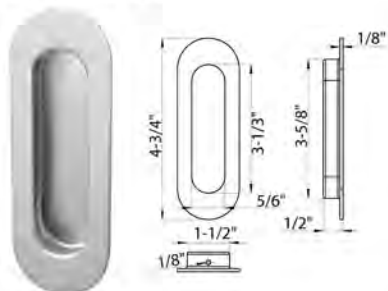

#### FHIX05

US32, US32D, US10B, US4

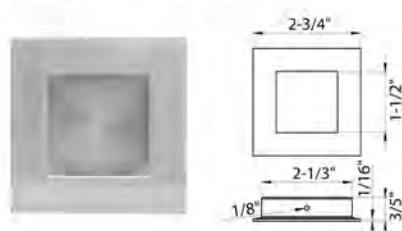

#### FHIX06

US32, US32D, US10B, US4

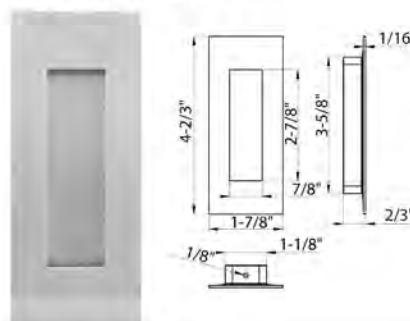

#### FHIX07

US32, US32D, US4

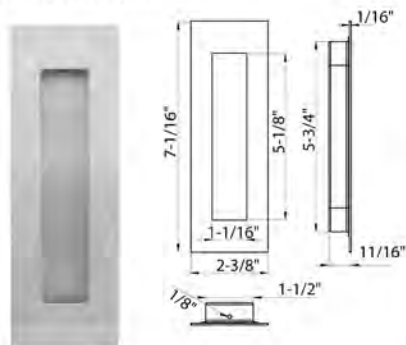

#### EPIX01

##### Edge Pull

US32, US32D, US10B, US4

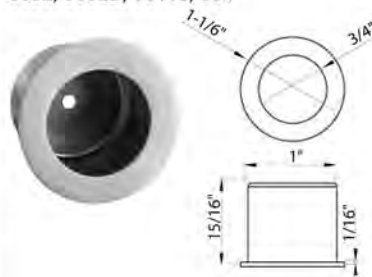

#### Finishes

US32 (629) Bright Stainless Steel  
US32D (630) Satin Stainless Steel  
US10B (613) Oil Rubbed Bronze  
US4 (606) Satin Brass

##### Ceramic Coating:

- C19G Graphite Black
- C19 Flat Black
- CGY Stormy Grey
- CDB Dark Bronze



## PD5000 & PD8000 Mortise Locks





## PD5000 & PD8000 Mortise Locks with Surface Pulls for Sliding Doors



PD8000 with PHIX41714 ADA Pull



PD8000 with PHIX330.512.8 ADA Pull

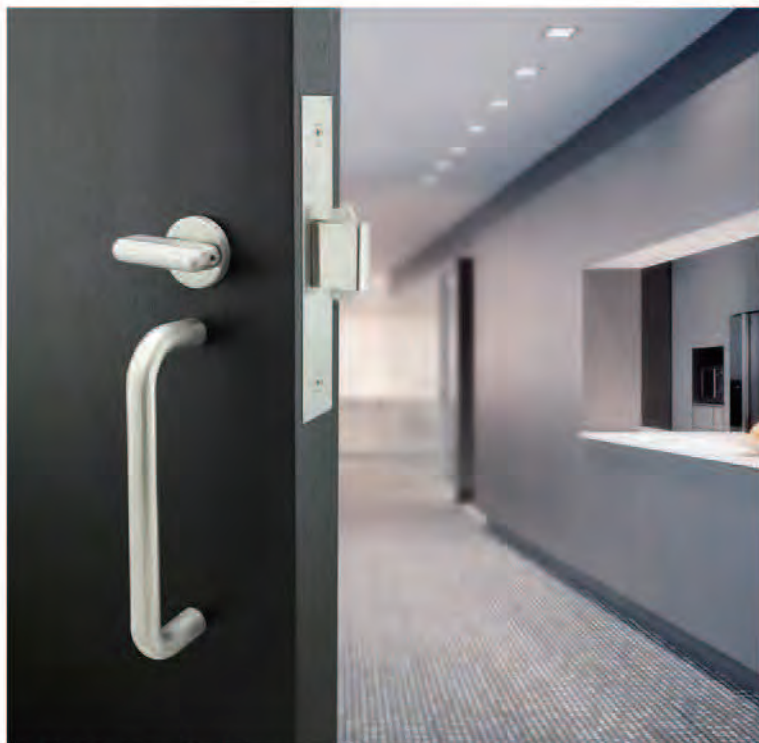

PD5000 with PHIX31108 ADA Pull



PD5000 with PHIX45714 ADA Pull

### PD5000 Series Mortise Lock

#### PD53 : Lockcase with Deadbolt, NO Edge Pull

Available in 3 backsets: 2", 2-1/2", and 2-3/4"

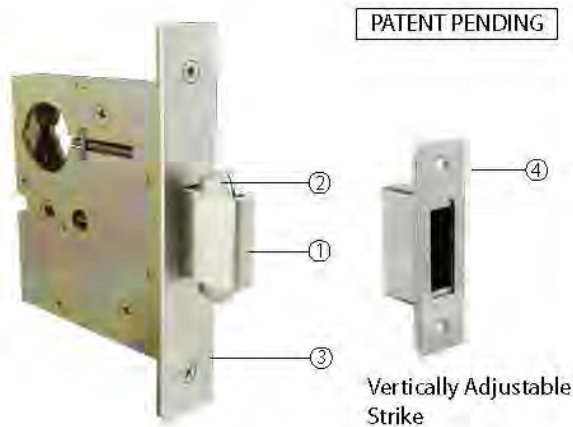

- 1) Brass deadbolt with 1" throw (for 2-1/2" or 2-3/4" backset locks) or 3/4" throw (for 2" backset lock)
- 2) Self-retracting hook with non-marring latch bolt
- 3) Stainless steel or brass faceplate, 2mm thick
- 4) Vertically adjustable strike (shown); optional 2D Adjustable Strike available (PD-ADJ-2D-STRK) - see page 25

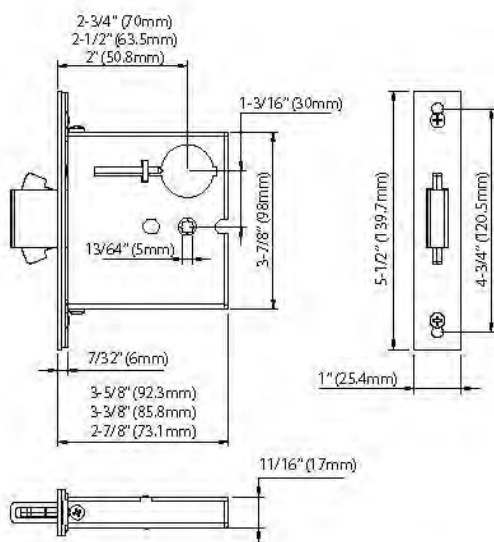

### PD8000 Series Mortise Lock

#### PD84 : Lockcase with Deadbolt and Edge Pull

Available in 3 backsets: 2", 2-1/2", and 2-3/4"

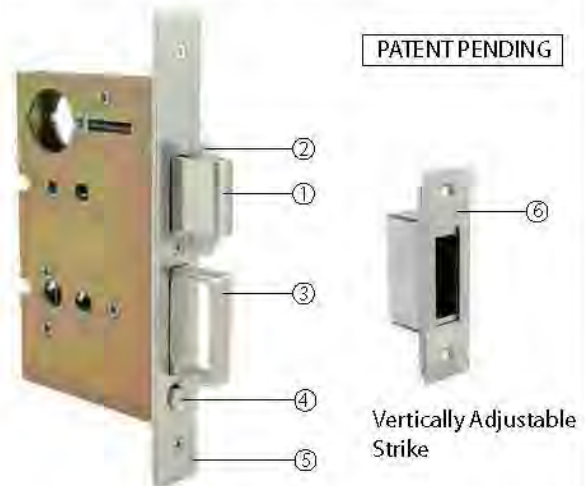

- 1) Brass deadbolt with 1" throw (for 2-1/2" or 2-3/4" backset locks) or 3/4" throw (for 2" backset lock)
- 2) Self-retracting hook with non-marring latch bolt
- 3) Spring-loaded edge pull with unique internal sound buffer
- 4) Solid brass push button to activate edge pull
- 5) Stainless steel or brass faceplate, 2mm thick
- 6) Vertically adjustable strike (shown); optional 2D Adjustable Strike available (PD-ADJ-2D-STRK) - see page 25

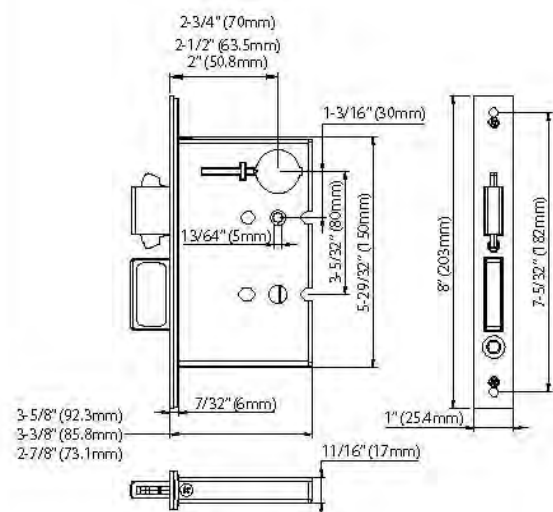



## PD8000/PD5000 Mortise Locks with ADA Surface Pulls for Sliding Doors

### How to Order

#### 1. Select Lock Case

PD5000 Series (See page 16):

PD5215 = Inactive - Passage with built-in Dust Proof Strike for inactive pair door. No edge pull

PD5340 = Privacy with Thumbturn and release. No edge pull

PD5350 = Entry with Single Cylinder and Thumbturn. No edge pull

PD5360 = Patio with Thumbturn only. No edge pull

PD8000 Series (See page 18):

PD8215 = Inactive - Passage with built-in Dust Proof Strike for inactive pair door. No edge pull

PD8340 = Privacy with Thumbturn and release. No edge pull.

PD8350 = Entry with Single Cylinder and Thumbturn. No edge pull.

PD8360 = Patio with Thumbturn only. No edge pull.

Stipulate Backset:

BLANK = 2-3/4"

A = 2-1/2"

B = 2"

(e.g., PD8215-A is a PD8215 lock with 2-1/2" backset)

#### 2. Select ADA Compliant Pull

ADA Pulls (See page 21):

PHIX30108 = C-Shaped (Dia. 3/4") 8" CTC

PHIX31108 = U-Shaped (Dia. 3/4") 8" CTC

PHIX330.512.8 = T-Shaped (Dia. 7/8") 5-1/2" CTC

PHIX41714 = NY New York (Dia. 1") 7-1/4" CTC

PHIX45714 = MH Manhattan (1" x 1/2") 7-1/4" CTC

#### 3. Select Thumbturn

ADA Thumbturn (See page 24):

EC-R460TT07 = Thumbturn on escutcheon only

EC-R460PVS-ADA = Thumbturn & Emergency Release

#### 3. Select Cylinder (for Entry Function)

Mortise Cylinders (See page 23):

CMB0345 = 15/16" for 1-3/4" door (standard)

CMB105 = 1" for 2" door

CMB1186 = 1-1/8" for 2-1/4" door

CMB1146 = 1-1/4" for 2-1/2" door

## PD5000 Sliding & Pocket Door Locks

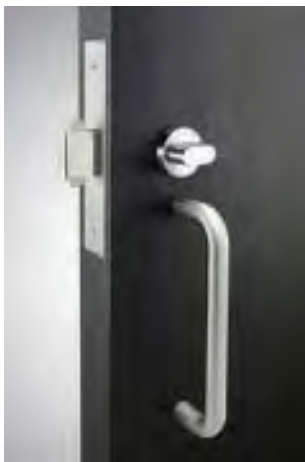

Sliding Door



Pocket Door

### Specifications

- Standard door thickness: 1-3/4" (45mm). Thick Door Kits available
- For 1-3/8" (35mm) thick pocket doors, use FH27SL, FH22CF, or FH23CF flush pull options
- Backset options:
  - PD50: 2" or 2-1/2" / 2-3/4" (fits both)
  - PD52: 2-1/2" / 2-3/4" (fits both)
  - PD53: 2" (51mm), 2-1/2" (64.5mm), or 2-3/4" (70mm)
- Handing: Non-Handed
- Thumbturn Spindle: 5x5mm square
- Deadbolt: 1" (25.4mm)
- Cylinder: Schlage C keyway 5 pin mortise cylinder with 2 keys (KD). Keying Services available; order separately

### Lock Options



**PD50** (2-1/2" / 2-3/4" Backset)  
**PD50B** (2" Backset)  
 Lock Case with Edge Pull



**PD52** (2-1/2" / 2-3/4" Backset)  
 Lockcase with built-in Dust Proof Strike for inactive pair of doors  
 NO Edge Pull



**PD53** (2-3/4" Backset)  
**PD53A** (2-1/2" Backset)  
**PD53B** (2" Backset)  
 Lockcase with Deadbolt  
 NO Edge Pull, less Cylinder

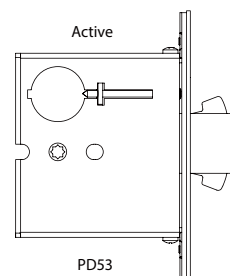

PD53

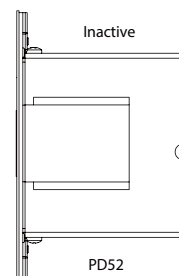

PD52

### Application

For residential or commercial application

### Material

Lockcase: Heavy Gauge Steel  
 Deadbolt and Edge Pull: Brass and Stainless Steel  
 Faceplate and Strike: Stainless Steel  
 Cylinder: Solid Brass

### Trim

Please see pages 21-22 for Surface Pull design options  
 Please see pages 28-34 for Flush Pull design options  
 ADA compliance information: page 20

### Finish

#### Lock and Surface Pulls for Sliding Doors:

US32 (629) Bright Stainless Steel  
 US32D (630) Satin Stainless Steel  
 SP Split US32/US32D - PHIX41714 only  
 US10B (613) Oil Rubbed Bronze - PHIX45714 only  
 Ceramic Coating (Inquire about lead time and pricing)

- C19G Ceramic Graphite Black
- C19 Ceramic Flat Black
- CGY Ceramic Stormy Grey
- CDB Ceramic Dark Bronze

#### Lock and Flush Pulls for Pocket Doors:

See pages 35 for all Finish options



## PD8000/PD5000 Mortise Locks with Flush Pulls for Pocket Door

### How to Order

1. Specify/Order Flush Pull Locksets using complete codes as below:

#### Product Identification

**FH27 PD8450 -B -TT09 -32D**

#### Finish:

US3 (605) Bright Brass - Lifetime PVD  
 US4 (606) Satin Brass - Lifetime PVD  
 US7 (608) French Antique  
 US10B (613) Oil Rubbed Bronze  
 19G Graphite Black  
 US14 (618) Polished Nickel (Brass) - Lifetime PVD  
 US15 (619) Satin Nickel (Brass)  
 US26 (625) Polished Chrome (Brass)  
 US26D (626) Satin Chrome (Brass)  
 US32 (629) Bright Stainless Steel - Lifetime  
 US32D (630) Satin Stainless Steel - Lifetime  
 38 - Aged Brass

#### Ceramic Coating:

C19G - Ceramic Graphite Black  
 C19 - Ceramic Flat Black  
 CGY - Ceramic Stormy Grey  
 CDB - Ceramic Dark Bronze

Please see inside front cover and pg. 35 for Finish options and additional information

#### Thumbturn:

Blank = Privacy w/TT08 Thumbturn  
 -TT09 = Privacy w/TT09 Thumbturn (for FH27/29/31/32 Flush Pull only)

#### Backset:

-BLANK = 2-3/4"  
 -A = 2-1/2"  
 -B = 2"

#### Function:

PD8010 = Passage used as Flush Pull or matching trim on pair of doors. Push button activates edge pull  
 PD8115 = Passage used as Dust Proof Strike on inactive side of pair of doors; push button activates edge pull  
 PD8440 = Privacy with Thumbturn and Release. Push button activates edge pull  
 PD8450 = Entry with Single Cylinder and Thumb-turn. Push button activates edge pull  
 PD8460 = Patio with Thumbturn only. Push button activates edge pull  
 PD5010 = Passage used as Flush Pull or matching trim on pair of doors. Push button activates edge pull  
 DP = Dummy/Passage. No lock case edge pull

**Note:** PD8115, PD8450, PD5010 are not suitable for 27SL, 22CF, 23CF Slim Trim

#### Flush Pull Design:

**NOTE:** Doors 1-3/4" or thicker: Order any Flush Pull

**Doors 1-3/8" = Order FH27SL, FH22CF or FH23CF ONLY** (See pages 28 and 34)

FH27 = Linear series  
 FH27SL = Linear Slim Trim for 1-3/8" thick door  
 FH29 = Arc series  
 FH31 = Regal series  
 FH32 = Crown series  
 FH22 = Luna series  
 FH23 = Urban series

#### Concealed Fixing

FH22CF = Luna for 1-3/8" and thicker door  
 FH23CF = Urban for 1-3/8" and thicker door

## FH23 Urban Flush Pull

For PD8000/PD5000 Sliding & Pocket Door Locks



FH23 w/PD84



FH23 w/PD50

### FH23

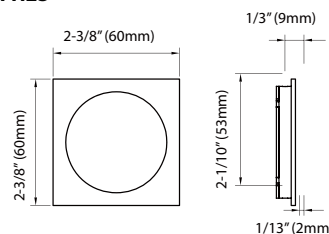

#### Specifications

- Standard Door Thickness: 1-3/4" (45mm)  
Thick door kits available
- 1-3/8" Door Thickness: Use FH23CF
- Handing: Non-Handed
- Thumbturn Spindle: 5x5mm square
- Deadbolt: 1" (25.4mm)
- Cylinder: Schlage C keyway 5 pin mortise cylinder with 2 keys (KD). Keying services available; order separately

#### Application

For residential, hospitality or commercial application

#### Material

Stainless Steel/Brass

#### Finish

See page 35 for Finish options.

#### Trim Options

**Note: FH23 Urban Trim cannot be installed on 1-3/8" doors. For 1-3/8" thick doors, order FH23CF (see page 34).**

#### Standard FH23 Urban Trim for doors 1-3/4"



**FH2300**  
Flush Pull Only



**FH2303**  
Flush Pull with  
Cylinder Hole

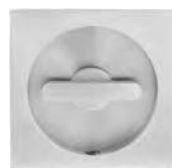
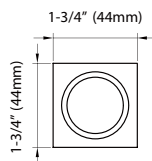

**FH2382**  
Flush Pull with  
TT08 Thumbturn



**FH2304**  
Flush Pull with  
Thumbturn Release



## PD9000 Series Mortise Lock with Emergency Egress

### PD95: Lockcase with Deadbolt

Available in 2 backsets: 2-1/2" and 2-3/4"

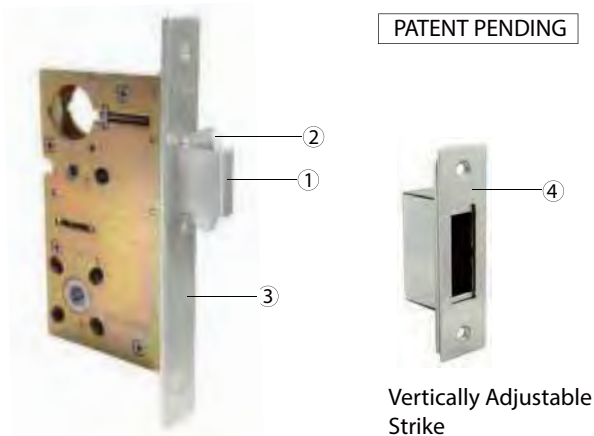

- 1) Brass deadbolt with 1" throw
- 2) Self-retracting hook with non-marring latch bolt
- 3) Stainless steel or brass faceplate, 2mm thick
- 4) Vertically adjustable strike

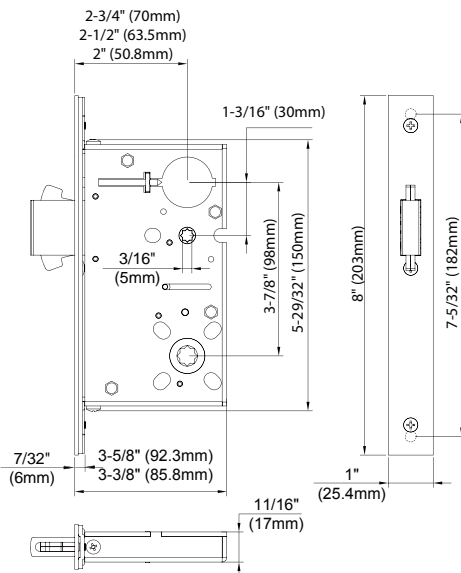

## PD9000 Series Mortise Auto-Lock with Emergency Egress

### COMING SOON!

### PD96: Lockcase with Deadbolt

Will be available in 2 backsets: 2-1/2" and 2-3/4"

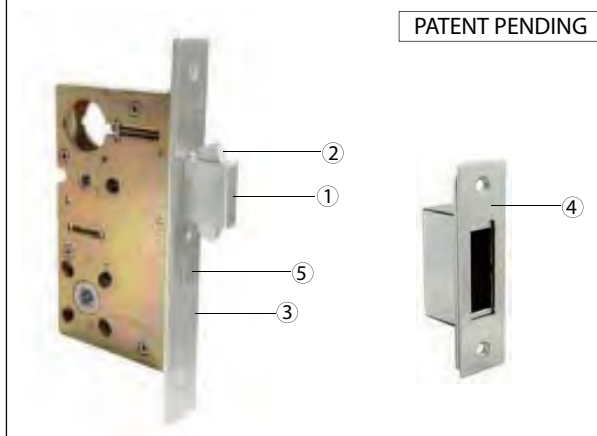

- 1) Brass deadbolt with 1" throw
- 2) Self-retracting hook with non-marring latch bolt
- 3) Stainless steel or brass faceplate, 2mm thick
- 4) Vertically adjustable strike
- 5) Auto Lock activation

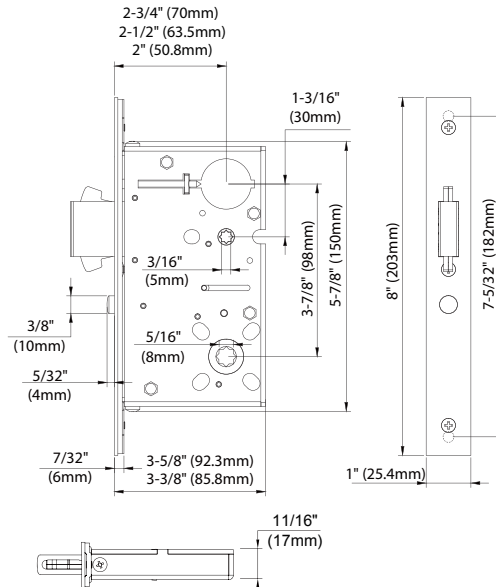

COMING SOON

## PD95 Mortise Locks with X Series Trim for Sliding Doors



**PD95 with XGT202**



**PD95 with XGT243**



**PD95 with XGT345**





**PD95 with XGS205**

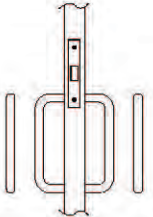
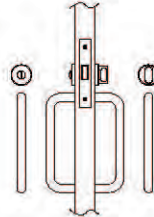
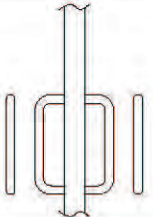
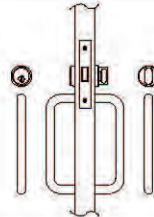

## Functions

## Sliding Doors

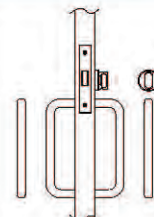
	<p><b>PD5215</b>  <b>Passage w/Lockcase as Dust Proof Strike</b>          Lockcase used as dust proof strike on pair of doors inactive side.</p>		<p><b>PD5340</b>  <b>Privacy w/Emergency Release</b>          Deadbolt operated by inside Thumbturn or outside emergency release coin turn.</p>
	<p><b>BTB</b>  <b>Dummy/Passage without Lock Case</b></p>		<p><b>PD5350</b>  <b>Entry w/Single Cylinder</b>          Key outside or Thumbturn inside retracts deadbolt.</p>
			<p><b>PD5360</b>  <b>Patio</b>          Deadbolt operated by Thumbturn from inside only.</p>

## Functions

## Pocket Doors

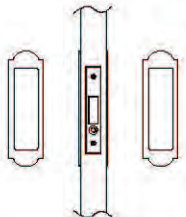
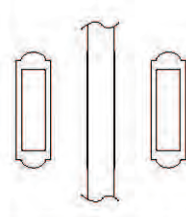
	<p><b>PD5010</b>  <b>Passage w/ Lockcase</b>          Used as flush pull or matching trim on pairs of doors.          Edge finger pull operated by the push button.</p>		<p><b>DP</b>  <b>Dummy/Passage without Lock Case</b></p>
---	---	--	--

## PD8000 Sliding & Pocket Door Locks



Sliding Door



Pocket Door

### Specifications

- Standard door thickness: 1-3/4" (45mm). Thick Door Kits available
- 1-3/8" (35mm) thick pocket doors, use FH27SL, FH22CF, or FH23CF options
- Backset options:
  - PD80/83/84: 2" (51mm), 2-1/2" (64.5mm), or 2-3/4" (70mm)
  - PD81/82: 2" or 2-1/2" / 2-3/4" (fits both)
- Handing: Non-Handed
- Thumbturn Spindle: 5x5mm square
- Deadbolt: 1" (25.4mm)
- Cylinder: Schlage C keyway 5 pin mortise cylinder with 2 keys (KD). Keying Services available; order separately.

### Application

For residential or commercial application

### Material

Lockcase: Heavy Gauge Steel  
 Deadbolt and Edge Pull: Brass and Stainless Steel  
 Faceplate and Strike: Stainless Steel  
 Cylinder: Solid Brass

### Trim

Please see pages 21-22 for Surface Pull design options  
 Please see pages 28-34 for Flush Pull design options  
 ADA compliance information: page 20

### Finish

Locks and Surface Pulls:  
 US32 (629) Bright Stainless Steel  
 US32D (630) Satin Stainless Steel  
 SP Split US32/US32D - PHIX41714 only  
 US10B (613) Oil Rubbed Bronze on PHIX45714 pull only  
 Ceramic Coating (Inquire about lead time and pricing)

- C19G Ceramic Graphite Black
- C19 Ceramic Flat Black
- CGY Ceramic Stormy Grey
- CDB Ceramic Dark Bronze

Locks and Flush Pulls:  
 See pages 35 for all Finish options

### Lock Options



**PD80** (2-3/4" Backset)  
 Lockcase with Edge Pull  
 No Deadbolt  
 Less Cylinder



**PD81** (2-3/4" Backset)  
 Lockcase with built-in  
 Edge Pull and Dust Proof  
 Strike for inactive pair door



**PD82** (2-3/4" Backset)  
**PD82A** (2-1/2" Backset)  
**PD82B** (2" Backset)  
 Lockcase with built-in Dust  
 Proof Strike for an inactive  
 pair door  
 NO Edge Pull



**PD83-234** (2-3/4" Backset)  
**PD83A** (2-1/2" Backset)  
**PD83B** (2" Backset)  
 Lockcase with Deadbolt  
 NO Edge Pull  
 Less Cylinder





**PD84** (2-3/4" Backset)  
**PD84A** (2-1/2" Backset)  
**PD84B** (2-3/4" Backset)  
 Lockcase with Deadbolt  
 and Edge Pull





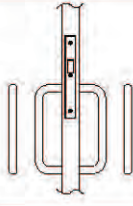
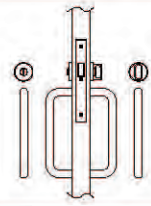
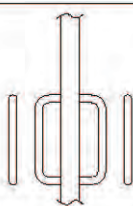
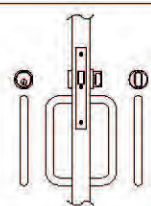

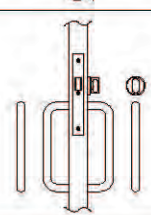

## Functions

### Sliding Door

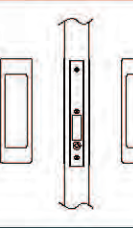
	<p><b>PD8215</b> <b>Passage w/Lockcase as Dust Proof Strike</b> Lockcase used as dust proof strike on pair of doors inactive side.</p>		<p><b>PD8340</b> <b>Privacy w/Emergency Release</b> Deadbolt operated by inside Thumbturn or outside emergency release coin turn.</p>
	<p><b>BTB</b> <b>Dummy/Passage without Lock Case</b></p>		<p><b>PD8350</b> <b>Entry w/Single Cylinder</b> Key outside or Thumbturn inside retracts deadbolt.</p>
			<p><b>PD8360</b> <b>Patio</b> Deadbolt operated by Thumbturn from inside only.</p>

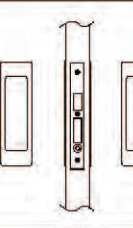
## Functions

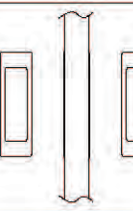
### Pocket Door

	<p><b>PD8010</b> <b>Passage with Lockcase</b> Used as flush pull or matching trim on pairs of doors. Edge finger pull operated by the push button.</p>		<p><b>PD8440</b> <b>Privacy with Emergency Release</b> Deadbolt operated by inside thumbturn or outside emergency release coin turn. <b>Edge finger pull operated by the push button.</b></p>
	<p><b>PD8115</b> <b>Passage with Lockcase as Dust Proof Strike</b> Lockcase used as dust proof strike on pair of doors inactive side. <b>Edge finger pull operated by the push button.</b></p>		<p><b>PD8450</b> <b>Entry with Single Cylinder</b> Key outside or Thumbturn inside retracts deadbolt with hook. <b>Edge finger pull operated by the push button.</b></p>
	<p><b>DP</b> <b>Dummy/Passage without Lock Case</b></p>		<p><b>PD8460</b> <b>Patio</b> Deadbolt operated by Thumbturn from inside only. <b>Edge finger pull operated by the push button.</b></p>

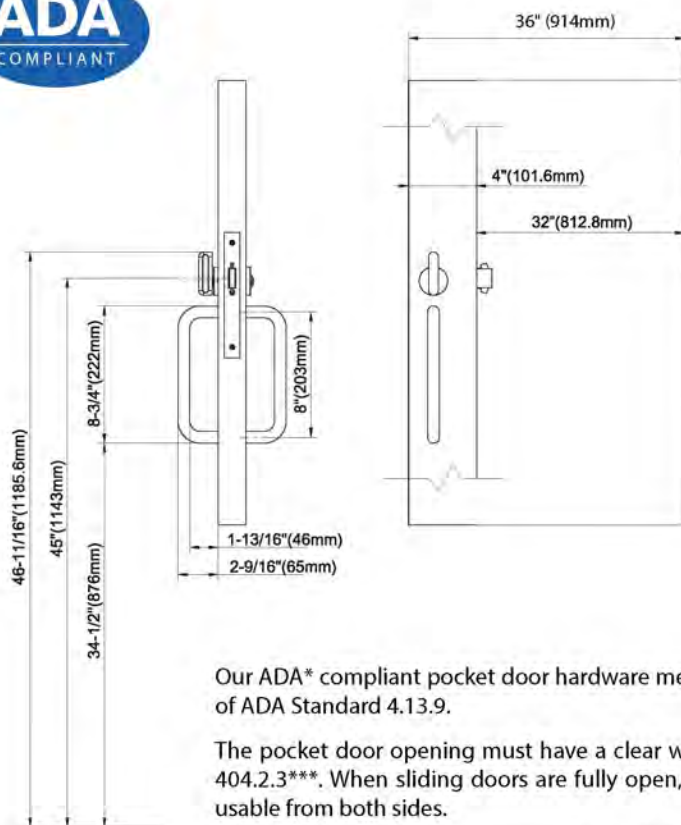

**Americans with Disabilities Act (ADA) Compliance**

Our ADA\* compliant pocket door hardware meets the "no grasp", "no pinch" requirements of ADA Standard 4.13.9.

The pocket door opening must have a clear width of 32" according to the ADA Standard 404.2.3\*\*\*. When sliding doors are fully open, operating hardware shall be exposed and usable from both sides.

To accommodate these requirements, the total pocket door opening must be a MINIMUM of 36". The door must protrude a minimum of 4" from the jamb in order to install the ADA pocket door hardware on the door.

The hardware must be installed 34" above the finished floor or ground, giving the hardware a height of 47" (the maximum is 48") from the finished floor, meeting ADA Standard 404.2.7\*\*\*.

**\* Americans with Disabilities Act**

**\*\*\* The ADA Standard 404.2.3 is from the Department of Justice ADA Publication dated September 15, 2012. INOX recommends the end user double check all State and Federal standards for your particular project.**

## ADA Compliant Stainless Steel Surface Pulls

## PHIX31108

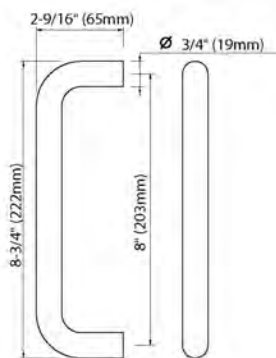

## All Pulls are also available in Ceramic Coating:

- C19G Ceramic Graphite Black
- C19 Ceramic Flat Black
- CGY Ceramic Stormy Grey
- CDB Ceramic Dark Bronze

- US32 (629) Bright Stainless Steel
- US32D (630) Satin Stainless Steel

## PHIX45714

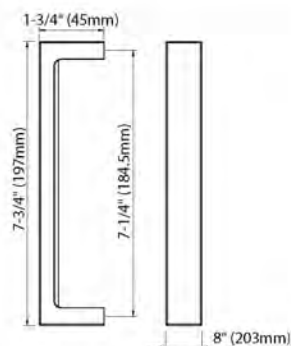

- US32 (629) Bright Stainless Steel
- US32D (630) Satin Stainless Steel
- US10B (613) Oil Rubbed Bronze

## PHIX30108

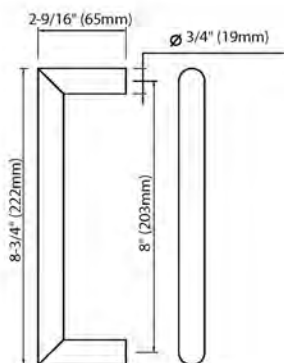

- US32 (629) Bright Stainless Steel
- US32D (630) Satin Stainless Steel

## PHIX41714

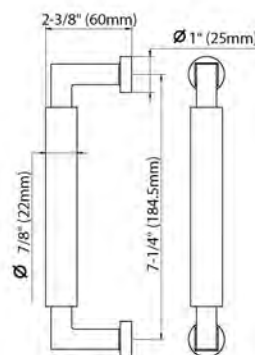

- US32 (629) Bright Stainless Steel
- US32D (630) Satin Stainless Steel
- SP (Split 32/32D)

## PHIX330.512.8

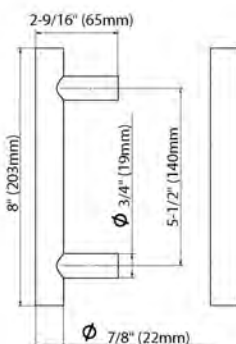

- US32 (629) Bright Stainless Steel
- US32D (630) Satin Stainless Steel

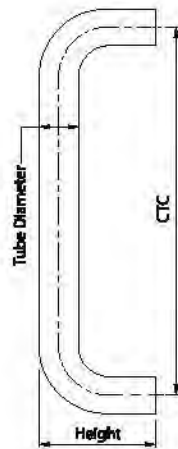
**Other Surface Pulls**
**U-Shape Pull**

CTC	Overall	Projection	Item Number
<i>Tube Diameter: Dia. 3/4"</i>			
6"	6-3/4"	2-3/4"	PHIX31106
8"	8-3/4"	2-3/4"	PHIX31108
10"	10-3/4"	2-3/4"	PHIX31110
12"	12-3/4"	2-3/4"	PHIX31112
<i>Tube Diameter: Dia. 1"</i>			
10"	11"	3"	PHIX31210
12"	13"	3"	PHIX31212
<i>Tube Diameter: Dia. 1-1/4"</i>			
12"	13-1/4"	3-1/4"	PHIX31312
18"	19-1/4"	3-1/4"	PHIX31318

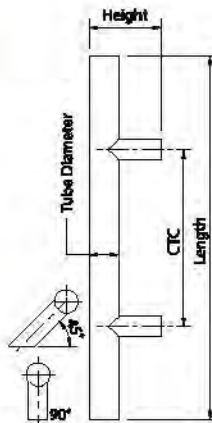
**T-Shape Pull**

CTC	Overall	Projection	Degree	Item Number
<i>Tube Diameter: Dia. 7/8"</i>				
5-1/2"	8"	2.5"	45°	PHIX330.51.8
<i>Tube Diameter: Dia. 1-1/4"</i>				
10"	18"	3"	90°	PHIX33310
12"	20"	3"	90°	PHIX33312
18"	26"	3"	90°	PHIX33318
48"	56"	3"	90°	PHIX33348
60"	68"	3"	90°	PHIX33360
72"	80"	3"	90°	PHIX33372
10"	18"	3"	45°	PHIX34310
12"	20"	3"	45°	PHIX34312
18"	26"	3"	45°	PHIX34318

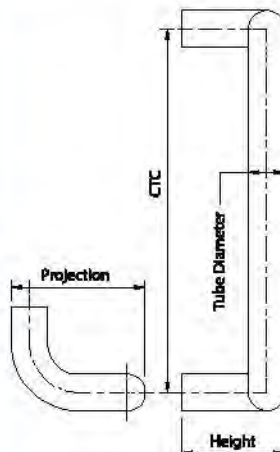
**D-Shape Pull**

CTC	Overall	Projection	Offset	Item Number
<i>Tube Diameter: Dia. 1"</i>				
10"	11"	3-1/4"	4-1/2"	PHIX32210*
12"	13"	3-1/4"	4-1/2"	PHIX32212
<i>Tube Diameter: Dia. 1-1/4"</i>				
12"	13-1/4"	3-1/2"	4-3/4"	PHIX32312
18"	19-1/4"	3-1/2"	4-3/4"	PHIX32318

\*Note: PHIX32210 is only available in 32D (630) Satin Stainless Steel finish

**Finishes:** US32D (630) Satin Stainless Steel  
 US32 (629) Bright Stainless Steel  
 CeraMax™ Ceramic Coating available



## Surface Pull Fixings

\* Bolt-thru = 1 Single pull + 1 Bolt-thru fixing pack (Function Code: BT)

\* Back-to-back = 2 Single pulls + 1 Back-to-back fixing pack (Function Code: BTB)

\* On rosette = 1 Single pull + 1 On-Roses fixing pack (Function Code: OR) \* Only available for U shape pull Dia. 3/4"

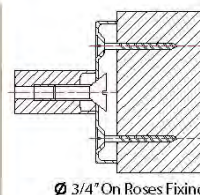
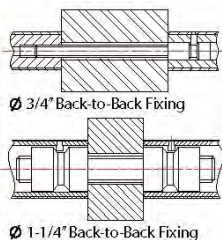
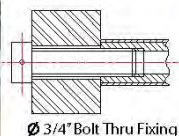

## Mortise Cylinders & Keys

### Mortise Cylinders and Keys

CMB0345 Mortise Cylinder standard for 1-3/4" (44mm) door; Schlage C keyway, 5 pin, with clover cam; includes 2 keys, standard Keyed Different (KD).

Cylinder options:

Item Code	Length	Door Thickness
CMB0345	15/16"	1-3/4"
CMB105	1"	2"
CMB1186	1-1/8"	2-1/4"
CMB1146	1-1/4"	2-1/2"

Other keying services (Keyed Alike, Master Keying, etc.) available.

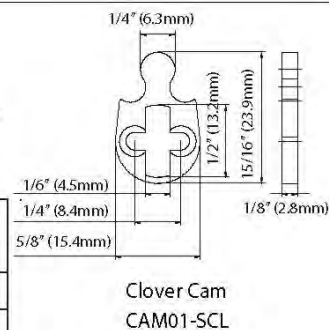
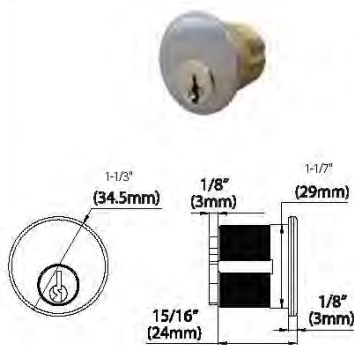

## Cylinder Collar, Thumbturn and Emergency Release Options

### GR02

GR Small Rose  
TT02 Thumbturn and release



**GR Rose**  
T-Turn Side



**GR Rose**  
Release Side

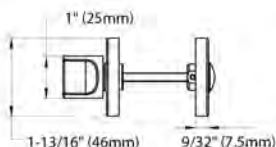

Product Illustration	Function	Item No.
	Mortise cylinder escutcheon	EC-R460COL
	Thumbturn on escutcheon	EC-R460TT02
	Thumbturn & Release	EC-R460TT02PVS

### GR04

GR Small Rose  
TT04 Thumbturn and release



**GR Rose**  
T-Turn Side



**GR Rose**  
Release Side

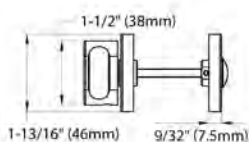

Product Illustration	Function	Item No.
	Mortise cylinder escutcheon	EC-R460COL
	Thumbturn on escutcheon	EC-R460TT04
	Thumbturn & Release	EC-R460TT04PVS

### GR07

GR Small Rose  
TT07 ADA Thumbturn and release



**GR Rose**  
T-Turn Side



**GR Rose**  
Release Side

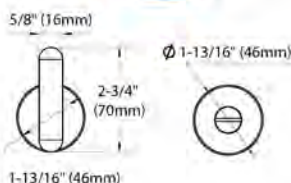

Product Illustration	Function	Item No.
	Mortise cylinder escutcheon	EC-R460COL
	Thumbturn on escutcheon	EC-R460TT07
	Thumbturn & Release	EC-R460PVS-ADA

### SR02

SR Small Rose  
TT04 Thumbturn and release



**SR Rose**  
T-Turn Side



**SR Rose**  
Release Side

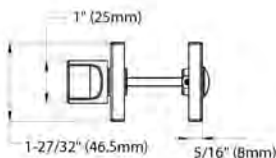

Product Illustration	Function	Item No.
	Mortise cylinder escutcheon	EC-S420COL
	Thumbturn on escutcheon	EC-S420TT02
	Thumbturn & Release	EC-S420TT02PVS

### SR04

SR Small Rose  
TT04 Thumbturn and release



**SR Rose**  
T-Turn Side



**SR Rose**  
Release Side

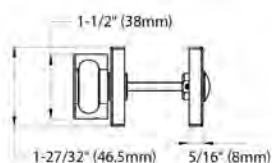

Product Illustration	Function	Item No.
	Mortise cylinder escutcheon	EC-S420COL
	Thumbturn on escutcheon	EC-S420TT04
	Thumbturn & Release	EC-S420TT04PVS



## INOX® Vertically Adjustable and 2D Adjustable Strikes (Patent Pending)



The INOX® Vertically Adjustable Strike offers a distinctive, patent pending construction that allows adjustment of the dust box up to  $\frac{1}{4}$ " vertically.

The optional INOX 2D Adjustable Strike gives the installer the ability to fine-tune the gap between door and frame with a simple adjustment of the built-in strike screws, ensuring a perfect fit.

- Can be adjusted before or after installation
- No modification to the door frame is necessary for adjustment
- Faceplate remains locked in place while the dust point is adjusted
- Once set, our unique slotted system holds the dust box and faceplate rigid for smooth door opening and closing
- With INOX® 2D Adjustable Strike, the strike plate screws pull the lock/door closer to the frame to minimize the gap, or widens the gap up to 3mm between door and frame to allow tolerances for weather stripping. See illustration below
- INOX® Adjustable and 2D Adjustable Strikes ensure perfect fit with easy installation

### Vertically Adjustable Strike PD-ADJ-STRK

Standard with INOX PD8000 & PD5000 Pocket & Sliding Door Locks

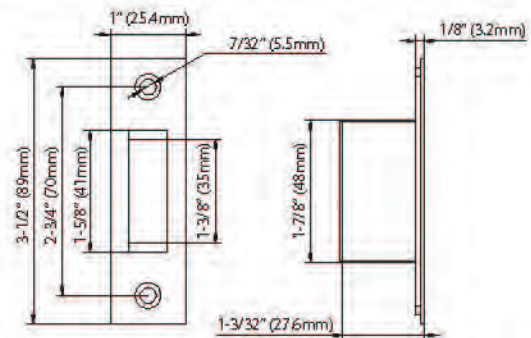
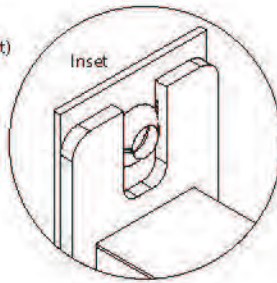
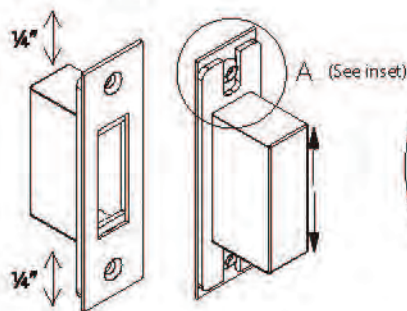

### 2D Adjustable Strike PD-ADJ-2D-STRK

Special Order with INOX PD8000 & PD5000 Pocket & Sliding Door Locks

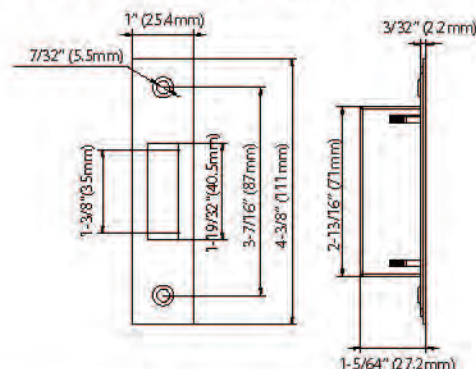
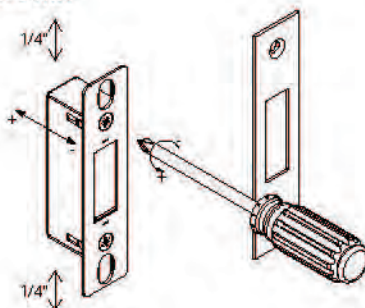



**PD8000 & PD5000 Mortise Locks  
with Flush Pulls for Pocket Doors**



**PD8000 with FH27 Linear Flush Pull**



**PD8000 with FH31 Regal Flush Pull**



**PD5000 with FH22 Luna Flush Pull**



**PD5000 with FH32 Crown Flush Pull**

## PD8000/PD5000 Mortise Locks with Flush Pulls for Pocket Door

### How to Order

1. Specify/Order Flush Pull Locksets using complete codes as below:

#### Product Identification

**FH27 PD8450 -B -TT09 -32D**

##### Finish:

US3 (605) Bright Brass - Lifetime PVD  
 US4 (606) Satin Brass - Lifetime PVD  
 US7 (608) French Antique  
 US10B (613) Oil Rubbed Bronze  
 19G Graphite Black  
 US14 (618) Polished Nickel (Brass) - Lifetime PVD  
 US15 (619) Satin Nickel (Brass)  
 US26 (625) Polished Chrome (Brass)  
 US26D (626) Satin Chrome (Brass)  
 US32 (629) Bright Stainless Steel - Lifetime  
 US32D (630) Satin Stainless Steel - Lifetime  
 38 - Aged Brass

##### Ceramic Coating:

C19G - Ceramic Graphite Black  
 C19 - Ceramic Flat Black  
 CGY - Ceramic Stormy Grey  
 CDB - Ceramic Dark Bronze

Please see inside front cover and pg. 35 for Finish options and additional information

##### Thumbturn:

Blank = Privacy w/TT08 Thumbturn  
 -TT09 = Privacy w/TT09 Thumbturn (for FH27/29/31/32 Flush Pull only)

##### Backset:

-BLANK = 2-3/4"  
 -A = 2-1/2"  
 -B = 2"

##### Function:

PD8010 = Passage used as Flush Pull or matching trim on pair of doors. Push button activates edge pull  
 PD8115 = Passage used as Dust Proof Strike on inactive side of pair of doors; push button activates edge pull  
 PD8440 = Privacy with Thumbturn and Release. Push button activates edge pull  
 PD8450 = Entry with Single Cylinder and Thumb-turn. Push button activates edge pull  
 PD8460 = Patio with Thumbturn only. Push button activates edge pull  
 PD5010 = Passage used as Flush Pull or matching trim on pair of doors. Push button activates edge pull  
 DP = Dummy/Passage. No lock case edge pull

**Note:** PD8115, PD8450, PD5010 are not suitable for 27SL, 22CF, 23CF Slim Trim

##### Flush Pull Design:

**NOTE:** Doors 1-3/4" or thicker: Order any Flush Pull

**Doors 1-3/8" = Order FH27SL, FH22CF or FH23CF ONLY** (See pages 28 and 34)

FH27 = Linear series  
 FH27SL = Linear Slim Trim for 1-3/8" thick door  
 FH29 = Arc series  
 FH31 = Regal series  
 FH32 = Crown series  
 FH22 = Luna series  
 FH23 = Urban series

##### Concealed Fixing

FH22CF = Luna for 1-3/8" and thicker door  
 FH23CF = Urban for 1-3/8" and thicker door



## FH27 Linear Flush Pull

For PD8000/PD5000 Sliding & Pocket Door Locks



FH27 w/PD84



FH27 w/PD50

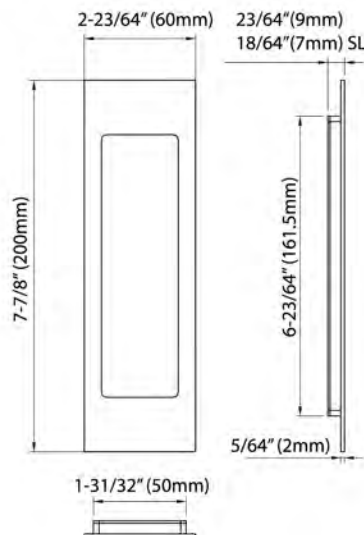

### Specifications

- Standard Door Thickness: 1-3/4" (45mm)  
Thick Door Kits available
- Slim Trim (FH27SL) available for 1-3/8" (35mm) doors
- Handing: Non-Handed
- Thumbturn Spindle: 5x5mm square
- Deadbolt: 1" (25.4mm)
- Cylinder: Schlage C keyway 5 pin mortise cylinder with 2 keys (KD). Keying services available; order separately

### Application

For Residential or Commercial application

### Material

Stainless Steel/Brass

### Options

Trim	Door Thickness	Fixing Type
FH27..	1-3/4" or greater	Discrete
FH27..SL	1-3/8"	Face Fixing



FH27SL\*

### Finish

See page 35 for Finish options.

**Note: Standard FH27 Linear Trim cannot be installed on 1-3/8" doors. For 1-3/8" thick doors, order FH27SL face-fixing Slim Trim. Also available: FH22CF or FH23CF (see page 34).**



**FH2700 FH2700SL**  
Flush Pull Only



**FH2792 FH2792SL**  
Flush Pull w/  
TT09 Thumbturn



**FH2704 FH2704SL**  
Flush Pull w/  
Thumbturn Release



**FH2703\***  
Flush Pull w/  
Cylinder Hole



**FH2782\***  
Flush Pull w/  
TT08 Thumbturn

\* Not available with SL



## FH29 Arc Flush Pull For PD8000/PD5000 Sliding & Pocket Door Locks



FH29 w/PD84



FH29 w/PD50

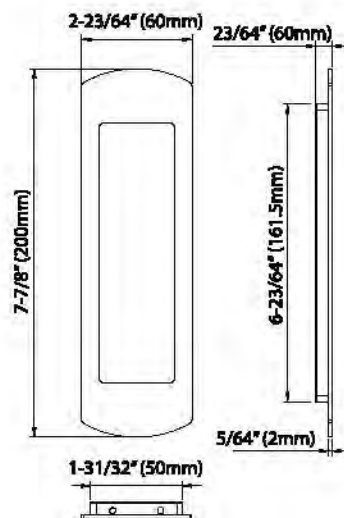

### Specifications

- Standard Door Thickness: 1-3/4" (45mm)  
Thick Door Kits available
- Handing: Non-Handed
- Thumbturn Spindle: 5x5mm square
- Deadbolt: 1" (25.4mm)
- Cylinder: Schlage C keyway 5 pin mortise cylinder with 2 keys (KD). Keying services available; order separately

### Application

For residential, hospitality or commercial application

### Material

Stainless Steel/Brass

### Finish

See page 35 for Finish options.

**Note:** FH29 Arc Trim cannot be installed on 1-3/8" doors. For 1-3/8" thick doors, order FH27SL (see page 28). Also available: FH22CF or FH23CF (see page 34).



**FH2900**  
Flush Pull Only



**FH2903**  
Flush Pull w/  
Cylinder Hole



**FH2982**  
Flush Pull  
w/ TT08  
Thumbturn



**FH2992**  
Flush Pull  
w/ TT09  
Thumbturn



**FH2904**  
Flush Pull w/  
Thumbturn  
Release

## FH31 Regal Flush Pull

For PD8000/PD5000 Sliding & Pocket Door Locks



FH31 w/PD84



FH31 w/PD50

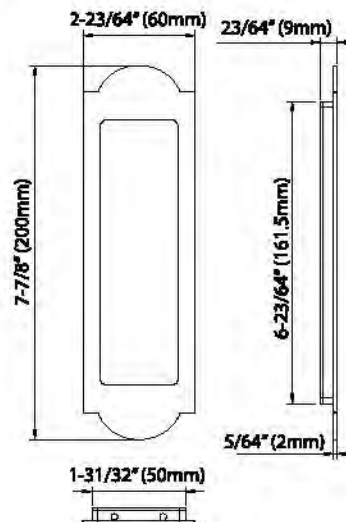

### Specifications

- Standard Door Thickness: 1-3/4" (45mm)  
Thick Door Kits available
- Handing: Non-Handed
- Thumbturn Spindle: 5x5mm square
- Deadbolt: 1" (25.4mm)
- Cylinder: Schlage C keyway 5 pin mortise cylinder with 2 keys (KD). Keying services available; order separately

### Application

For residential, hospitality or commercial application

### Material

Stainless Steel/Brass

### Finish

See page 35 for Finish options.

**Note:** FH31 Regal Trim cannot be installed on 1-3/8" doors. For 1-3/8" thick doors, order FH27SL (see page 28).

**Also available:** FH22CF or FH23CF (see page 34).



**FH3100**  
Flush Pull Only



**FH3103**  
Flush Pull w/  
Cylinder Hole



**FH3182**  
Flush Pull  
w/ TT08  
Thumbturn



**FH3192**  
Flush Pull  
w/ TT09  
Thumbturn



**FH3104**  
Flush Pull w/  
Thumbturn  
Release

## FH32 Crown Flush Pull

For PD8000/PD5000 Sliding & Pocket Door Locks



FH32 w/PD84



FH32 w/PD50

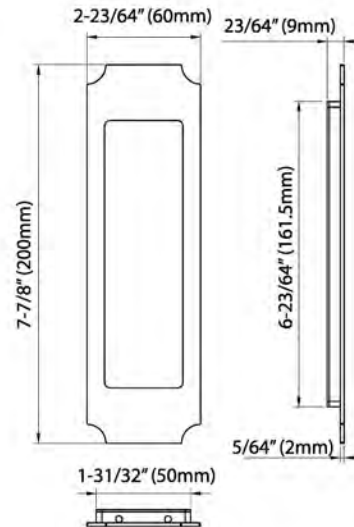

### Specifications

- Standard Door Thickness: 1-3/4" (45mm)  
Thick Door Kits available
- Handing: Non-Handed
- Thumbturn Spindle: 5x5mm square
- Deadbolt: 1" (25.4mm)
- Cylinder: Schlage C keyway 5 pin mortise cylinder with 2 keys (KD). Keying services available; order separately

### Application

For residential, hospitality or commercial application

### Material

Stainless Steel/Brass

### Finish

See page 35 for Finish options.

**Note:** FH32 Crown Trim cannot be installed on 1-3/8" doors. For 1-3/8" thick doors, order FH27SL (see page 28).  
Also available: FH22CF or FH23CF (see page 34).



**FH3200**  
Flush Pull Only



**FH3203**  
Flush Pull w/  
Cylinder Hole



**FH3282**  
Flush Pull  
w/ TT08  
Thumbturn



**FH3292**  
Flush Pull  
w/ TT09  
Thumbturn



**FH3204**  
Flush Pull w/  
Thumbturn  
Release



## FH22 Luna Flush Pull

For PD8000/PD5000 Sliding & Pocket Door Locks



FH22 with PD84



FH22 with PD50

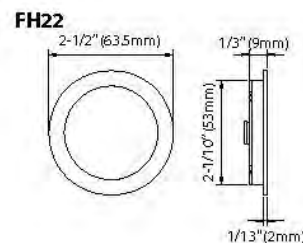

### Specifications

- Standard Door Thickness: 1-3/4" (45mm)  
Thick Door Kits available
- 1-3/8" Door Thickness: Use FH22CF
- Handing: Non-Handed
- Thumbturn Spindle: 5x5mm square
- Deadbolt: 1" (25.4mm)
- Cylinder: Schlage C keyway 5 pin mortise cylinder with 2 keys (KD). Keying services available; order separately

### Application

For residential, hospitality or commercial application

### Material

Stainless Steel/Brass

### Finish

See page 35 for Finish options.

### Trim Options

**Note:** FH22 Luna Trim cannot be installed on 1-3/8" doors. For 1-3/8" thick doors, order FH22CF (see page 34).

#### Standard FH22 Luna trim - For doors 1-3/4" thick



**FH2200**  
Flush Pull Only



**FH2203**  
Flush Pull with  
Cylinder Hole

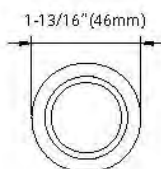

**FH2282**  
Flush Pull  
with TT08 Thumbturn



**FH2204**  
Flush Pull with  
Thumbturn Release

## FH23 Urban Flush Pull

For PD8000/PD5000 Sliding & Pocket Door Locks



FH23 w/PD84



FH23 w/PD50

### FH23

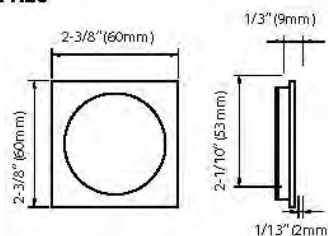

#### Specifications

- Standard Door Thickness: 1-3/4" (45mm)  
Thick door kits available
- 1-3/8" Door Thickness: Use FH23CF
- Handing: Non-Handed
- Thumbturn Spindle: 5x5mm square
- Deadbolt: 1" (25.4mm)
- Cylinder: Schlage C keyway 5 pin mortise cylinder with 2 keys (KD). Keying services available; order separately

#### Application

For residential, hospitality or commercial application

#### Material

Stainless Steel/Brass

#### Finish

See page 35 for Finish options.

#### Trim Options

**Note:** FH23 Urban Trim cannot be installed on 1-3/8" doors. For 1-3/8" thick doors, order FH23CF (see page 34).

#### Standard FH23 Urban Trim for doors 1-3/4"



**FH2300**  
Flush Pull Only



**FH2303**  
Flush Pull with  
Cylinder Hole

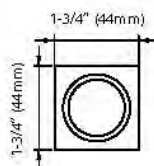

**FH2382**  
Flush Pull with  
TT08 Thumbturn



**FH2304**  
Flush Pull with  
Thumbturn Release



## FH22CF Luna & FH23CF Urban Concealed Fixing Flush Pulls For PD8000/PD5000 Sliding & Pocket Door Locks for doors 1-3/8" and Thicker



FH22CF (Concealed Fixing)  
with PD84

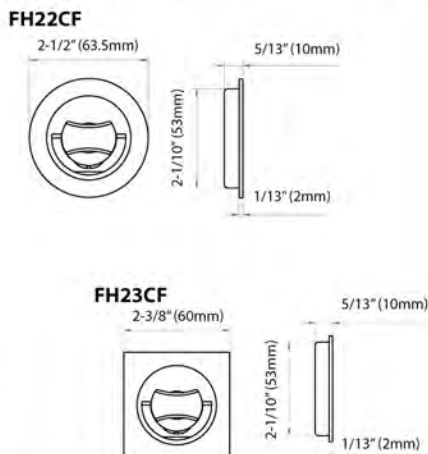

FH23CF (Concealed Fixing)  
with PD84

### Specifications

- Standard Door Thickness: 1-3/8" or thicker  
Thick Door Kits available
- Handing: Non-Handed
- Thumbturn Spindle: 5x5mm square
- Deadbolt: 1" (25.4mm)
- Cylinder: Schlage C keyway 5 pin mortise cylinder with 2 keys (KD). Keying services available; order separately

### Application

For residential, hospitality or commercial application

### Material

Stainless Steel/Brass

### Finish

See page 35 for Finish options.

### Trim Options

**Concealed Fixing Trim is for doors 1-3/8" thick or greater; only available for Passage, Privacy, and Patio (not Entry) functions**

#### FH22CF Luna Concealed Fixing



**FH2200CF**  
Flush Pull Only



**FH2262CF**  
Flush Pull with  
TT067 Thumbturn



**FH2204CF**  
Flush Pull with  
Thumbturn Release

#### FH23CF Urban Concealed Fixing



**FH2300CF**  
Flush Pull Only



**FH2362CF**  
Flush Pull w/  
TT06 Thumbturn



**FH2304CF**  
Flush Pull with  
Thumbturn Release

## Flush Pull Options



## Finish Options

TRIM DESIGN	DOOR THICKNESS		BRASS MATERIAL										STAINLESS STEEL MATERIAL	
	1-3/8" +	1-3/4" or more	Brass Tones				Dark Tones		Silver Tones					
														
			US3* (605)	US4 (606)	US7 (608)	38 (Aged Brass)	US10B (613)	19G	US14* (618)	US15 (619)	US26 (625)	US26D (626)	US32 (629)	US32D (630)
FH27...	N/A	✓	✓	✓	○	✓	✓	✓	✓	✓	✓	✓	✓	✓
FH27...SL**	✓	Use FH27	○	✓	○	✓	✓	✓	✓	✓	✓	✓	✓	✓
FH29...	N/A	✓	✓	✓	○	✓	✓	○	✓	✓	○	✓	✓	✓
FH31...	N/A	✓	✓	✓	○	✓	✓	○	✓	✓	○	✓	✓	✓
FH32...	N/A	✓	✓	✓	○	✓	✓	○	✓	✓	○	✓	✓	✓
FH22...	N/A	✓	✓	✓	○	✓	✓	○	✓	✓	○	✓	✓	✓
FH23...	N/A	✓	✓	✓	○	✓	✓	○	✓	✓	○	✓	✓	✓
FH22CF	✓	✓	N/A	✓	○	○	✓	✓	○	○	○	✓	✓	✓
FH23CF	✓	✓	N/A	✓	○	○	✓	✓	○	○	○	✓	✓	✓

✓ = In stock; standard lead time 1-2 weeks

○ = Special Order; standard lead time 8-12 weeks, minimum order quantity may apply

N/A = Not Available

### Finish Key:

US3 Bright Brass - Lifetime PVD  
 US4 Satin Brass - Lifetime PVD  
 US7 French Antique  
 US10B Oil Rubbed Bronze  
 G19 Graphite Black  
 US14 Polished Nickel (Brass) - Lifetime PVD  
 US15 Satin Nickel (Brass)  
 US26 Polished Chrome (Brass)  
 US26D Satin Chrome (Brass)  
 US32 Bright Stainless Steel - Lifetime  
 US32D Satin Stainless Steel - Lifetime  
 38 - Aged Brass

### INOX™ CeraMax® Ceramic Coating:

C19G - Ceramic Graphite Black  
 C19 - Ceramic Flat Black  
 CGY - Ceramic Stormy Grey  
 CDB - Ceramic Dark Bronze

\* US3 (605) and US14 (618) are Lifetime PVD on Brass. See inside front cover for more information.

\*\* FH27SL (face fixing) and FH22CF and FH23CF (both concealed fixing) are Slim Trim for 1-3/8" doors. Slim Trim is not available as Keyed Entry function (Passage/Privacy/Dummy only) and the FH27SL uses the TT09 (not the TT08) thumbturn.





# PD9000 Mortise Lock with Emergency Egress



## PD9000 Series Mortise Lock with Emergency Egress

### PD95: Lockcase with Deadbolt

Available in 2 backsets: 2-1/2" and 2-3/4"

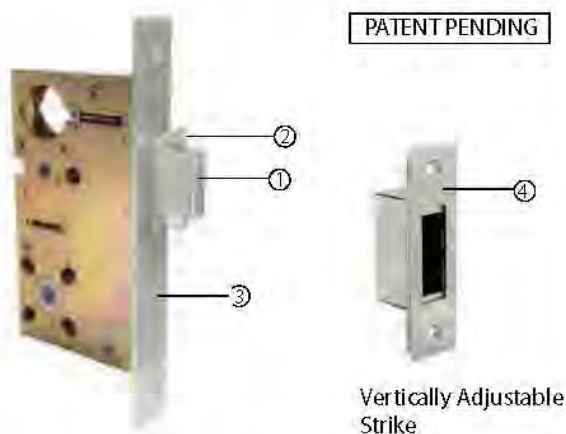

- 1) Brass deadbolt with 1" throw
- 2) Self-retracting hook with non-marring latch bolt
- 3) Stainless steel or brass faceplate, 2mm thick
- 4) Vertically adjustable strike

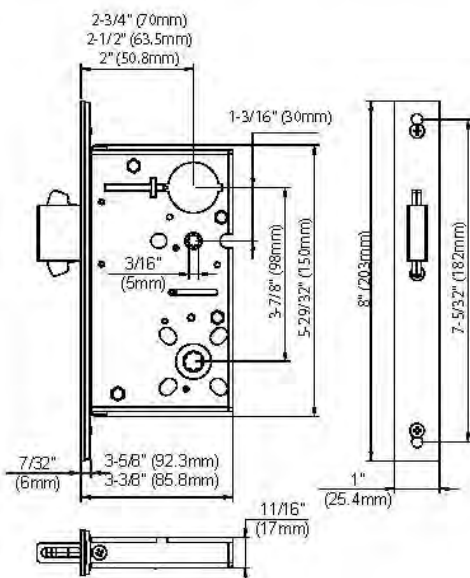

## PD9000 Series Mortise Auto-Lock with Emergency Egress

### COMING SOON!

### PD96: Lockcase with Deadbolt

Will be available in 2 backsets: 2-1/2" and 2-3/4"

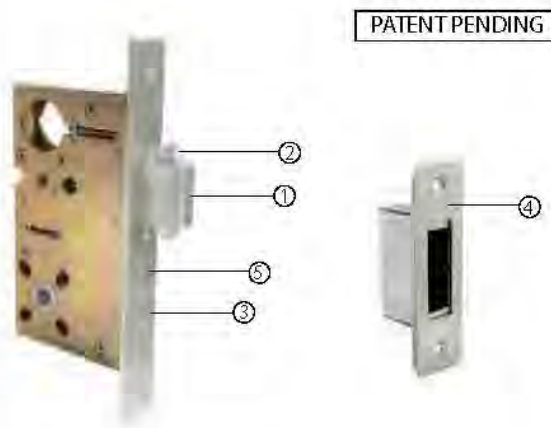

- 1) Brass deadbolt with 1" throw
- 2) Self-retracting hook with non-marring latch bolt
- 3) Stainless steel or brass faceplate, 2mm thick
- 4) Vertically adjustable strike
- 5) Auto Lock activation

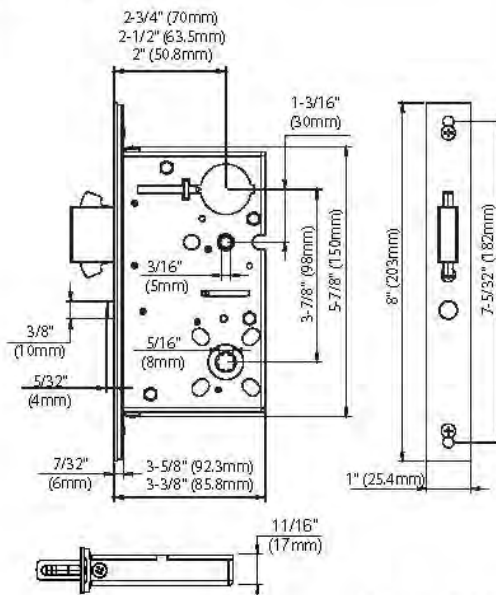

COMING SOON

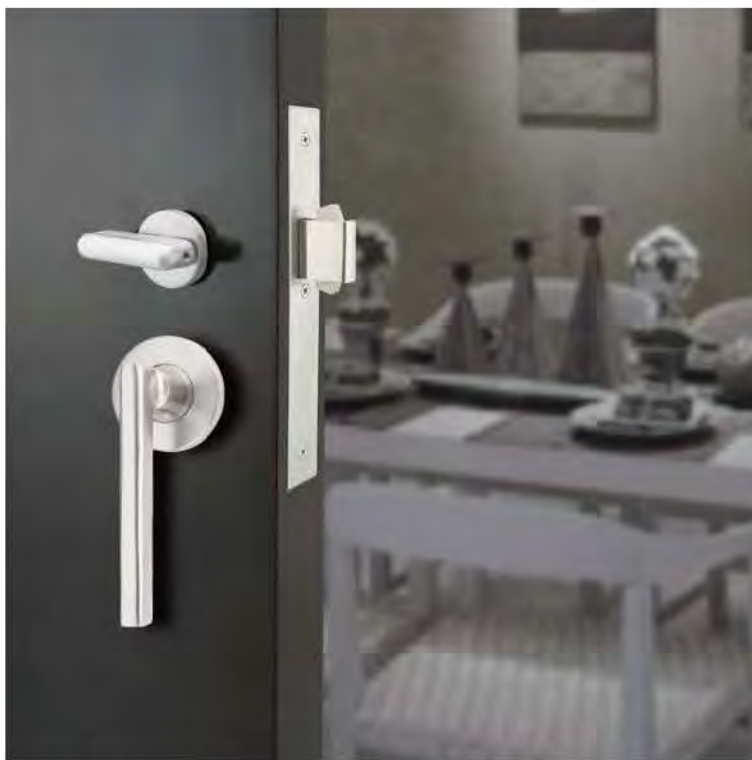

## PD95 Mortise Locks with X Series Trim for Sliding Doors

**PD95 with XGT202**

**PD95 with XGT243**

**PD95 with XGT345**

**PD95 with XGS205**

## PD95 Mortise Locks with X Series Levers for Sliding Doors

### How to Order

1. Select rose and lever design. See page 41 for lever options
2. Select lock based on function
3. Select backset and finish
4. Use complete codes below to order locksets
5. To order lever x pull handle add LXH code (e.g., XGT243PD9530-234-LXH-32D) and order pull handle separately (see page 21 for ADA pulls)

### Product Identification

**XGT243 PD9540 -234 -32D**

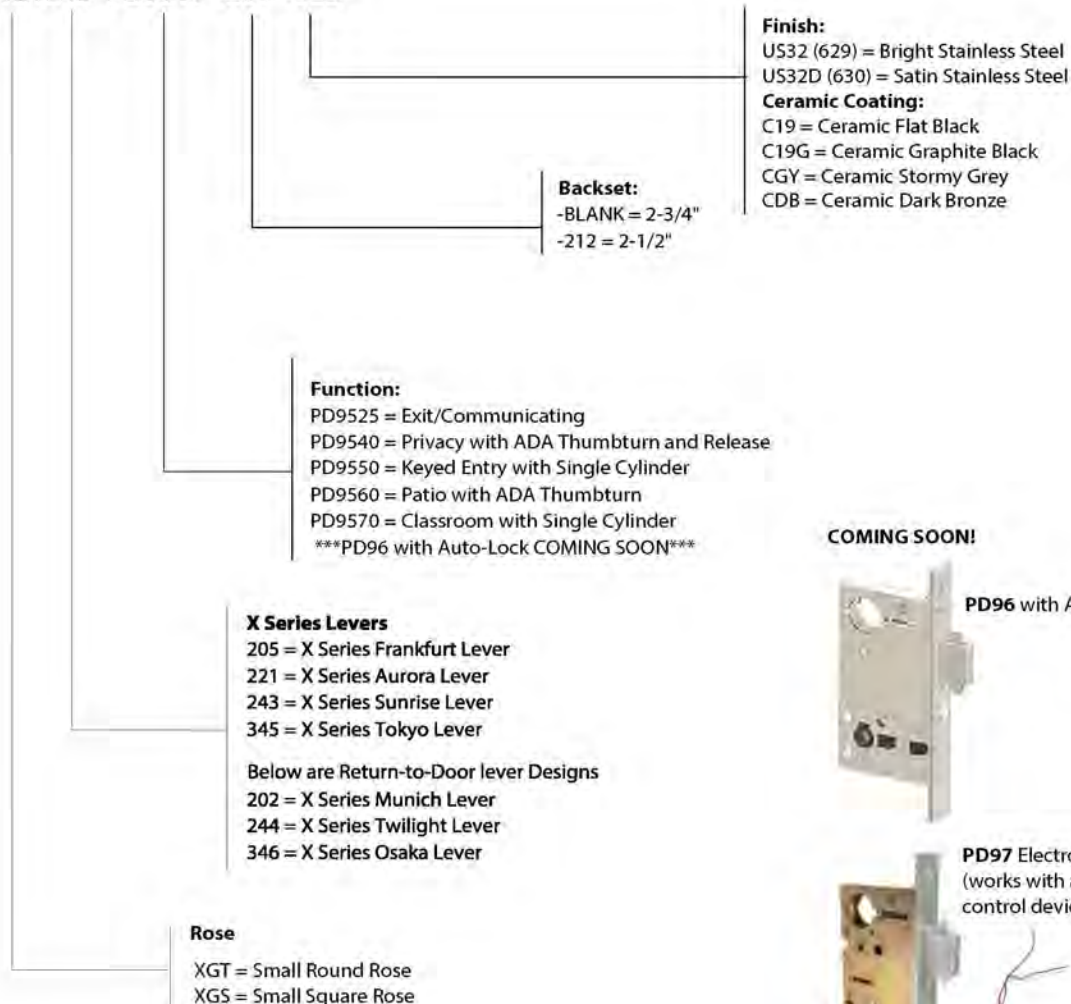

**COMING SOON!**



PD96 with Auto-Locking Function



PD97 Electronic Version  
(works with any access control device)



## PD95 Mortise Locks w/Emergency Egress for Sliding Doors

### Grade 1



See page 41 for X Series lever design options.

#### Specifications

- Standard door thickness: 1-3/4" (45mm)  
Thick Door Kits available
- Backset: 2-3/4" (70mm) and 2-1/2" (64.5mm)
- Handing: Please specify Handing when ordering
- Thumbturn Spindle: 5x5mm square
- Deadbolt: 1" (25.4mm)
- Cylinder: Schlage C keyway 6 pin mortise cylinder with 2 keys (KD). Keying services available; order separately

#### Material

Lockcase: Heavy Gauge Steel  
Deadbolt: Brass and Stainless Steel  
Cylinder: Solid Brass

#### Lock Options



**PD95** (2-3-4" Backset)  
**PD95A** (2-1/2" Backset)

Lock Case with deadbolt, activated by lever with emergency egress function, less Cylinder



**PD96** (2-3-4" Backset)  
**PD96A** (2-1/2" Backset)

Lock Case with deadbolt, activated by lever with emergency egress function  
Mechanical Auto-locking

**COMING SOON**

#### Application

INOX™ PD9000 Series Mortise Locks for sliding doors has a unique design that provides locking Entry function for Sliding Doors while allowing emergency egress for improved life safety and security as well as code compliance  
Deadbolt opens from the inside with one quick, single action for easy exit during emergencies

#### Trim



- Solid Stainless Steel Lever (see pg. 41)
- Hardened knurled brass nut for mechanical integrity and strength
- Cast Stainless Steel sub-rose
- Threaded Rose covers for easy installation.
- Heavy duty wire torsion spring

#### Finish

##### Locks and Surface Pulls for Sliding/Barn Doors:

US32 (629) Bright Stainless Steel

US32D (630) Satin Stainless Steel

SP (Split Bright/Satin Stainless Steel)

See page 41 for Finish options for each lever

##### Ceramic Coating (Inquire about lead time and pricing)

- C19G Ceramic Graphite Black
- C19 Ceramic Flat Black
- CGY Ceramic Stormy Grey
- CDB Dark Bronze

#### Thumbturn & Release

EC-R460PVS-ADA

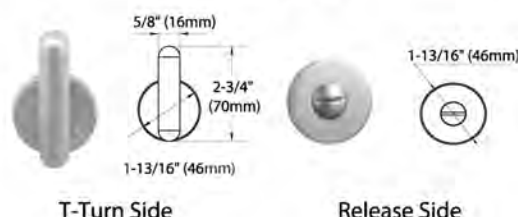

T-Turn Side

Release Side

#### Certification & Warranty





- ANSI A117.1 Accessibility Code (ADA Compliant)
- Lifetime Warranty

#### Installation

Visit [www.inoxproducts.com/resources](http://www.inoxproducts.com/resources) for the latest door preparation templates and installation instructions.

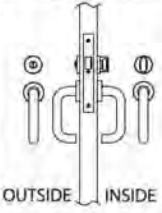
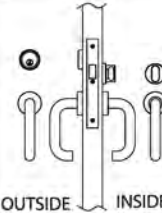
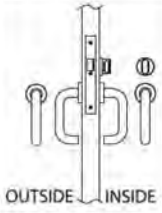
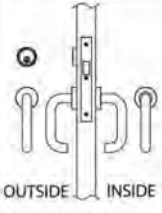

## Functions

Sliding Door Lock with Lever Trim

 <p>OUTSIDE INSIDE</p>	<p><b>PD9540</b> <b>Privacy with Emergency Release</b> Deadbolt retracted by either thumbturn or handle (inside) or emergency coin release (outside) Outside lever is Dummy function</p>	 <p>OUTSIDE INSIDE</p>	<p><b>PD9550</b> <b>Entry with Single Cylinder</b> Deadbolt retracted by either thumbturn or handle (inside) or key (outside) Outside lever is Dummy function</p>
 <p>OUTSIDE INSIDE</p>	<p><b>PD9560</b> <b>Patio</b> Deadbolt retracted by thumbturn or lever (inside) Outside lever is Dummy function</p>	 <p>OUTSIDE INSIDE</p>	<p><b>PD9570</b> <b>Classroom with Single Cylinder</b> Deadbolt retracted by handle (inside) or key (outside) Outside lever is Dummy function</p>
		 <p>OUTSIDE INSIDE</p>	<p><b>PD9525</b> <b>Exit/Communicating</b> Latchbolt operated by inside lever No outside trim Auxiliary latch deadlocks latchbolt when door is closed</p>

## Functions

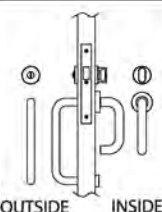
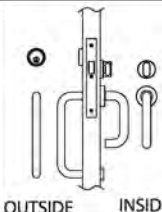
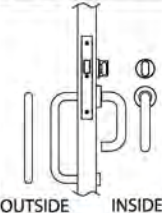
Sliding Door with Lever by Pull Handle Trim  
See pg. 21 for ADA Pull options

 <p>OUTSIDE INSIDE</p>	<p><b>PD9540</b> <b>Privacy with Emergency Release</b> Deadbolt retracted by either thumbturn or handle (inside) or emergency coin release (outside)</p>	 <p>OUTSIDE INSIDE</p>	<p><b>PD9550</b> <b>Entry with Single Cylinder</b> Deadbolt retracted by either thumbturn or handle (inside) or key (outside)</p>
 <p>OUTSIDE INSIDE</p>	<p><b>PD9560</b> <b>Patio</b> Deadbolt retracted by thumbturn or lever (inside)</p>	 <p>OUTSIDE INSIDE</p>	<p><b>PD9570</b> <b>Classroom with Single Cylinder</b> Deadbolt retracted by handle (inside) or key (outside)</p>



### Levers

Shown with XGT Rose



**205 Frankfurt**  
(32, 32D)



**221 Aurora**  
(32, 32D, SP)



**243 Sunrise**  
(32, 32D)



**345 Tokyo**  
(32, 32D)



**202 Munich**  
(32, 32D)



**244 Twilight**  
(32, 32D)



**346 Osaka**  
(32, 32D)

### Return-to-Door Lever Designs

Complies with California and other state building codes for door openings

Contact your INOX Sales Representative for other trim availability.





Please visit our website  
[www.inoxproducts.com](http://www.inoxproducts.com)  
 for more technical and new product information.

## INOX™

A product of Unison Hardware, Inc.  
 6 Wayne Court, Sacramento, CA 95829, USA  
 Tel: +1.916.388.1888 Fax: +1.916.388.8322  
 Email: [info@unisonhardware.com](mailto:info@unisonhardware.com)