

NOTE 1: TEMPLATE NOT TO SCALE  
NOTE 2: DIMENSIONS IN [ ] ARE IN MILLIMETERS.

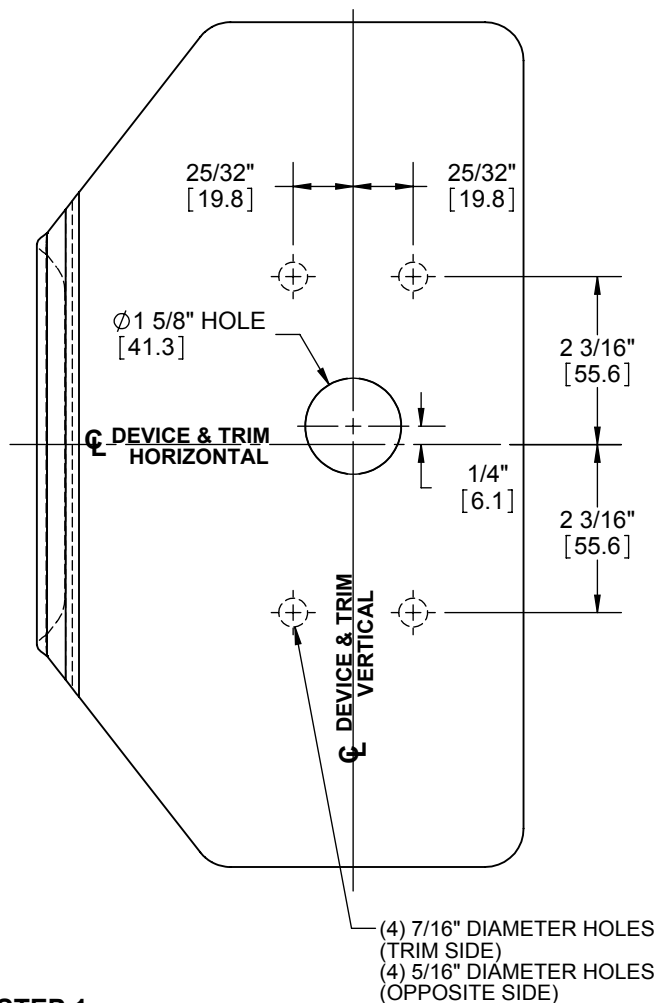

**STEP 1.**  
PREPARE PUSH SIDE OF THE DOOR FOR EXIT DEVICE. SEE EXIT DEVICE TEMPLATE FOR DOOR PREPARATION DETAIL.

- STEP 2.**  
PREPARE PULL SIDE OF DOOR FOR PULL.
- TRANSFER VERTICAL AND HORIZONTAL DEVICE CENTERLINES FROM PUSH SIDE OF DOOR TO PULL SIDE.
  - LOCATE AND PREP HOLES USING DIAGRAM ABOVE.

## 313S ANTI-VANDAL PULL INSTALLATION INSTRUCTIONS

### 313S LHR PULL WITH 4500 SERIES EXIT DEVICE

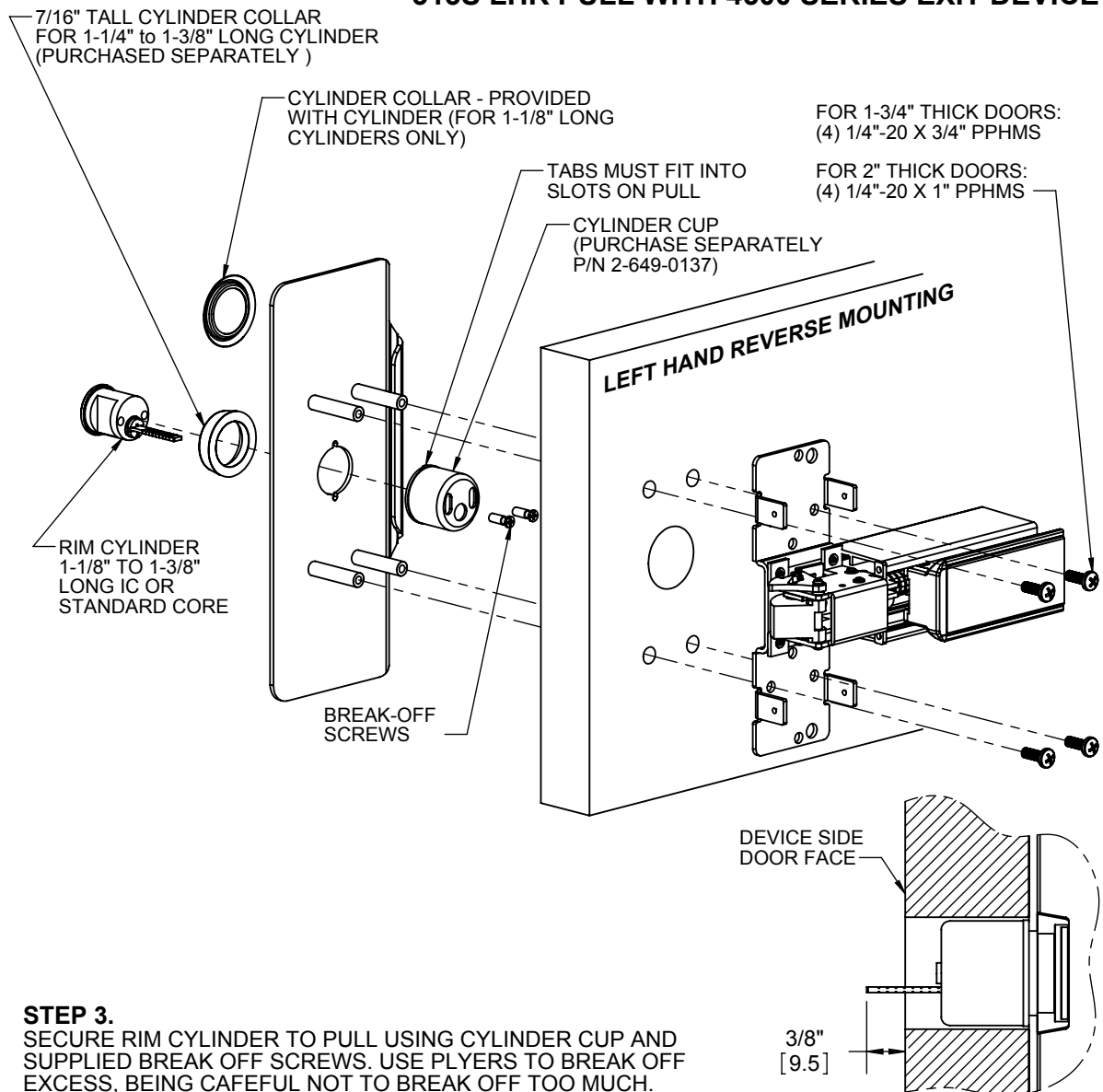

**STEP 3.**  
SECURE RIM CYLINDER TO PULL USING CYLINDER CUP AND SUPPLIED BREAK OFF SCREWS. USE PLIERS TO BREAK OFF EXCESS, BEING CAREFUL NOT TO BREAK OFF TOO MUCH.

**STEP 4.**  
PLACE TRIM ON DOOR AND CUT CYLINDER TAILPIECE SO IT PROJECTS 3/8\"/>

**STEP 5.**  
SECURE PULL AND EXIT DEVICE USING THE 4 MOUNTING SCREWS.