



PRODUCT SPECIFICATIONS
For more information visit www.hagerco.com

Long Rod & Shoe 5100 Series-5112

Long Rod and Shoe

Applications

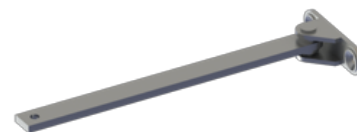

PRODUCT SPECIFICATIONS

Box Quantity:
1

Case Quantity:
10

Handing:
Non-handed

Material:
Cast steel

Notes:
Use for top jamb application
Use for reveals greater than 3" (76 mm) and up to 5" (127 mm)