



PRODUCT SPECIFICATIONS
For more information visit www.hagerco.com

970P

Push/Pull Set

Applications

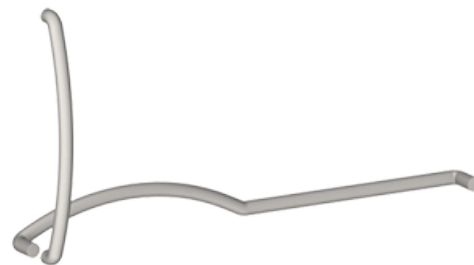

PRODUCT SPECIFICATIONS

Base Diameter:
1" (25 mm)

CTC:
- 16-3/4" (425 mm)- Push; 34" (864 mm) or to suit door dimension-
Pull

Fasteners:
Type 3 mounting, concealed cone with bolt and set screw; Type 1,
thru-bolt, finish washer mount for free ends

Finishes:
US3, US4, US10, US10B, US15A, US26, US26D, US32D

Projection:
3" (76 mm)- Pull; - 2-3/4" (70 mm)- Push

Pull Clearance:
2" (51 mm); Push Clearance 1-3/4" (45 mm)