



PRODUCT SPECIFICATIONS
For more information visit www.hagerco.com

9883CS Floor Guide

2-Piece Door Guide set with fasteners

Applications

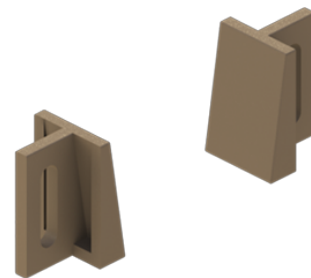

PRODUCT SPECIFICATIONS

Case Quantity:
100

Material:
Tan Polyethylene

Notes:
Guide: 13/16" (21 mm) x 3/4" (19 mm) x 1-1/8" (29 mm)

Screws to jamb to guide door and prevent rubbing

Packaging:
Bulk