

NOTE:
1. 7-PIN CYLINDERS CAN WORK WITH BOTH 7-PIN CORES & 6-PIN CORES WITH SPACER

REV.	DESCRIPTION	ECO NO.	DATE
-	CREATED FOR CUSTOMER	-	12/16/2015

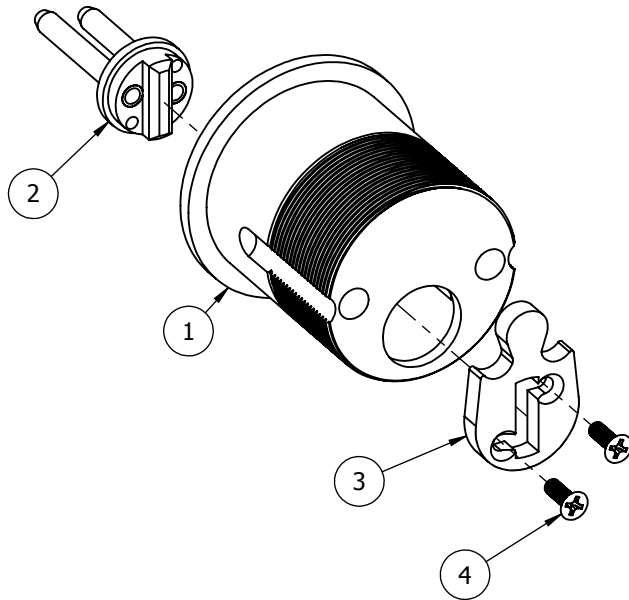
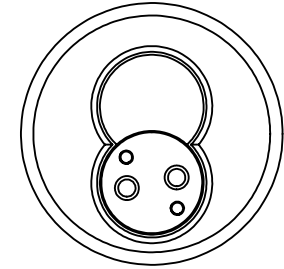
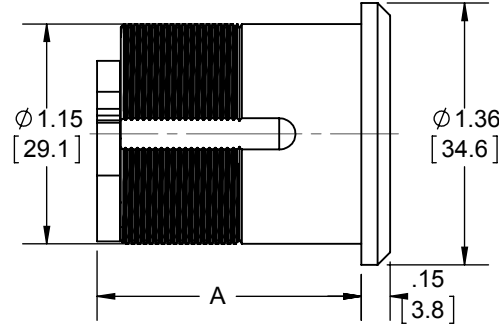
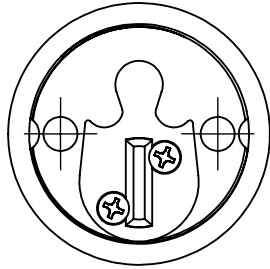

A	SFIC	
	6-PIN	7-PIN
1-1/4"	•	
1-3/8"	•	•
1-1/2"	•	•
1-5/8"	•	•

ITEM NO.	FILE NAME	DESCRIPTION	QTY.
1	S-LS00002	MORTISE CYLINDER BODY, 1-3/8"	1
2	S-CK00049	FORK ASSY, IC CORE MORTISE	1
3	S-CK00026	MORTISE LOCK CAM - SCHLAGE L CAM	1
4	S-TA01119	#2-56 x 1/4" FHMS (FPHM)	2

PROPRIETARY & CONFIDENTIAL

THE INFORMATION CONTAINED IN THIS DRAWING IS THE SOLE PROPERTY OF HAGER COMPANIES. ANY REPRODUCTION IN PART OR AS A WHOLE WITHOUT THE WRITTEN PERMISSION OF HAGER COMPANIES IS PROHIBITED.

HAGER COMPANIES
ST. LOUIS, MISSOURI

HAGER RESERVES THE RIGHT TO MAKE DESIGN CHANGES WITHOUT NOTICE. CALL HAGER ENGINEERING AT 1-800-325-9995 FOR THE LATEST REVISION DATE OF TEMPLATE.

DRAWN	KJW	12/15/2015
ENG. APPR.	MAM	12/16/2015
MATERIAL	Material <not specified>	
FINISH	-	
DO NOT SCALE DRAWING		
TOLERANCES: FRACTIONAL: ±0.015" ANGULAR: MACH: ±1° BEND: ±1° TWO PLACE DECIMAL: ±0.01" THREE PLACE DECIMAL: ±0.004"		

3902-1
MORTISE CYLINDER ASSY, SFIC

SIZE DWG. NO. REV.
A S-LS02048 -

SCALE: 1:1 WEIGHT: 0.29 SHEET 1 OF 1