

SIZE: 6 3/4 (171.45) FOR 1 3/4 (44.45) DOOR

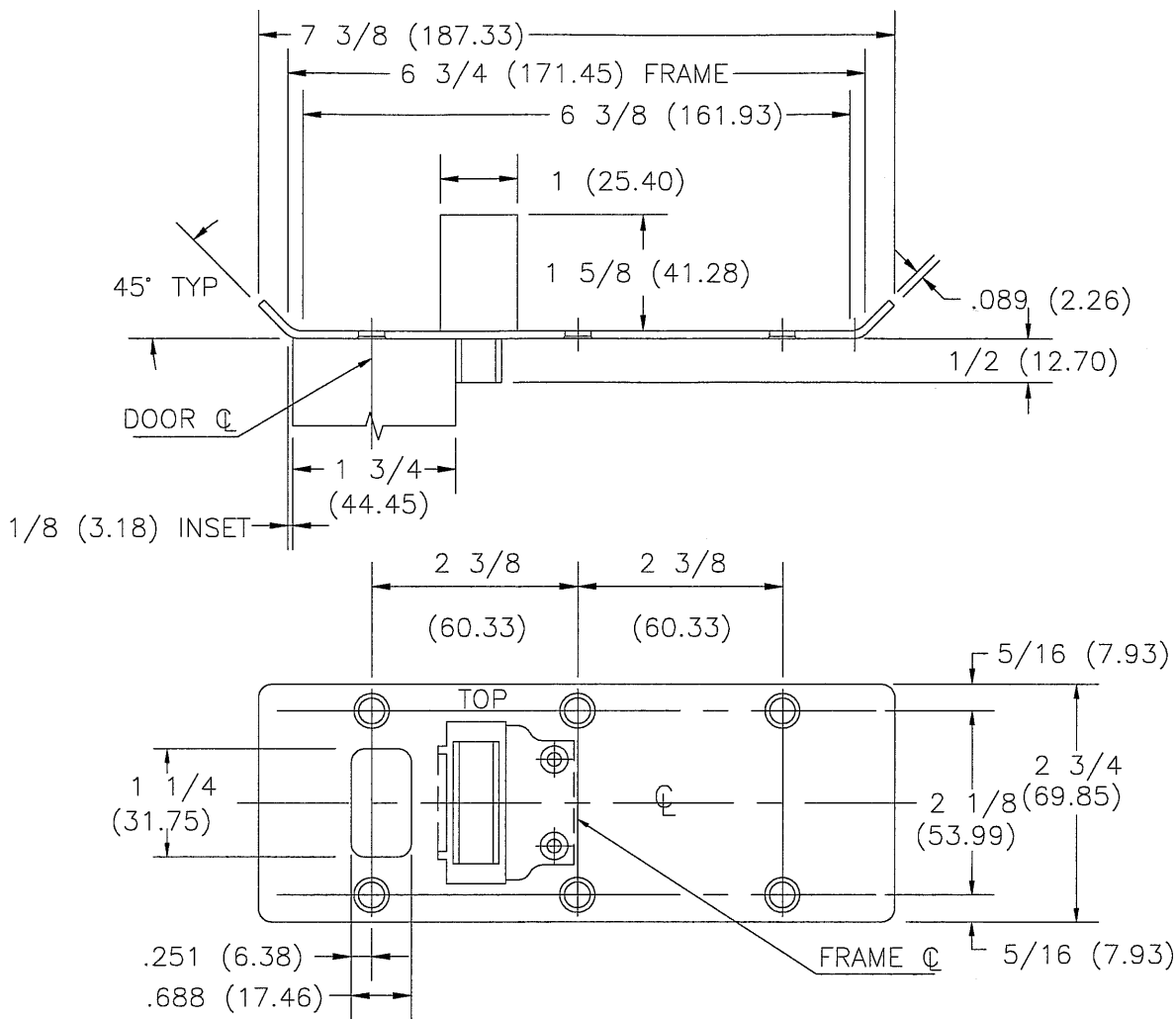

L.H. DOOR SWING INSTALLATION SHOWN
RIGHT HAND OPPOSITE

ALL NON-BRACKETED DIMENSIONS
ARE IN INCHES, ALL BRACKETED
DIMENSIONS ARE IN MILLIMETERS.

-DO NOT SCALE-

CATALOG NUMBER	MATERIAL
458	BRASS

Machine Screw Size
8-32 x 1/2" undercut F.H.

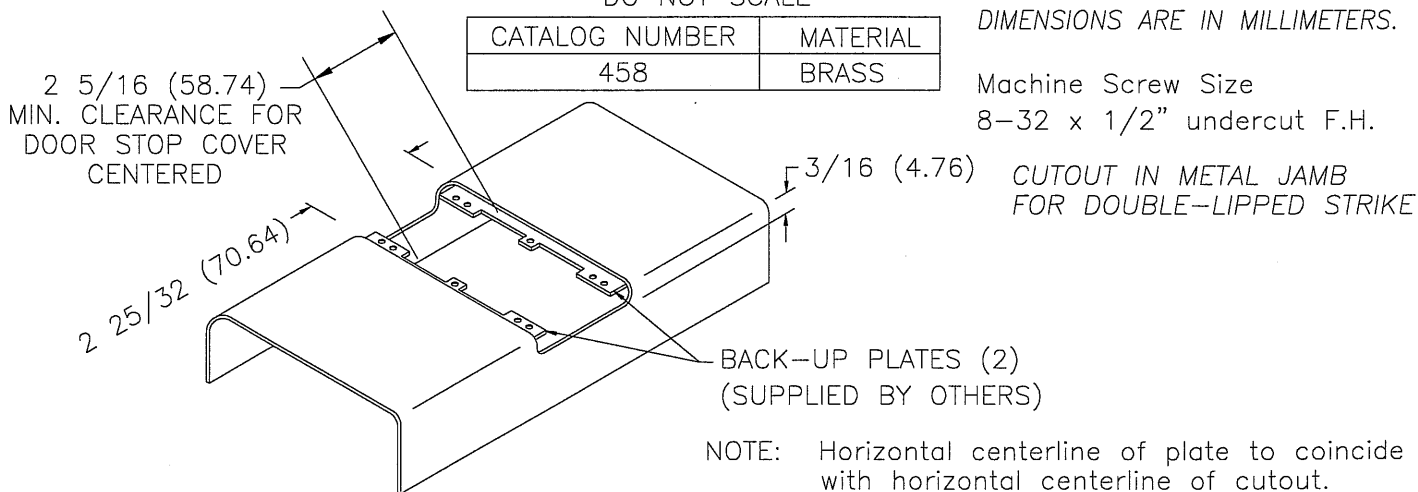

CUTOUT IN METAL JAMB
FOR DOUBLE-LIPPED STRIKE

NOTE: Horizontal centerline of plate to coincide
with horizontal centerline of cutout.

H
HAGER COMPANIES
139 Victor St.
St. Louis, MO 63104
1-800-325-9995

HAGER RESERVES THE RIGHT TO MAKE DESIGN CHANGES WITHOUT NOTICE.			
NO.	REVISION	BY	DATE
3	PER ECO CT08036	SEW	11-03-08

DESCRIPTION:
6-3/4" COMBINATION RESCUE DOOR STOP AND
TWO WAY STRIKE FOR INSET HUNG DOORS

PART NO. T369