

**Included Accessories (1-1/8 barrel length locks):**

- 2 10-350 plastic spacers
- 1 10-054 1/4" plastic bar strike
- 1 10-055 1/2" plastic bar strike
- 4 lock mounting screws
- 1 10-360 universal driver
- 1 10-361 tailpiece (Schlage)

**Included Accessories (1-3/8 barrel length locks):**

- 1 10-054 1/4" plastic bar strike
- 4 lock mounting screws
- 1 10-360 universal driver
- 1 10-362 tailpiece (Schlage)
- 1 10-363 tailpiece (Medeco)
- 1 10-364 tailpiece (Assa)

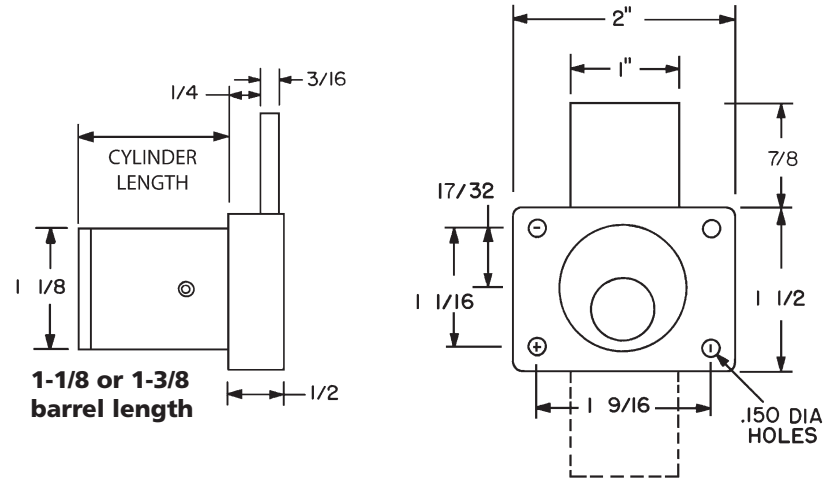

See pages 2 - 3 for cylinder installation instructions.

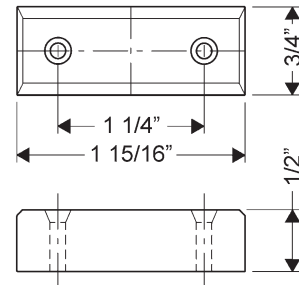

10-055 - 1/2" bar strike

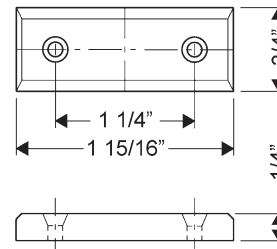

10-054 - 1/4" bar strike

**Typical Installation**

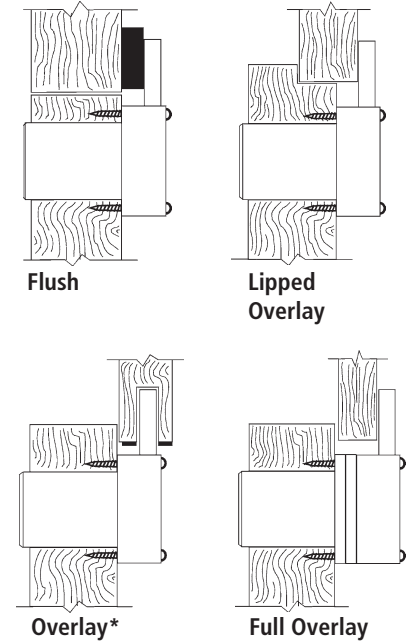

\*Overlay installation is not recommended for particleboard.

**Installation/handling for key-retaining option**

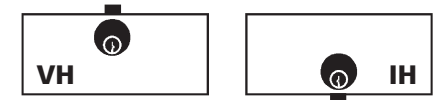

**Spacer options** Note: use of spacers and strikes depends on application and material thickness.

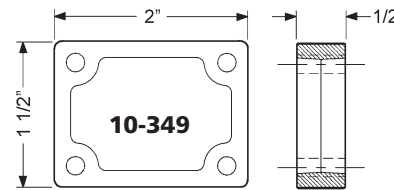
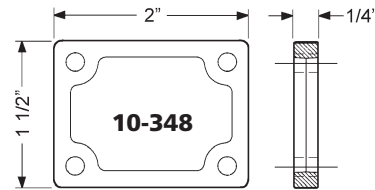
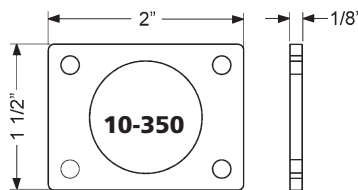

# Cylinder installation for less cylinder locks with standard function (key removable in locked and unlocked position)

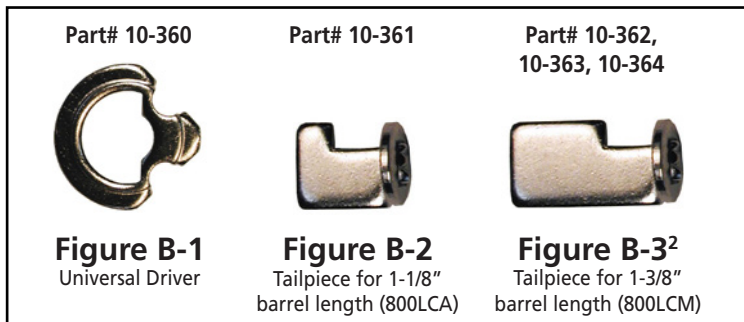
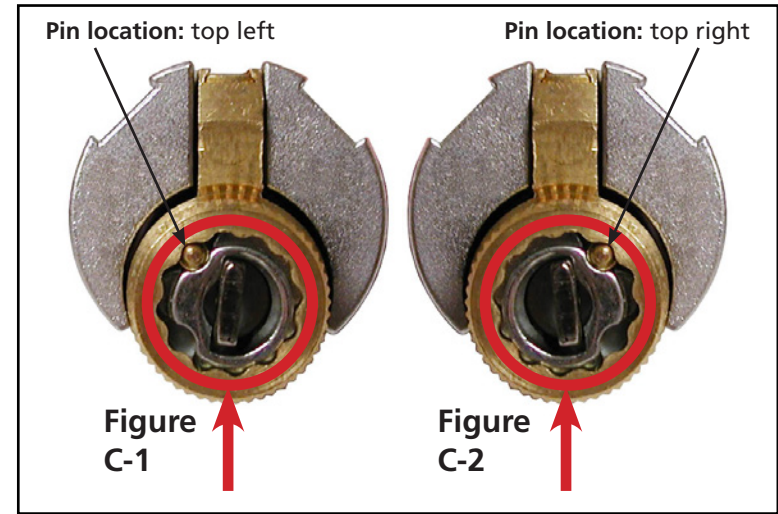
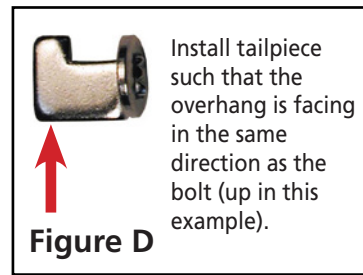
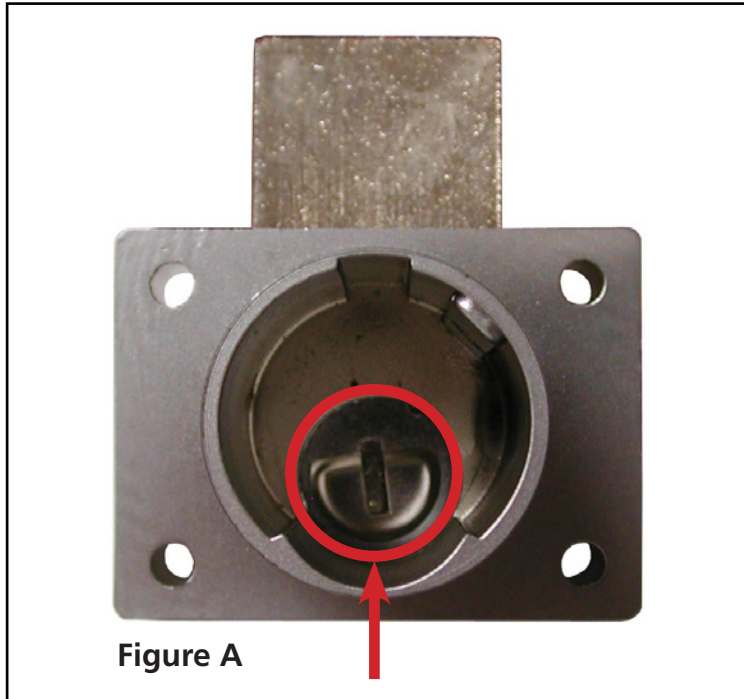

<sup>2</sup> **NOTE: Figure B-3.** 800LCM (1-3/8" barrel length locks) ship standard with 3 tailpieces for use with the following cylinders:  
 10-362 - For use with Schlage original or Schlage compatible cylinders  
 10-363 - Stamped "M" - for use with Medeco cylinders  
 10-364 - Stamped "A" - for use with Assa cylinders

## Cylinder installation for standard function<sup>1</sup>

- Step 1:** Cycle lock so that the deadbolt is either completely up or completely down. The slot inside the lock case should be in a vertical (up/down) orientation (**Figure A**).
- Step 2:** Install the universal driver (**Figure B-1**) into the back of the cylinder. If pin is located on the top left, install as shown in **Figure C-1**. If pin is located on top right, install as shown in **Figure C-2**.
- Step 3:** Install the tailpiece into the back of the cylinder in the vertical position such that the overhang is facing in the same direction as the bolt when the cylinder is put into the lock housing (**Figure D**).
- Step 4:** Pick up the lock body and slide it down over the cylinder. If the tailpiece does not immediately go into the vertical slot, pick up the complete assembly, put the key into the cylinder, and turn the key slightly back and forth until the tailpiece drops into the slot. Secure the cylinder housing to the body using the supplied set screw.

<sup>1</sup> **Standard (non-captive) function = key removable in the locked and unlocked position**

## Cylinder installation for less cylinder locks with key-retaining function (key removable in locked position only)

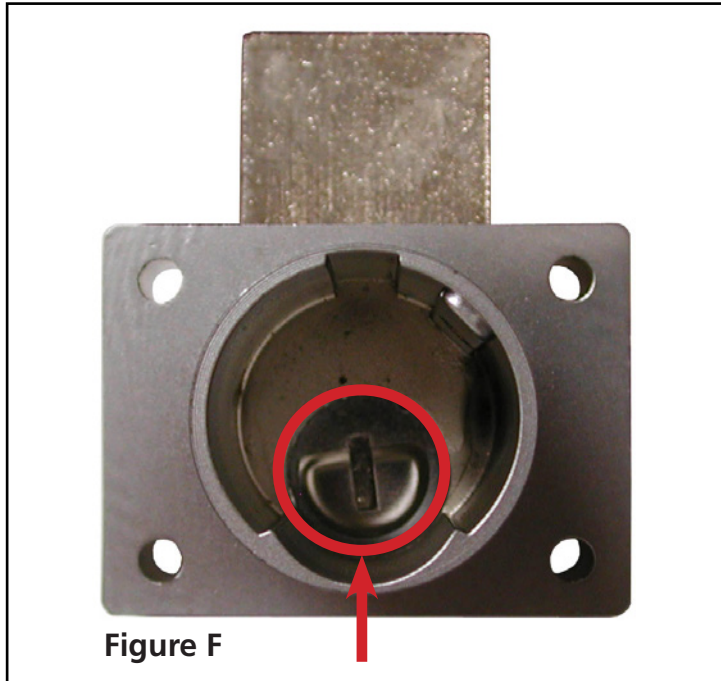

Figure F

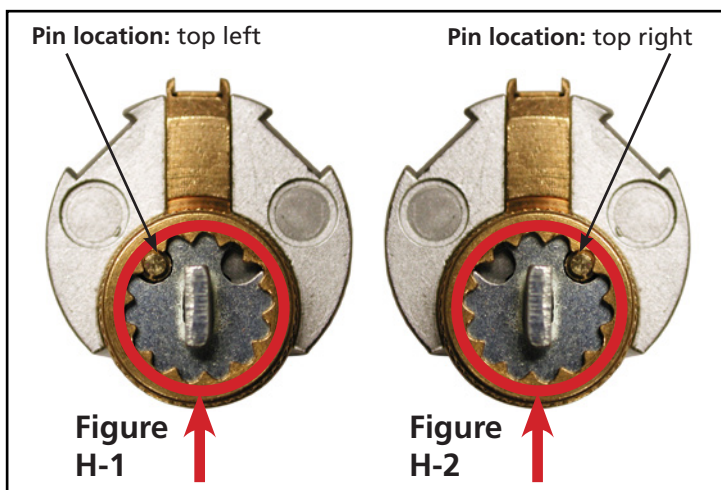
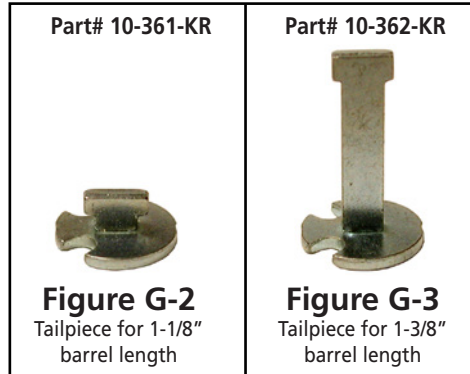

Figure H-1

Figure H-2



**Special note:** G-2 and G-3 drivers are based on use with standard Schlage compatible cylinders. If you are using a non-standard cylinder, you may need to modify the length of the G-2 or G-3 tailpiece to properly fit the cylinder into the lock body.

### Cylinder installation for key-retaining function<sup>1</sup>

- Step 1:** Cycle lock so that the deadbolt is in the desired "locked" position. The slot inside the lock case should be in a vertical (up/down) orientation (**Figure F**).
- Step 2:** Install the key-retaining tailpiece into the back of the cylinder (for LCA 1-1/8" barrel length locks use **Figure G-2** and for LCM 1-3/8" barrel length locks use **Figure G-3**).  
If the pin is located on the top left, install as shown in **Figure H-1**. If pin is located on top right, install as shown in **Figure H-2**.
- Step 3:** Pick up the lock body and slide it down over the cylinder. If the tailpiece does not immediately slip into the horizontal slot, pick up the complete assembly, put the key into the cylinder, and turn the key slightly back and forth until the tailpiece drops into the slot. Secure the cylinder housing to the lock body using the supplied set screw.

<sup>1</sup> *Key-retaining (captive) function = key removable in the locked position only*