

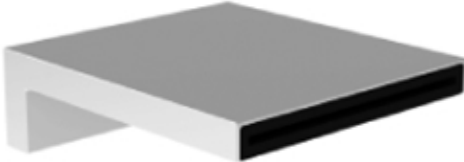

Bathtub - Deque

Cascade tub spout for wall-mounted installation - black matte

Article number: 13 430 740-33



- 7-7/8" Projection
- Cascade
- Plate 7-1/8" x 2-3/8"
- 1-5/8" hole diameter
- 1/2" connection
- Plug-in connection mounting
- Water flow rate limited to max. 7 gpm
- Fittings group in compliance with DIN 4109: 2
- In combination with an eValve, the flow rate can deviate.
- Please note that for an electronic version the flow limiter must be removed.

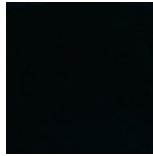

black matte

Accessory is required for this item.

Dimensional drawing

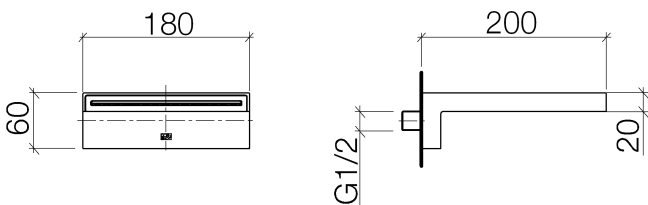



Bathtub - Deque
Cascade tub spout for wall-mounted installation - black matte
Article number: 13 430 740-33

All dimensions in mm / inch = mm x 0,0394

Flow rate chart

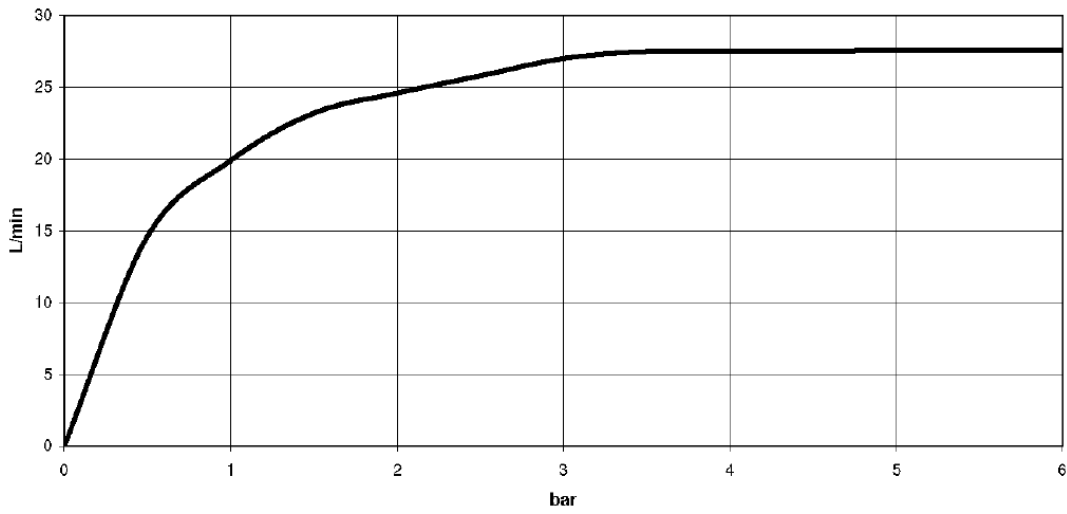



Bathtub - Deque

Cascade tub spout for wall-mounted installation - black matte

Article number: 13 430 740-33

Object surface finish diagram

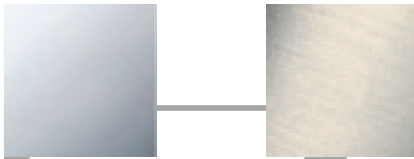

polished chrome

platinum matte

13 430 740-00

13 430 740-06



Required article



35 080 970-90 0010

Rough-in adapter -



Bathtub - Deque

Cascade tub spout for wall-mounted installation - black matte

Article number: 13 430 740-33

Spare parts list

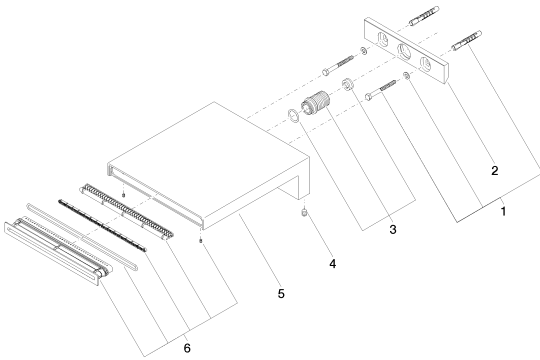

Number	Item Number	Designation	Number of units
1	04 30 31 014 00 90	Mounting bracket -	1
2	09 17 97 056 90	Holder -	1
3	90 24 05 008 00 90	Nipple -	1
4	09 31 11 144 90	Mounting bracket -	2
5	09 11 74 042-33	spout	1
6	90 29 03 059 00 90	Application -	1