



Bathtub - MEM

Tub spout for wall-mounted installation - polished chrome

Article number: 13 801 782-00



- 8-5/8" Projection
- Rectangular aerated stream
- Flange 2-3/8" x 2-3/8"
- 1-1/2" hole diameter
- 1/2" connection
- Water flow rate limited to max. 10.2 gpm
- In combination with an eValve, the flow rate can deviate.
- Please note that for an electronic version the flow limiter must be removed.



polished chrome

Accessory is required for this item.

Dimensional drawing

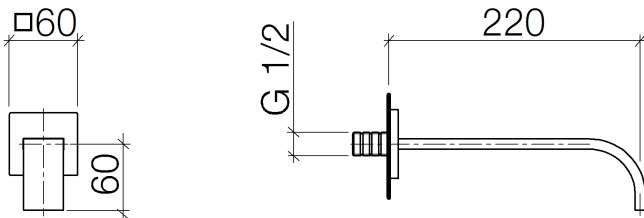

All dimensions in mm / inch = mm x 0,0394

Model/program/technical modifications and error excepted
For more information see: www.dornbracht.com + 49 (0) 2371 433-460 mail@dornbrachtgroup.de



Bathtub - MEM
Tub spout for wall-mounted installation - polished chrome
Article number: 13 801 782-00

Flow rate chart

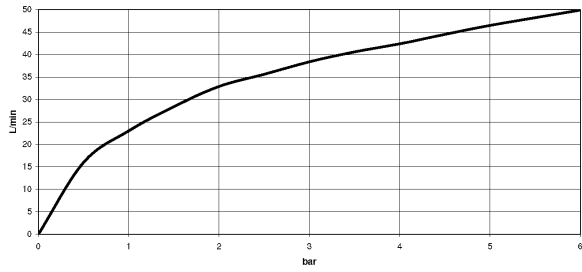



Bathtub - MEM

Tub spout for wall-mounted installation - polished chrome

Article number: 13 801 782-00

Other surface finishes



platinum matte
13 801 782-06



platinum
13 801 782-08



Dark Brass matte
13 801 782-16

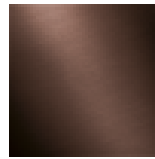

Dark Bronze matte
13 801 782-17



Cyprum
13 801 782-49

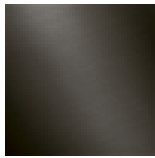

Dark Platinum matte
13 801 782-99

More custom finish options are available via special production (xTra Service). Please see our finish matrix for availability and pricing or contact a Dornbracht representative.

Required article



35 080 970-90 0010
Rough-in adapter -



Bathtub - MEM

Tub spout for wall-mounted installation - polished chrome

Article number: 13 801 782-00

Spare parts list

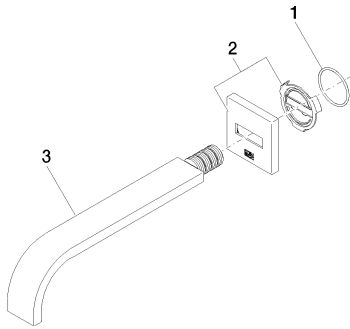

Number	Item Number	Designation	Number of units
1	09 14 10 111 90	Washer -	1
2	90 27 78 035 00-00	Cover - polished chrome	1
3	04 28 22 290 00-00	Outlet - polished chrome	1