



Bathtub - VAIA

Tube spout for wall-mounted installation - polished chrome

Article number: 13 801 809-00



- 7-7/8" Projection
- Round aerator
- 1-1/2" hole diameter
- Flange diameter 2-3/8"
- 1/2" connection
- Water flow rate limited to max. 5.7 gpm
- Fittings group in compliance with DIN 4109: 1



polished chrome

Accessory is required for this item.

Dimensional drawing

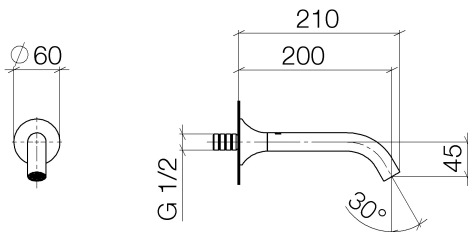

All dimensions in mm / inch = mm x 0,0394



Bathtub - VAIA
Tub spout for wall-mounted installation - polished chrome
Article number: 13 801 809-00

Flow rate chart





Bathtub - VAIA

Tub spout for wall-mounted installation - polished chrome

Article number: 13 801 809-00

Other surface finishes



platinum matte
13 801 809-06

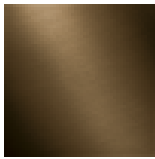

Dark Brass matte
13 801 809-16

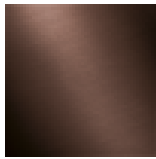

Dark Bronze matte
13 801 809-17

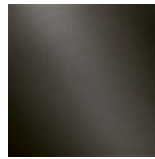

Dark Platinum matte
13 801 809-99

More custom finish options are available via special production (xTra Service). Please see our finish matrix for availability and pricing or contact a Dornbracht representative.

Required article



35 080 970-90 0010
Rough-in adapter -



Bathtub - VAIA

Tube spout for wall-mounted installation - polished chrome

Article number: 13 801 809-00

Spare parts list

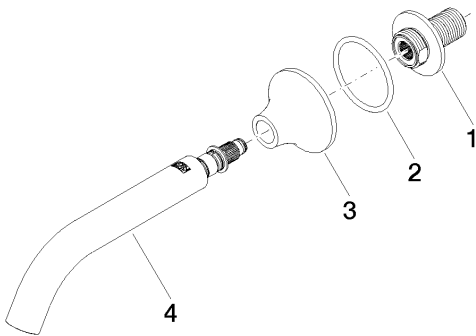

Number	Item Number	Designation	Number of units
1	09 24 03 269 90	Nipple -	1
2	09 14 10 084 90	Washer -	1
3	09 27 80 014-00	Escutcheon - polished chrome	1
4	90 28 22 315 00-00	Outlet - polished chrome	1